

DYWIDAG HOT ROLLED THREADBAR ANCHOR BOLT:
CONFORMING TO ASTM A722 (CAN/CSA G279-M1982)

UNITS	NOMINAL BAR DIAMETER (mm)	STEEL GRADE (fy/ft) MPa	STEEL AREA (mm ²)	MAX. BAR DIAMETER ACROSS RIBS (mm)	MIN. HOLE DIAMETER IN BASE PLATE (mm)	WEIGHT (kg/m)	DIRECTION OF THREAD LEFT OR RIGHT
METRIC	26	830/1035	548	30.5	33	4.48	RIGHT
	32		806	36.7	39	6.53	RIGHT
	36		1019	41.4	44	8.27	RIGHT

UNITS	NOMINAL BAR DIAMETER (in)	STEEL GRADE (fy/ft) ksi	STEEL AREA (in ²)	MAX. BAR DIAMETER ACROSS RIBS (in)	MIN. HOLE DIAMETER IN BASE PLATE (in)	WEIGHT (lb/ft)	DIRECTION OF THREAD LEFT OR RIGHT
IMPERIAL	1	120/150	0.85	1.201	1.299	3.01	RIGHT
	1 1/4		1.25	1.457	1.535	4.39	RIGHT
	1 1/2		1.58	1.630	1.732	5.56	RIGHT

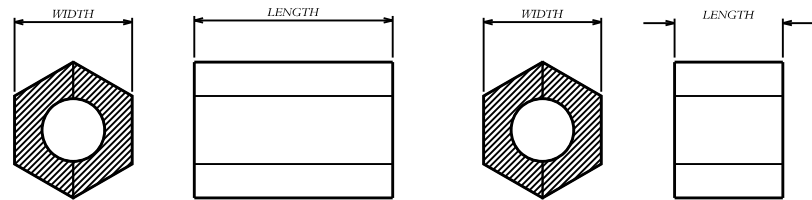

DYWIDAG HEX NUT

DYWIDAG LOCK NUT

NOMINAL BAR DIAMETER mm(in)	STEEL GRADE (fy/ft) MPa	HEX NUT SIZE		LOCK NUT SIZE		MINIMUM TORQUE	
		LENGTH (mm)	WIDTH (mm)	LENGTH (mm)	WIDTH (mm)	ft.lbs	N.m
26 (1")	830/1035	67	45	32	45	270	365
32 (1 1/2")		73	57	45	57	400	550
36 (1 3/8")		98	60	45	60	750	1020

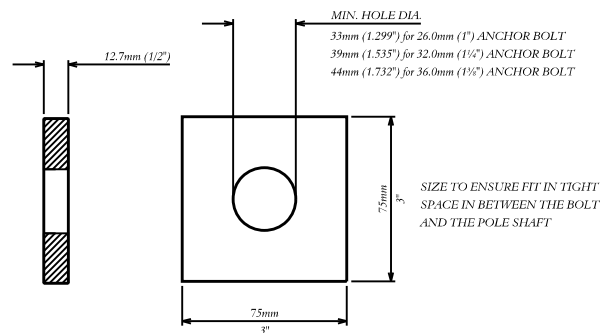

WASHER (G40.21.300W-GALVANIZED)

Emonton TRANSPORTATION SERVICES
TRAFFIC OPERATIONS BRANCH

TRAFFIC SIGNALS

DYWIDAG BOLT AND NUT INSTALLATION
28'/35'/50'/60' CANTILEVER STRUCTURE
B.C.D. 14"/15.5"/20"