

Betty Stanhope-Cole Park

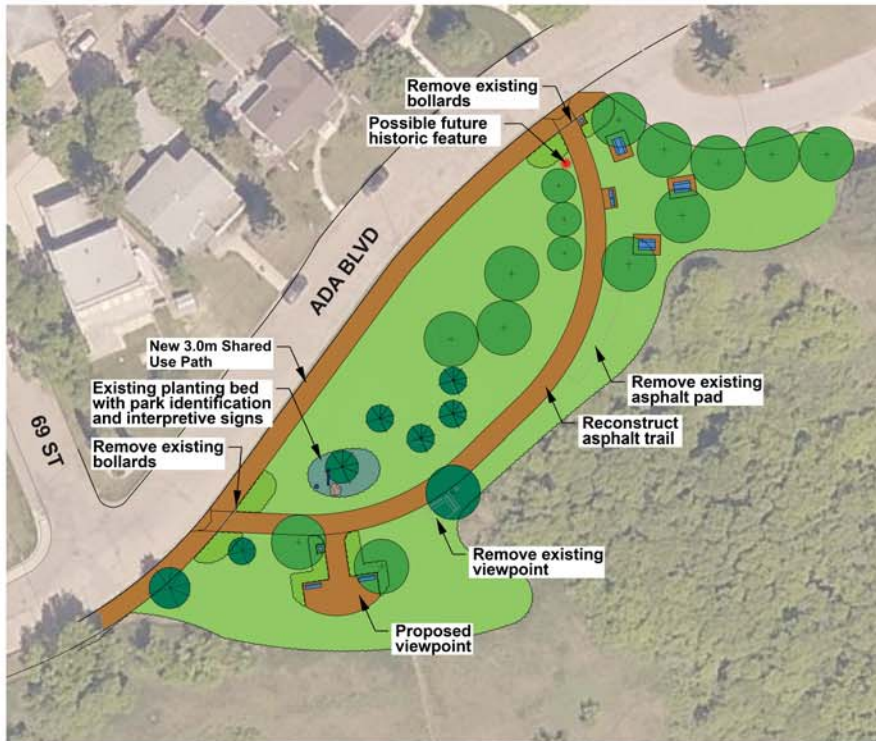

- Existing bollards to be removed
- Existing bench to be removed
- Proposed bench
- Proposed picnic table
- Proposed waste receptacle
- Existing park identification sign
- Existing interpretive sign
- Proposed paving
- Existing trees
- Proposed deciduous tree
- Existing shrub bed
- Proposed shrub bed

*Concept Design - subject to consultation, funding and approval

Please use a sticky note to tell us anything else that we should consider.

What We Heard	Other Considerations	What Is Being Proposed
<ul style="list-style-type: none"> • Current seating area is small and obscure/ lack of sightlines. • Maximize the view of the river valley and golf course. • Make the park more functional. • Most comfortable with benches and park furniture. • Interest in interpretive signage to demonstrate local history and heritage of the area (i.e. plaques). 	<ul style="list-style-type: none"> • Outdoor spaces along Ada Boulevard to support existing culture of friendliness, socializing and gathering. • Maintain the natural beauty of the river valley. 	<ul style="list-style-type: none"> • Removing existing bollards, asphalt pad and viewpoint. • Reconstructing the existing asphalt trail. • Adding a 3.0m shared use path along Ada Boulevard. • Adding a viewpoint, picnic tables, benches and waste receptacles. • Adding shrub planting and deciduous tree planting.

SHARE YOUR VOICE
SHAPE OUR CITY

