

Welcome!



TRANSFORMING | EDMONTON
BRINGING OUR CITY VISION TO LIFE

Valley Line LRT Update on 102 Avenue Future Streetscape

BACKGROUND:

- The City has established a design guide for 102 Avenue when the Valley Line LRT is built.
- This guide was developed with the help of public input received during the preliminary design process.
- It recognizes that 102 Avenue is a significant, multi-use corridor and seeks to create a welcoming environment for all users including pedestrians and cyclists.
- The P3 contractor responsible for completing the design and construction of the Valley Line LRT will be required to follow this guide, which has been incorporated into the Project Agreement between the contractor and the City.
- Images are preliminary, and the final results may not be exactly as shown.



Current view of 102 Avenue (looking eastbound from 100A Street).



The Valley Line—102 Avenue streetscape will reflect design principles from the Capital City Downtown Plan, Quarters Public Realm Plan and Quarters Urban Design Plan.



Key Design Objectives

- **Invest in a high quality civic / public realm**
 - Applying higher quality materials, lighting, planting and furnishings
- **Prioritize pedestrians**
 - Paving materials establish a civic presence across the right of way
- **Minimize clutter**
 - By grouping elements within the pedestrian amenity zone



102 Avenue will become more visually unified. Wider sidewalks and paving stones will emphasize pedestrian priority, and lighting, plantings and other features will be organized for a more inviting environment.



Key Design Objectives (continued)

- **Create visual interest**

- Establishing a rhythm and cadence of hard surfaces and plantings, interrupted by distinctive planter elements that draw the eye, and integrate seating, lighting, and other amenities

- **Mitigate physical constraints**

- All elements need to work together

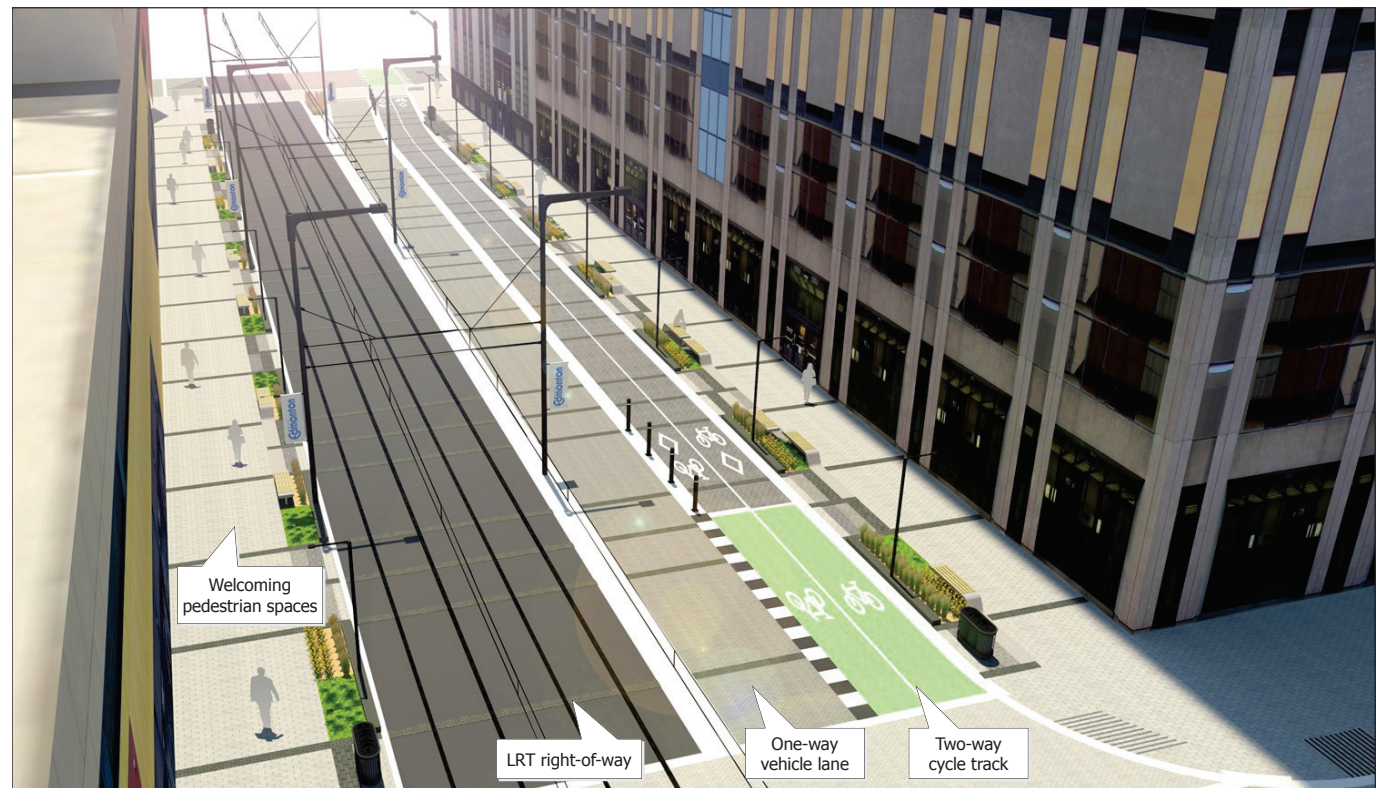

Distinctive planter features will draw the eye, while seating, lighting, and other amenities will be integrated. A 30 km/h speed limit for vehicles will make the area more pedestrian-friendly.



Learn more about the Valley Line and tell us what you think

- Visit us at www.edmonton.ca/valleyline
- Email us at LRTprojects@edmonton.ca
- Contact the LRT Projects Information Centre by phone at [780-496-4874](tel:780-496-4874)