

# Streets and connections overview

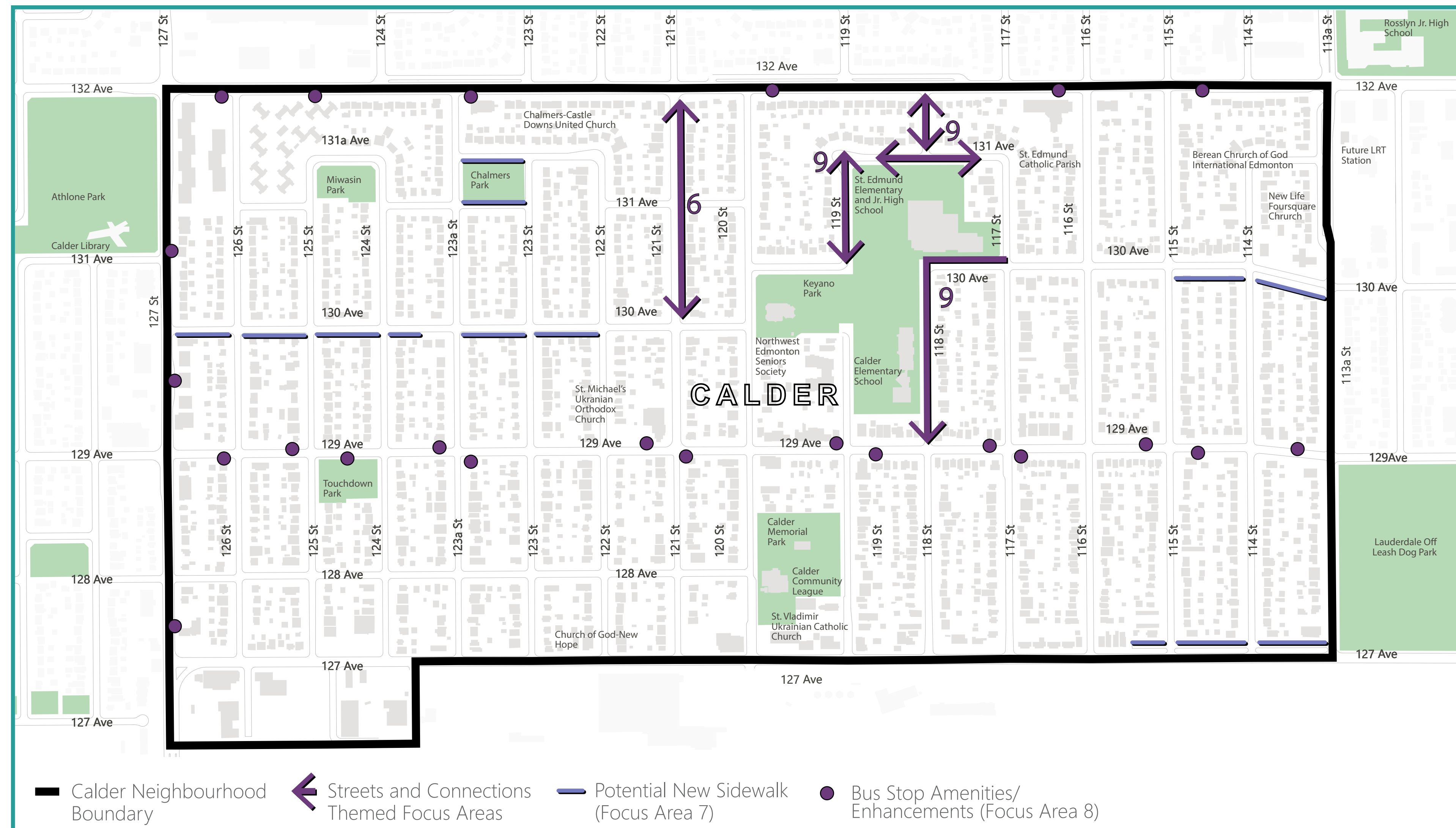

## Streets and Connections

6. 121 Street opportunity for new boulevards (between 132 Ave and 130 Ave)
7. Potential new sidewalks
8. Bus stop amenities/enhancements
9. School area improvements

## What We Heard

- + Access and connectivity: Enhancing connectivity to important destinations (i.e., green spaces, commercial areas and schools) would be welcome.
- + Greenery: Maintaining existing trees and landscaping is important to community members.
- + Lighting: Lighting along streets and sidewalks is important for the safety of people who walk when it is dark.
- + Traffic flow around schools: Traffic around St. Edmund School and Calder School during peak times causes frustration for many community members.



SHARE YOUR VOICE  
SHAPE OUR CITY

Edmonton

# 6 121 Street opportunity for new boulevards

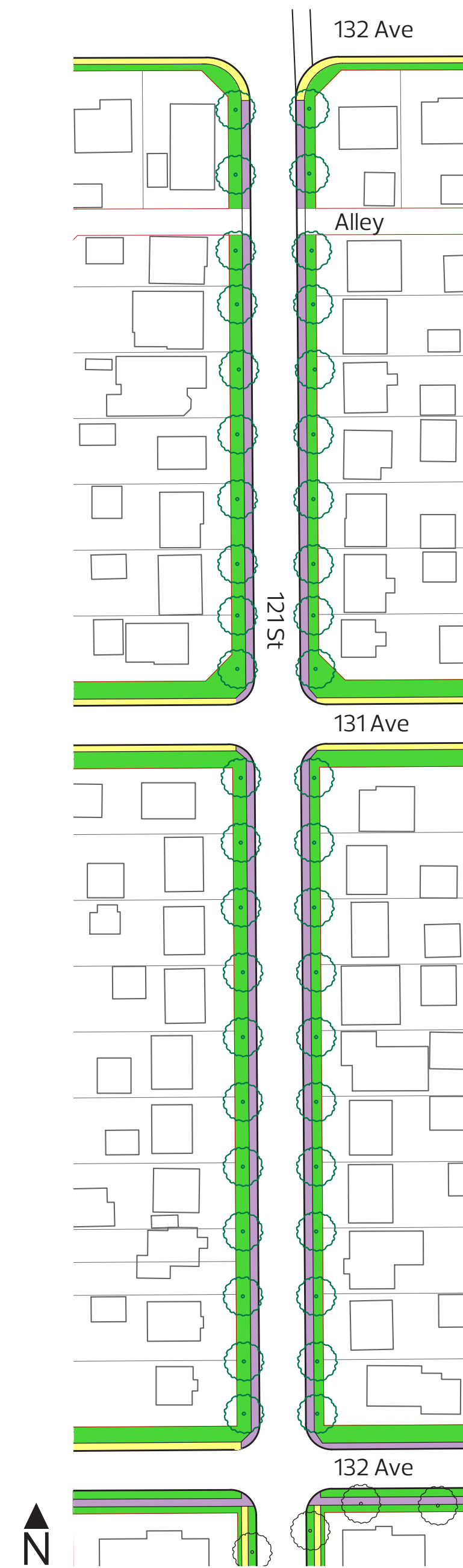
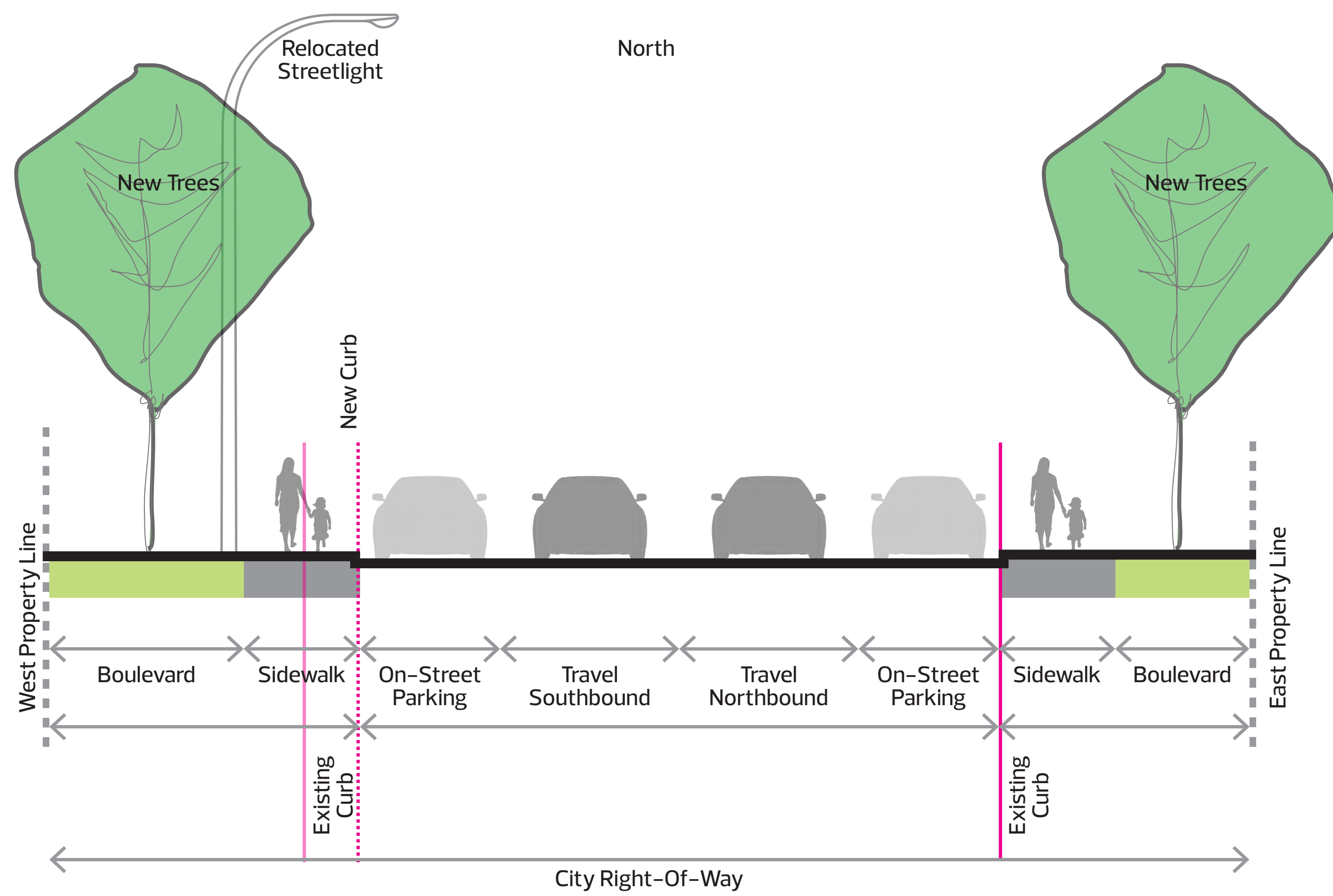

(between 132 Ave and 130 Ave)

## Proposed



- Widen existing sidewalks
- Existing sidewalk
- New trees behind the sidewalk

## What we propose

-  + Widen existing sidewalks to enhance accessibility and comfort for people of all ages and abilities.
-  + Plant new trees behind the sidewalks.
-  + Maintain existing on-street parking and two-way traffic.

**ADVISE**





**SHARE YOUR VOICE**  
**SHAPE OUR CITY**

# 7 Potential new sidewalks



## What we propose

-  + All existing sidewalks within the project limits will be reconstructed if property owners decide to proceed with the Local Improvement tax levy.
-  + New sidewalk connections will be added where possible.
-  + New trees will be considered along sidewalks and roadways where there are none currently planted.



**SHARE YOUR VOICE  
SHAPE OUR CITY**



# 7 Potential new sidewalks

## 130 Avenue (127 Street – 124 Street)



## 130 Avenue (124 Street – 122 Street)

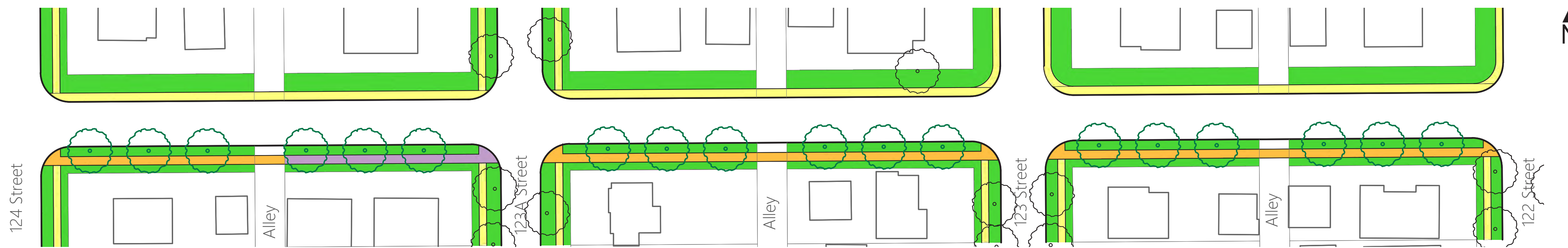

## 130 Avenue (122 Street – 120 Street)

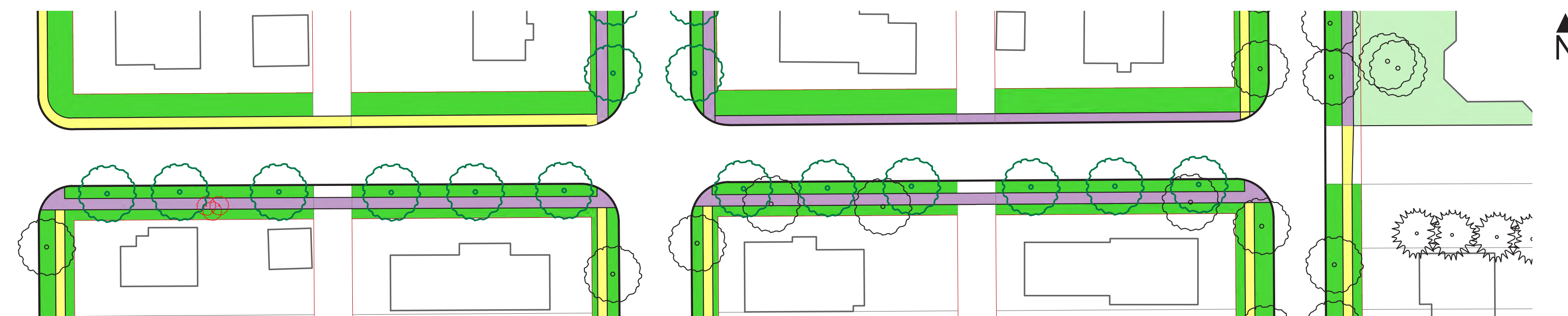

- New sidewalk
- Widen existing sidewalk
- Existing sidewalk
- Existing tree
- Remove tree/shrub
- New tree

**SHARE YOUR VOICE  
SHAPE OUR CITY**



# 7 Potential new sidewalks

## 130 Avenue (117 Street – 113a Street)

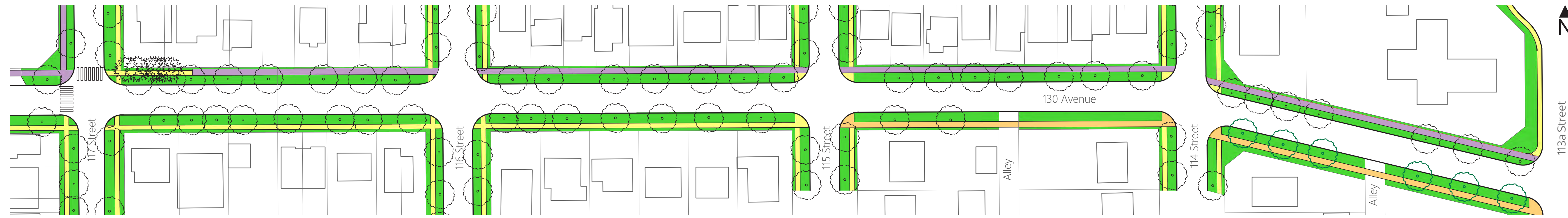

\*Note: Preliminary design solutions will need to address multiple conflict points between the widened sidewalk and trees/walkway steps on adjacent properties.

■ \*Widen existing sidewalk   ■ New sidewalk   ■ Existing sidewalk   ● Existing tree   ● New tree

ADVISE

SHARE YOUR VOICE  
SHAPE OUR CITY

Edmonton

# 7 Potential new sidewalks

## 131A Avenue and 131 Avenue (123A Street – 123 Street)

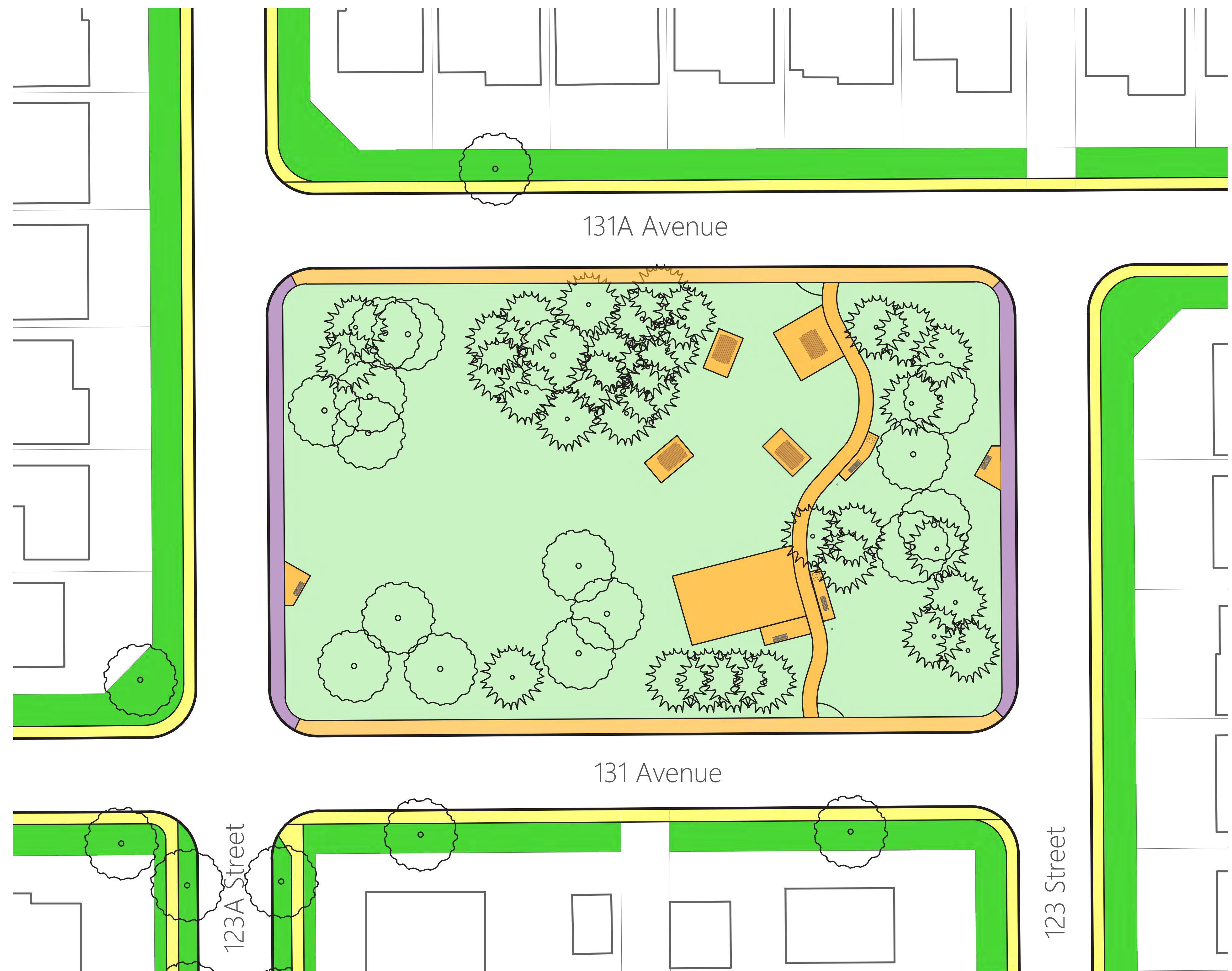

- Widen existing sidewalk
- New sidewalk/pathway
- Existing sidewalk



SHARE YOUR VOICE  
SHAPE OUR CITY



# 7 Potential new sidewalks

## 127 Avenue Service Road (115 Street – 113A Street)

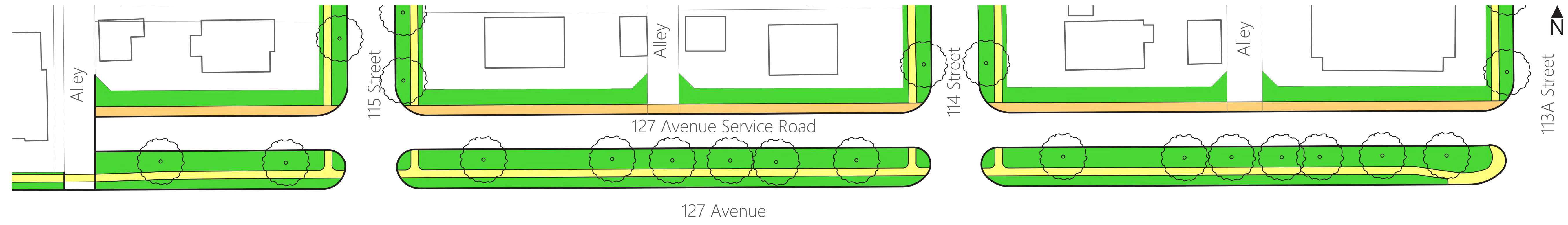

Orange square: New sidewalk  
Yellow square: Existing sidewalk



SHARE YOUR VOICE  
SHAPE OUR CITY

