



# Baturyn

## Urban Design Analysis

### **Chapter 2: Develop Vision, Identify Opportunities and Generate Ideas**





# Table of Contents

<b>1</b>	<b>Neighbourhood Vision and Opportunities</b>	<b>1</b>	<b>List of Maps</b>	
1.1	Community Vision and Guiding Principles	2	Map 1. Neighbourhood opportunities	6
1.2	Opportunities and constraints analysis	4		
1.3	Neighbourhood opportunities map	5		





# 1 Neighbourhood Vision and Opportunities



## 1.1 Community Vision and Guiding Principles

The following community Vision and Guiding Principles were developed through the public engagement process. The Vision provides a short description that sets the direction for the community's future livability. Guiding Principles provide ideas that inform how the Vision is applied to neighbourhood design.

Public input on existing issues and future opportunities for Baturyn was received during the **Building a Project Vision Together and Exploring Opportunities** stage. This feedback informed the development of the draft community Vision and Guiding Principles. Through the next stage, the draft community Vision and Guiding Principles were shared with the public.

### Community Vision



Baturyn is a generationally and culturally diverse community that offers a safe, friendly and walkable experience for families and visitors. There are lots of opportunities to experience green spaces and recreational activities.

We take pride in our connections within our neighbourhood and with the nearby communities and we value friendly gatherings with our neighbours.

We enjoy experiencing the serene and peaceful surroundings that Baturyn has to offer. Baturyn is continuously looking to grow the connections between its diverse residents and neighbours.





## Guiding Principles



Baturyn has an abundance of amenities such as benches, bike racks and a playground to create spaces that are attractive and comfortable.



Baturyn has good connections and wide pathways which provide safe and accessible mobility for people of all ages and abilities.



Baturyn has safe, well-lit spaces and streets for all residents and visitors.



Baturyn is a great place to walk and bike.



Baturyn has many family and kid-friendly spaces and amenities for people of all ages and abilities to enjoy.



Baturyn has spaces to meet and connect with neighbours in all seasons.

Harry Farmer Park





## 1.2 Opportunities and constraints analysis

The following opportunities and constraints were identified through a combination of public engagement and analysis by the Project Team during the **Building a Project Vision Together and Exploring Opportunities** stage. Themes have been used to organize the various opportunities and constraints.

Walking and rolling	Traffic calming*	Biking
<p><b>Opportunities</b></p> <ul style="list-style-type: none"> <li>+ <b>Sidewalks:</b> Replace existing sidewalks and add new sidewalks to address missing links</li> <li>+ <b>Breezeways and pathways:</b> Replace and enhance existing breezeways and pathways and explore new connections to improve connectivity for people who walk, roll or bike</li> <li>+ <b>Safety:</b> Provide additional lighting and enhance existing lighting along pathways to improve visibility for people walking, rolling or biking when it is dark</li> <li>+ <b>Wayfinding:</b> Explore adding wayfinding signs at intersections of pathways to key destinations in and around Castle Downs</li> <li>+ <b>Pedestrian-friendly alleys:</b> Explore alley designs that increase the safety for both people walking and people driving</li> <li>+ <b>School drop-off upgrades:</b> Enhance the functionality of the school drop-off area by exploring concrete drop-off pads and wider sidewalks</li> <li>+ <b>Crosswalk types:</b> Explore enhancing and upgrading existing crosswalks</li> </ul> <p><b>Constraints</b></p> <ul style="list-style-type: none"> <li>+ Existing conditions such as utilities, mature trees and right-of-way width and availability may limit the feasibility of new or enhanced sidewalks, breezeways or pathways</li> <li>+ The maintenance and upkeep of wayfinding signs may be a concern</li> <li>+ Roadway classifications and speed limits have implications on appropriate crosswalk types</li> </ul>	<p><b>Opportunities</b></p> <ul style="list-style-type: none"> <li>+ <b>Curb extensions and raised medians:</b> Reduce roadway widths to: <ul style="list-style-type: none"> <li>+ Encourage slower vehicle speeds</li> <li>+ Improve sightlines for people walking, rolling and driving</li> <li>+ Shorten the crossing distance for people walking and rolling</li> </ul> </li> <li>+ <b>Raised crosswalks:</b> <ul style="list-style-type: none"> <li>+ Reduce vehicle speeds through the placement of raised crosswalks</li> <li>+ Draw greater attention to the crossing for people who walk</li> </ul> </li> </ul> <p><b>Constraints</b></p> <ul style="list-style-type: none"> <li>+ Existing conditions such as utilities and roadway width may limit the feasibility of certain designs</li> <li>+ The need for traffic calming measures may change once Edmonton's default speed limit is reduced from 50 km/h to 40 km/h in the summer of 2021</li> </ul>	<p><b>Opportunities</b></p> <ul style="list-style-type: none"> <li>+ <b>Bike routes:</b> Explore shared, protected and separated bike routes to create opportunities for people who bike</li> <li>+ <b>Bike connections:</b> Create bike routes that connect to destinations within and outside Baturyn</li> </ul> <p><b>Constraints</b></p> <ul style="list-style-type: none"> <li>+ Existing conditions such as utilities, mature trees and right-of-way width and availability may limit the feasibility of certain bike routes</li> <li>+ The curvy road network of Baturyn creates challenges for making direct bike connections</li> </ul>

\*Traffic calming refers to physical roadway design measures used to slow traffic and enhance safety



## Driving

### Opportunities

- + **Roadways and alleys:** Replace the aging surfaces of roadways and alleys
- + **Excess roadway:** Redesign roadway space to reduce the amount of pavement and use the excess for other purposes such as green space or bike infrastructure

### Constraints

- + Existing conditions such as utilities, mature trees and right-of-way width and availability may limit the feasibility of certain roadway opportunities

## Parks

### Opportunities

- + **Park upgrades:** Upgrades to aging parks such as replacing the Baturyn Park basketball court
- + **New amenities:** Provide new amenities including bike racks, picnic tables, waste bins and benches
- + **Enhance safety:** Enhance user safety through additional lighting and maintaining trees to keep sightlines open
- + **New recreational activities:** Create outdoor recreational activities for all ages and abilities, at all times of the year
- + **Pathways:** Address missing pathway connections and widen existing pathways
- + **Community-led projects:** Explore community-led projects such as a potential community garden, fruit bearing plants and a picnic shelter

### Constraints

- + Improvements to Baturyn Park may be limited to land owned by the City
- + Existing sports fields and mature trees may impact the feasibility of new or widened pathways
- + Park enhancements should be sensitive of impacts to nearby residential properties

## Placemaking\*

### Opportunities

- + **Public spaces:** Create community gathering spaces for residents to meet and connect
- + **Seating areas:** Provide seating areas with benches, landscaping, lighting and waste bins
- + **Kid-friendly sidewalk games:** Explore kid-friendly sidewalk games such as hopscotch and tic-tac-toe
- + **Corner Store Program:** Enhance the public realm near the 109 Street corner store area to create gathering spaces
- + **Community-led projects:** Explore community-led projects including fence murals, replacing the Castle Downs sign and wrapping utility boxes in public art

### Constraints

- + The long-term maintenance responsibility of community-led projects may be a concern to residents
- + Community capacity and willingness to dedicate volunteer time and resources to community-led projects

## 1.3 Neighbourhood opportunities map

Opportunities identified for Baturyn are illustrated on Map 1 as focus areas that address observations from public engagement input and the Project Team.

Neighbourhood design options will be developed during the **Exploring Options and Tradeoffs** stage based on the focus areas of Map 1. Options will be examined to explore different design benefits and tradeoffs.

\*Placemaking means creating spaces that promote people's health, happiness and well-being in their community.



# Map 1. Neighbourhood opportunities

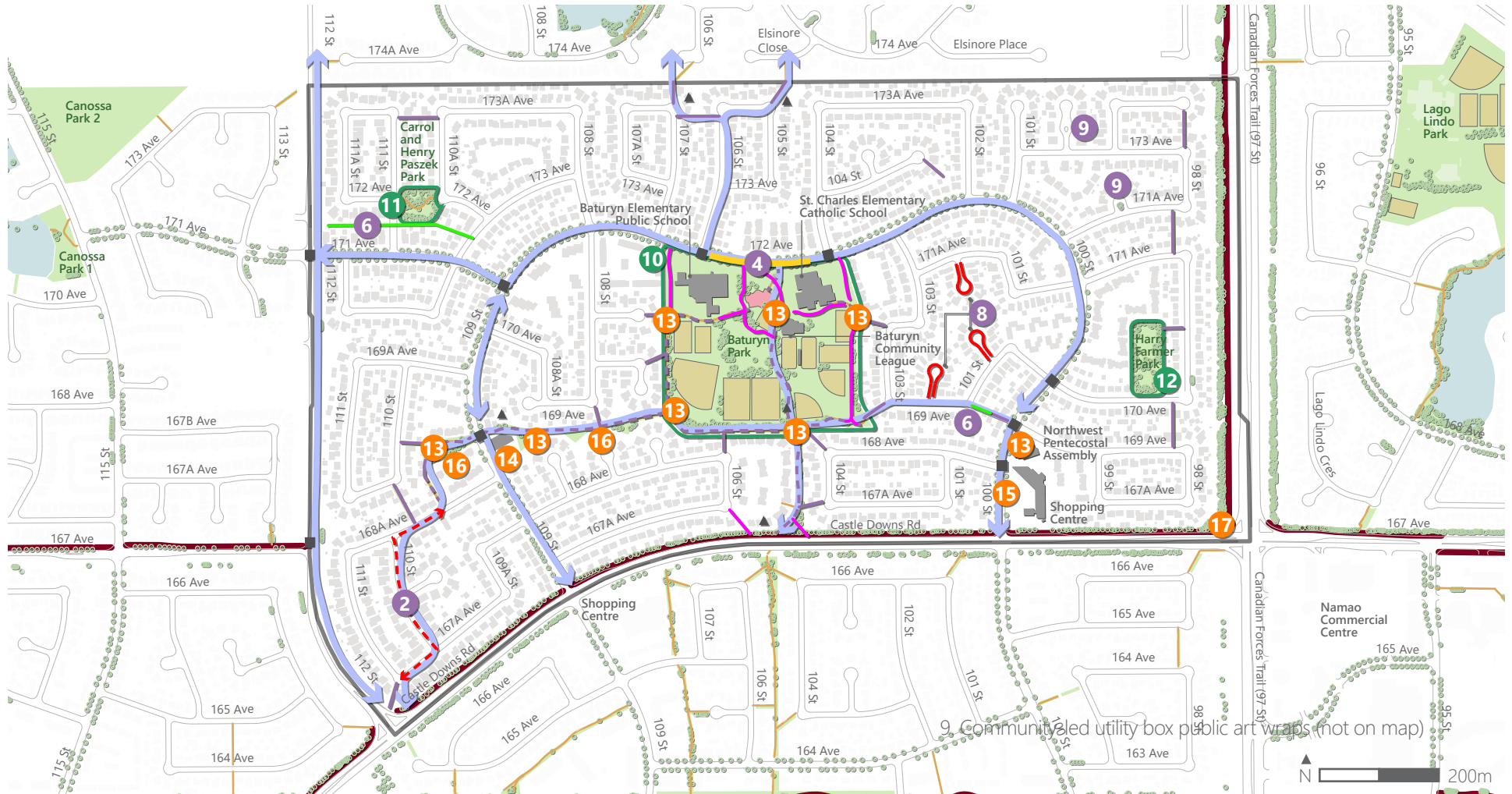

- Baturyn Neighbourhood boundary
- Park/open space
- Existing breezeways
- Existing shared-use paths
- Sports field/court/rink
- Playground

## Walking, rolling, traffic calming, biking and driving

- 1. Breezeway and pathway upgrades (# not on map)
  - Replace and enhance breezeways
  - Widen existing pathways
  - New pathways
- 2. Enhanced sidewalks
- 3. Crosswalk upgrades (# not on map)
- 4. School drop-off upgrades
- 5. Wayfinding signage (# not on map)
- 6. Pedestrian-friendly alleys

- 7. Bike routes
- 8. New sidewalks
- 9. Redesign of roadway landscape features (173 and 171A Avenues)

## Parks

- 10. Baturyn Park
- 11. Carrol and Henry Paszek Park
- 12. Harry Farmer Park

## Placemaking

- 13. Seating areas
- 14. Future Corner Store Program site
- 15. Public realm improvements
- 16. Community-led fence murals
- 17. Community-led Castle Downs sign
- 18. Community-led utility box public art wraps (not on map)



