

Welcome to Alley Renewal in your neighbourhood

BEFORE



AFTER



Alley Renewal

- + Alley Renewal is a city-funded capital program that renews alley infrastructure on a neighbourhood-wide basis
- + Locations are chosen based on alley condition and alignment with planned utility work
- + 1,200 kilometres of alleys will be renewed in Edmonton over 25 years
- + The program is funded by a city-wide Neighbourhood Renewal Tax Levy, rather than a contribution from property owners with back alleys

Alley Renewal: What's included

- + Removing the existing alley pavement structure then reconstructing with a new base and hard surface to meet current design standards
- + Improving surface drainage, where possible
- + Upgrading existing alley lighting to LED fixtures
- + Providing wider alley entry/exit points for larger vehicles (garbage trucks), where possible
- + Pruning alley trees and shrubs ahead of construction
- + Exploring minor enhancements to improve connections for those who walk, bike or roll, where possible



Alley Renewal: What's NOT included

- + **Utility work** – While utility work is separate from the Alley Renewal program, the City works closely with utility partners to coordinate construction activities
- + **New alley lighting** – If alleys are without lighting, property owners can petition and fund new lighting in their alleys through the Local Improvement process
- + **Private property enhancements** – Any additional work on private properties such as paving personal driveways or pathways
 - + Infrastructure impacts to private property will be repaired/replaced on a like-for-like basis

Preparing for construction

- + Utility inspections and repairs
 - + Utility partners ensure required repairs are completed prior to alley construction, when possible
 - + May include drilling small holes to check for utility locations
- + Land surveys
 - + May include flags and paint markings
- + Pruning and removing trees, hedges and shrubs by professional arborists (tree specialists)
 - + Provides clearance for construction and automated waste collection
 - + Avoids future conflicts with overhead utility lines
 - + Property owners will be consulted if pruning is extensive or if a private tree requires removal. There is no cost to property owners



What to expect during construction

- + No alley access or parking for approximately four weeks
 - + Please let us know about any accessibility concerns
- + Waste collection will be temporarily moved to your front street



Alley Renewal Construction

Crawford Plains, Daly Grove & Pollard Meadows Alley Renewal

Alley Renewal construction will begin in 2023 and take a minimum of two years to complete.

Sign up for project updates:
[edmonton.ca/**CrawfordPlainsDalyGrove
PollardMeadows**](https://edmonton.ca/CrawfordPlainsDalyGrovePollardMeadows)

Contact: dalpreet.virdi@edmonton.ca







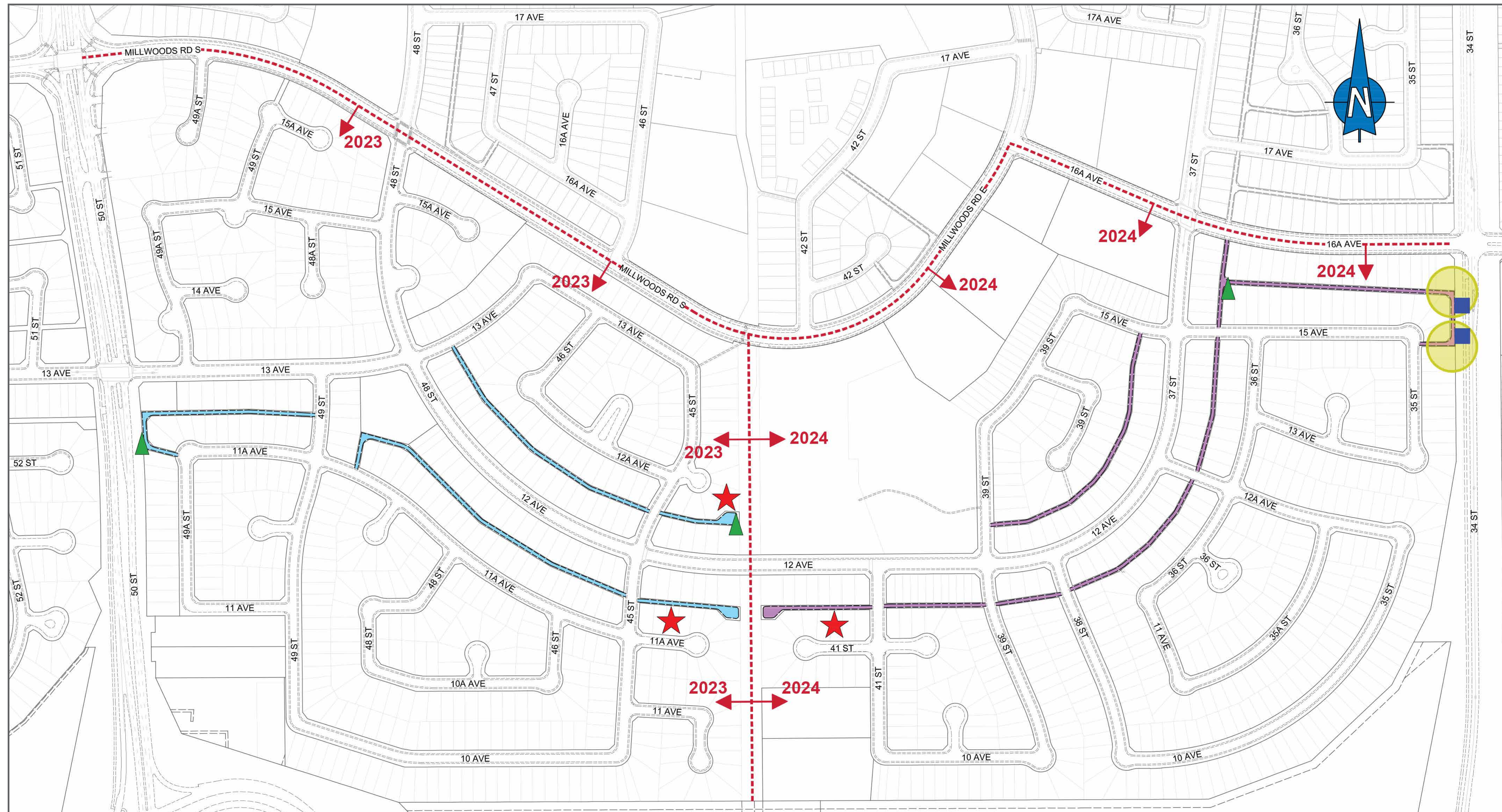

Alley Renewal Construction

Crawford Plains Alley Renewal



LEGEND

- | | | | | | |
|-------------------------------------------------------------------------------------|---------------------------|-------------------------------------------------------------------------------------|---------------------------------------|---------------------------------------------------------------------------------------|------------------------------|
|  | ALLEY CONSTRUCTION - 2023 |  | GRAVEL ALLEY UPGRADE TO PAVED SURFACE |  | PROPOSED PROTECTIVE POSTS |
|  | ALLEY CONSTRUCTION - 2024 |  | POSSIBLE TREE IMPACT (CITY PROPERTY) |  | TURNING MOVEMENT IMPROVEMENT |

Alley Renewal Construction

Pollard Meadows Alley Renewal

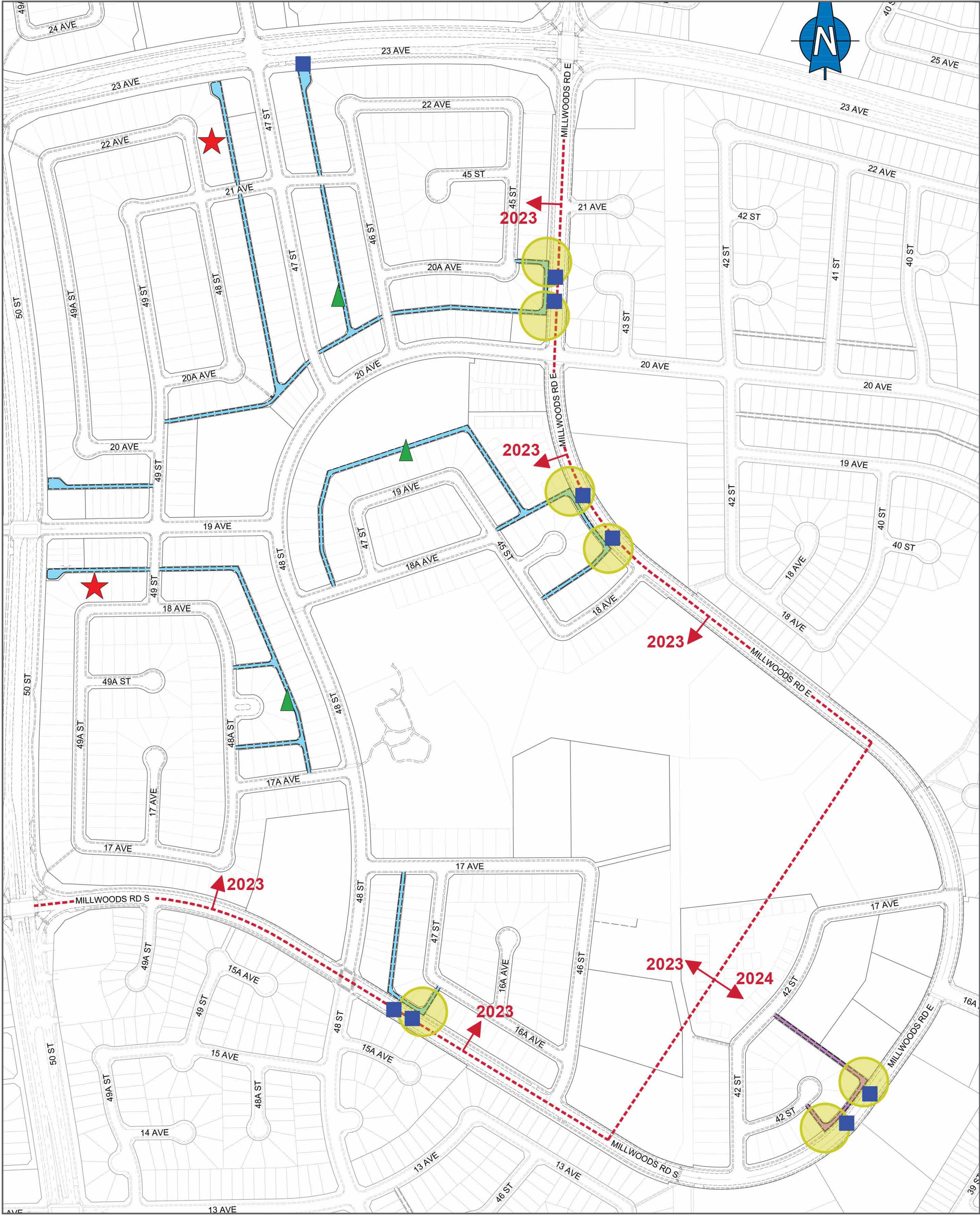

LEGEND

- ALLEY CONSTRUCTION - 2023
- ALLEY CONSTRUCTION - 2024
- GRAVEL ALLEY UPGRADE TO PAVED SURFACE
- POSSIBLE TREE IMPACT (CITY PROPERTY)
- PROPOSED PROTECTIVE POSTS
- TURNING MOVEMENT IMPROVEMENT



Alley Renewal Construction

Daly Grove Alley Renewal

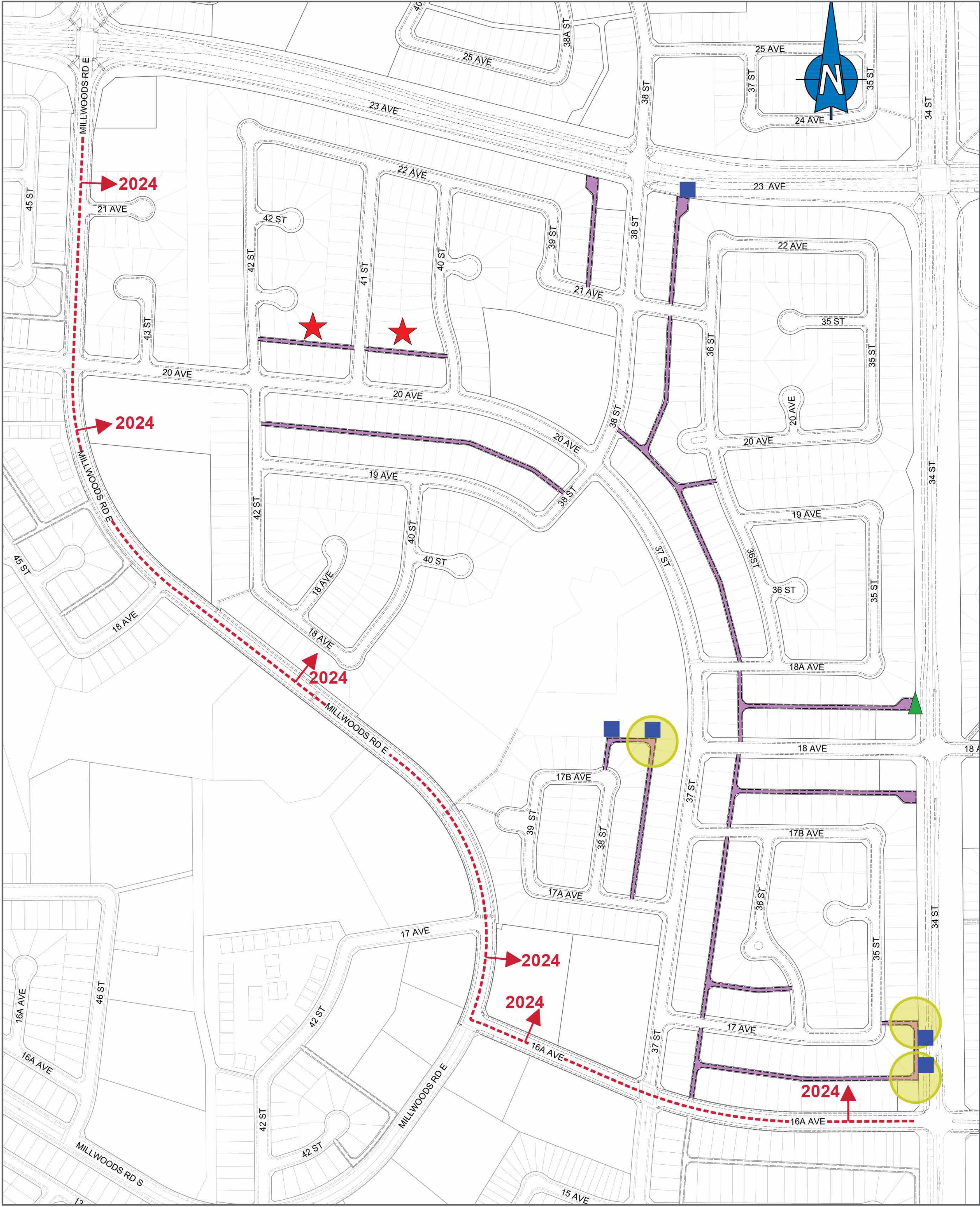

LEGEND

- ALLEY CONSTRUCTION - 2023
- ALLEY CONSTRUCTION - 2024
- GRAVEL ALLEY UPGRADE TO PAVED SURFACE
- POSSIBLE TREE IMPACT (CITY PROPERTY)
- PROPOSED PROTECTIVE POSTS
- TURNING MOVEMENT IMPROVEMENT

