

# Alley Renewal

Crawford Plains

Daly Grove

Pollard Meadows

The Edmonton logo is located in the bottom right corner of the slide. It consists of the word "Edmonton" in white, sans-serif font, centered within a dark blue square. The background of the slide is a vibrant green with various geometric shapes and icons representing urban infrastructure, such as buildings, a truck, a bicycle, and a person walking. A vertical white line is positioned to the left of the text.

Edmonton

# Alley Renewal Program

- Alley Renewal is a city funded capital program that renews alley infrastructure on a neighbourhood-wide basis
- Neighbourhoods are prioritized based on average alley condition and timing of planned utility work
- 1,200 kilometres of alleys will be renewed in Edmonton over the next 25 years
- The program is funded by a city-wide Neighbourhood Renewal Tax Levy, not just a contribution from property owners with back alleys

# Alley Renewal includes:

- Removing all alley road infrastructure (to the dirt) then reconstructing alley roads with a new base and hard surface
- Improving surface drainage where possible
- Minor widening to improve turning movements where space allows
- Pruning alley trees and shrubs
- Minor enhancements to improve connections for those who walk, bike or roll, where possible
- Protective posts where needed to clearly identify where alleys end

# Alley Renewal does NOT include:

- **Utility work** - While utility work is separate from the Alley Renewal Program, the City works closely with utility partners to coordinate construction activities
- **New alley lighting** - If alleys are without lighting, property owners can petition and fund new lighting to be added to their alleys through the Local Improvement process.
- **Private property enhancements** - Any infrastructure impacts to private property will be repaired/replaced like-for-like, the City will not include any additional work on private properties such as paving personal driveways or pathways

# Changes in Crawford Plains

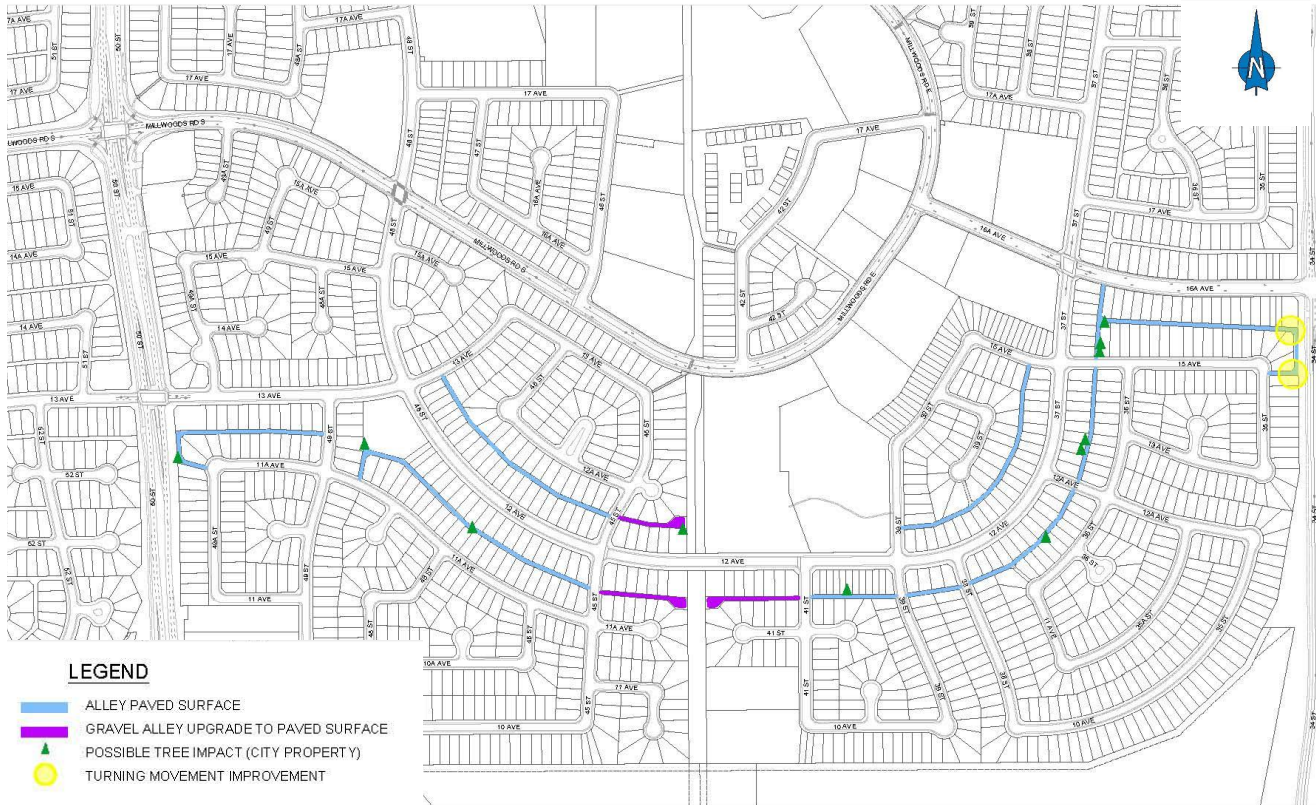

# Changes in Daly Grove



## LEGEND

- ALLEY PAVED SURFACE
- GRAVEL ALLEY UPGRADE TO PAVED SURFACE
- POSSIBLE TREE IMPACT (CITY PROPERTY)
- TURNING MOVEMENT IMPROVEMENT



# Changes in Pollard Meadows

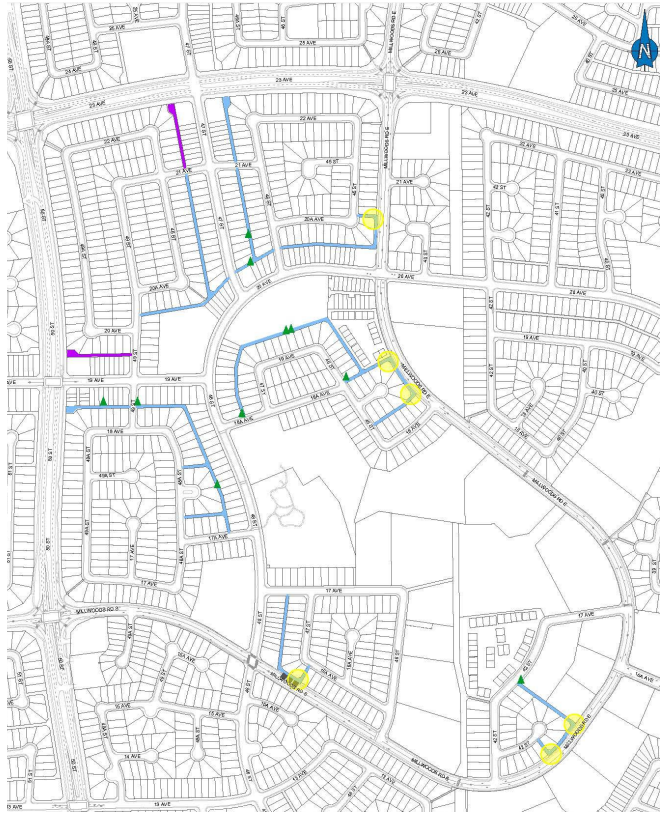

## LEGEND

- ALLEY PAVED SURFACE
- GRAVEL ALLEY UPGRADE TO PAVED SURFACE
- POSSIBLE TREE IMPACT (CITY PROPERTY)
- TURNING MOVEMENT IMPROVEMENT
- PROPOSED PROTECTIVE POSTS

# Changes in your neighbourhood

- Reconstructed and paved alleys throughout the neighbourhood
- Turning movement improvements were made where possible and include minor widening of the driving surface in specified areas
- Trees located on road right-of-way (City property) have been identified as having possible impacts. A City of Edmonton Urban Forester will be conducting further assessments prior to construction
- Proposed wooden posts have been recommended in some locations in Pollard Meadows to better identify the alley driving space



# Before and After



# Alley Lighting

- Alley Renewal covers the cost of upgrading existing alley lighting to LED bulbs
- **Adding alley lighting** is NOT included in Alley Renewal
- Property owners wishing to add lighting to their alley can do so through the Local Improvement Program:
  - Adding alley lighting would be 100% funded by all alley property owners
  - For more information visit:
    - Web: [edmonton.ca/alleylighting](http://edmonton.ca/alleylighting) or
    - Email: [localimprovement@edmonton.ca](mailto:localimprovement@edmonton.ca)

# Alley Lighting

## If your alley currently has poles but no lighting:

- Property owners can add lighting to the poles through the **Local Improvement Program**
- Power will need to be added in with a separate meter box
- This cost of the lights and power boxes would be shared by all property owners on the alley and may be paid in a lump sum or over the period of five years



\*Payment for maintenance and energy consumption will be required every year and appear on property owners' tax assessments

## If your alley currently has no poles or lighting:

- Property owners can add poles and lights through the **Local Improvement Program**
- Power will need to be added in with a separate meter box
- The cost of the poles, lights and power boxes would be shared by all property owners on the alley and may be paid in a lump sum or over the period of five years



# Preparing for Construction

As the City prepares for construction in your alley, you may see:

- **Utility partners**
  - Conducting inspections
  - Drilling small holes to check for utility locations
  - Working on repairs
- **Design Team**
  - Adding flags and paint markings for land surveys



# Preparing for Construction

As the City prepares for construction in your alley, you may see:

- **Professional Arborists (tree specialists)**
  - Pruning and removing trees, hedges and shrubs to:
    - Provide clearance for
      - Construction
      - Automated waste collection
    - Avoid future conflicts with overhead utility lines
  - Property owners will be consulted if pruning is extensive or if a private tree requires removal. There is no cost to property owners.

# During Construction

During construction you can expect:

- Your alley to be inaccessible for approximately 4 weeks
- No access to alley parking, please let us know about any accessibility concerns
- Waste collection to be temporarily moved to your front street



# Timing

- Currently in the planning and design stage 2022-2023
- Construction dates will be confirmed upon completion of design and is anticipated to occur between 2023-2025
- The Project Team will advise your neighbourhood when specific construction dates have been scheduled



# Questions?

If you have any questions or local knowledge you would like to share with the Project Team please contact:

**Trudy Raadik**

trudy.raadik@edmonton.ca

edmonton.ca/**CrawfordPlainsDalyGrovePollardMeadows**

The logo for the City of Edmonton, featuring the word "Edmonton" in white text on a dark blue square background. The logo is positioned in the bottom right corner of the slide, partially overlapping a vertical decorative border on the right side of the page. The border itself is a colorful collage of stylized illustrations including a blue car, a green field, a red and white striped field, and various houses in different colors (red, green, blue, yellow).