

MARQUIS SPECIAL AREA ZONES
 APPENDIX I - MARQUIS TOWN CENTRE
 GENERAL CONCEPT

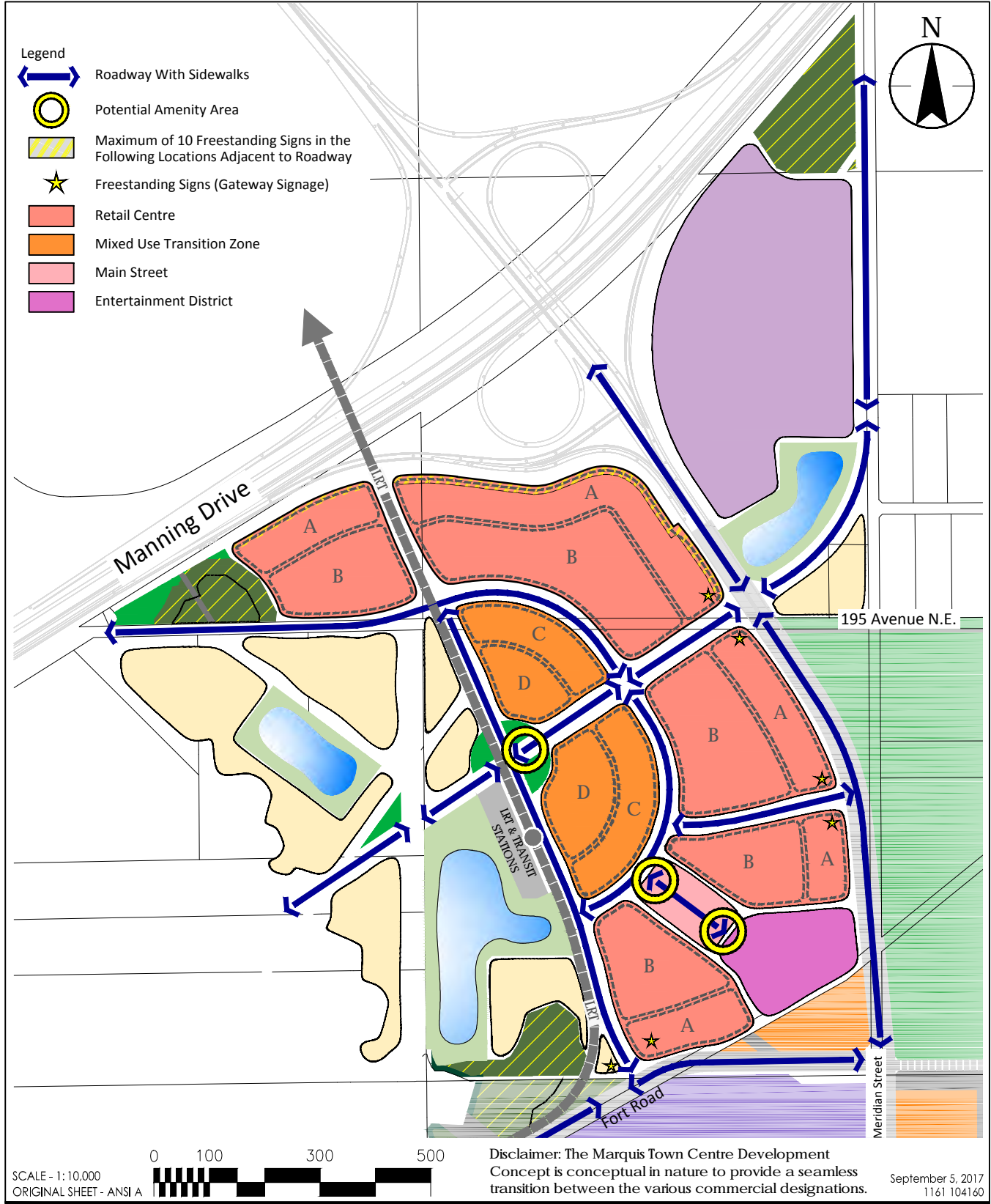

V:\1161\active\1161104160\drawing\model_files\planning\rezoning_model_files\marquis_appendix_1_05sep2017.dwg



10160-112 Street
 Edmonton, AB T5K 2L6
 www.stantec.com

NOTE: AMENITY AREAS ARE CONCEPTUAL AND WILL BE FINALIZED THROUGH DETAILED SITE DESIGN.

MARQUIS SPECIAL AREA ZONES
 APPENDIX II - MARQUIS TOWN CENTRE
 CONCEPTUAL PEDESTRIAN CONNECTIONS

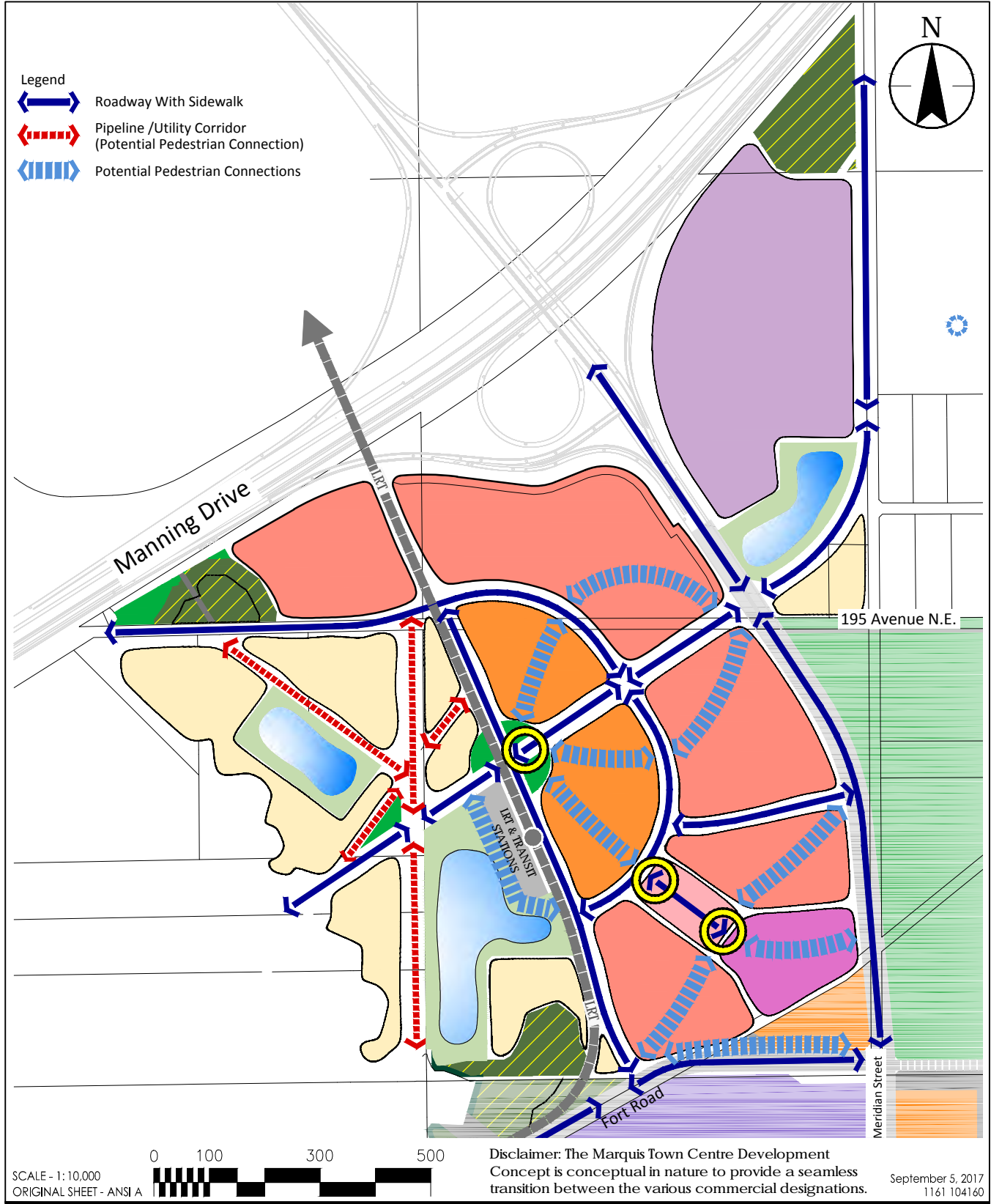

V:\1161\Active\1161104160\drawing\model_files\planning\rezoning_zone_marquis_appendix2_05sep2017.dwg



10160-112 Street
 Edmonton, AB T5K 2L6
 www.stantec.com

NOTE: PEDESTRIAN CONNECTION LOCATIONS ARE CONCEPTUAL AND WILL BE FINALIZED THROUGH DETAILED SITE DESIGN.

MARQUIS SPECIAL AREA ZONES
APPENDIX III - MARQUIS TOWN CENTRE
BUILDING SETBACK FOR SENSITIVE USES

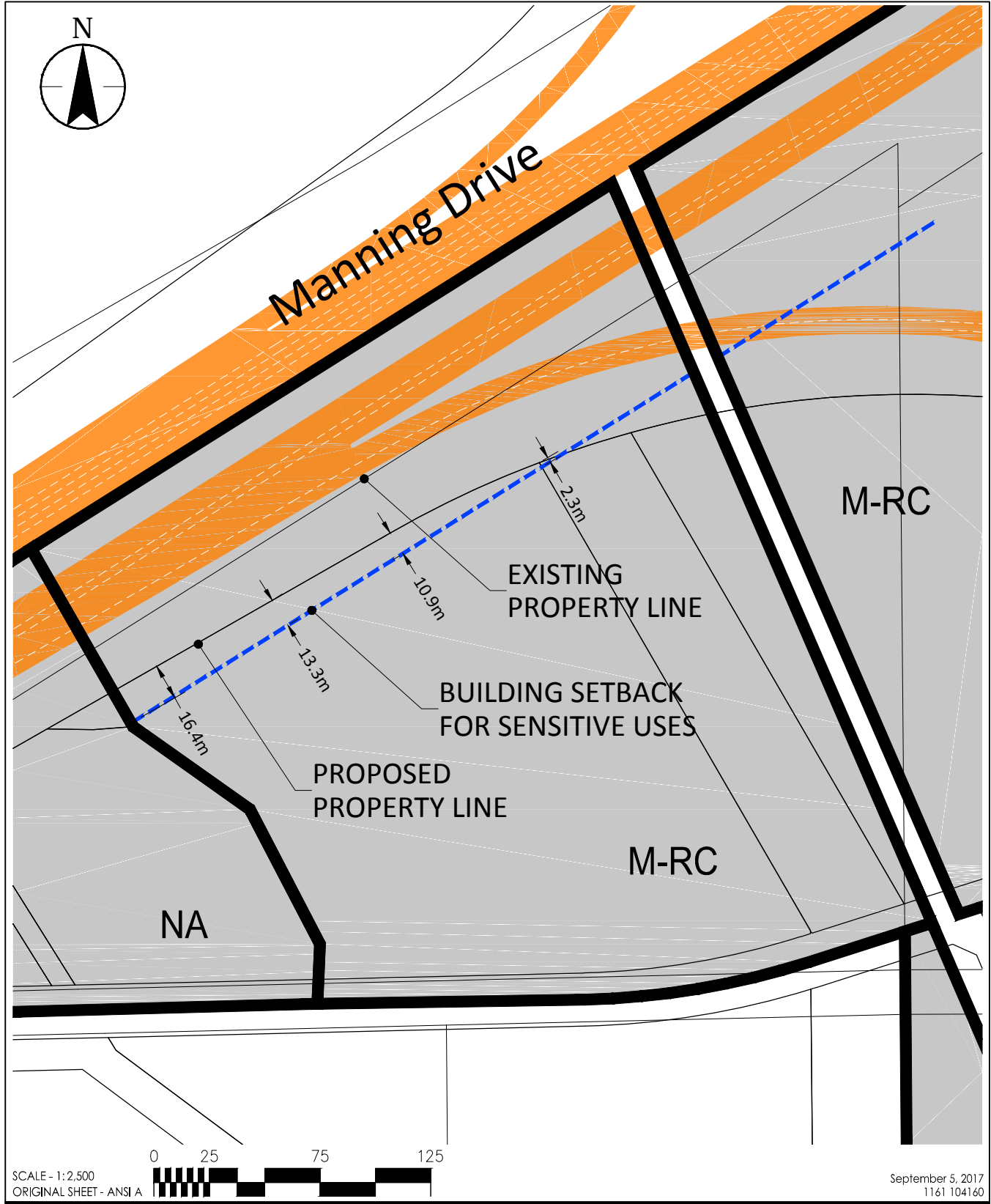

V:\1161\active\1161104160\drawing\model_files\planning\zoning\zone_marquis_appendix3_05sep2017.dwg



10160-112 Street
Edmonton, AB T5K 2L6
www.stantec.com

NOTE: ALL DISTANCES ARE EXPRESSED IN METRES
AND DECIMALS THEREOF.