

TREE PROTECTION ZONE CALCULATION TABLE		
TRUNK DIAMETER (DBH)	TRUNK CIRCUMFERENCE	MIN. PROTECTION DISTANCE
< 10cm	< 31cm	1.2 METERS
11 - 30cm	34 - 94cm	1.8 METERS
31 - 40cm	97 - 125cm	2.4 METERS
41 - 50cm	129 - 157cm	3.0 METERS
51 - 60cm	160 - 189cm	3.6 METERS
61 - 70cm	192 - 220cm	4.2 METERS
71 - 80cm	233 - 251cm	4.8 METERS
> 80cm	> 251cm	5.0 METERS

- MIN PROTECTION DISTANCE IS MEASURED FROM OUTSIDE EDGE OF TREE TRUNK FROM EACH SIDE.
- DBH = DISTANCE AT BREAST HEIGHT

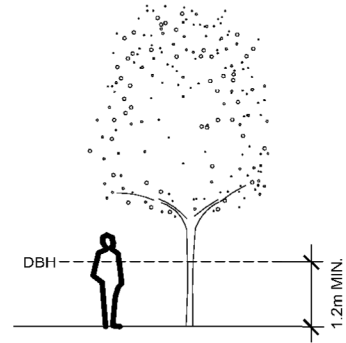

**DBH MEASUREMENT ELEVATION**

- NOT TO SCALE

**TREE PROTECTION NOTES:**

- NO GROUND DISTURBANCE WITHIN 1.2m OF THE TREE TRUNK (I.E. POST INSTALLATION).
- POSTS SET BACK FROM CURB & SIDEWALK 300mm MIN.
- FENCE MATERIAL: MIN. ORANGE BARRIER FENCE OR METAL CHAIN LINK.
- PROVIDE & INSTALL DE-COMPACTION MATERIAL SUCH AS ACCESS MATTING OR RIG MATS TO PROTECT FROM SOIL COMPACTION FOR ANY ACCESS THAT HAS BEEN APPROVED (TYPE OF MATERIAL MUST ALLOW FOR AIR FILTRATION, AND BE IDENTIFIED, ILLUSTRATED & APPROVED IN TREE PROTECTION PLAN).
- PRUNING WILL BE DIRECTED BY CITY URBAN FORESTRY.
- NO EQUIPMENT SHALL OPERATE INSIDE THE PROTECTIVE FENCING INCLUDING DURING FENCE INSTALLATION AND REMOVAL.
- REFER TO TREE PROTECTION GUIDELINES FOR ADDITIONAL TREE PROTECTION REQUIREMENTS.
- ANY EXCEPTIONS TO TREE PROTECTION ZONE ALTERATIONS REQUIRE CONSULTATION AND APPROVAL BY A CITY OF EDMONTON URBAN FORESTER.
- ALL UTILITY LOCATIONS ARE TO BE IDENTIFIED PRIOR TO ANY GROUND DISTURBANCE, AND ADHERE TO SAFE DIG PRACTICES AND SETBACK REQUIREMENTS.
- IDENTIFY ALL PROPOSED TEMPORARY ACCESS ROUTES TO CROSS CITY PROPERTY ON TREE PROTECTION PLAN.

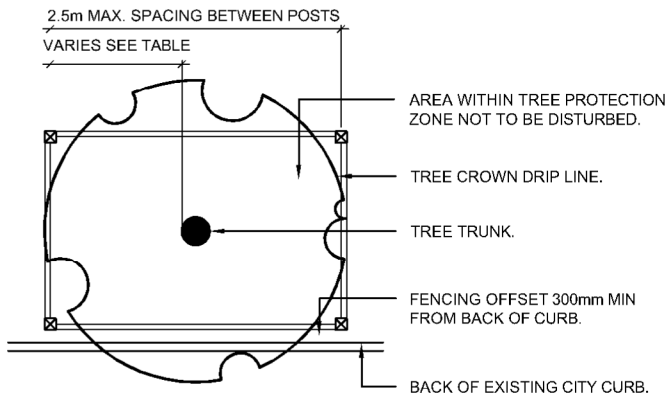

**TREE PROTECTION PLAN VIEW**

- NOT TO SCALE

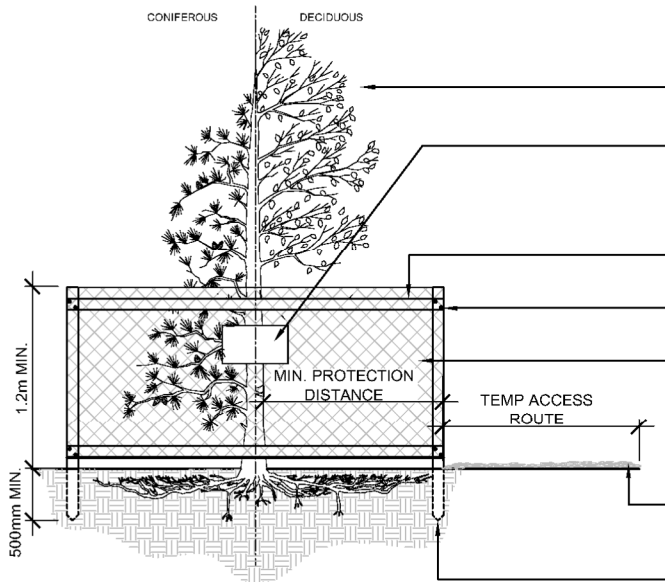

**TREE PROTECTION ELEVATION VIEW**

- NOT TO SCALE

- EXISTING TREE WITHIN TREE PROTECTION ZONE, TO REMAIN AND BE PROTECTED.
- SIGNAGE LAMINATED IN PLASTIC ON TWO LONGEST SIDES OF T.P.Z. FENCING TO READ: "TREE PROTECTION ZONE DO NOT REMOVE FENCE DURING CONSTRUCTION". REFER TO CITY OF EDMONTON TREE AND CONSTRUCTION WEBSITE. [www.edmonton.ca](http://www.edmonton.ca).
- TOP AND BOTTOM RAILS: 2" x 4" MIN.
- WOODEN POST OR APPROVED ALTERNATIVE: 76 x 76 mm MIN. (BRACE AS REQUIRED)
- BARRIER FENCING: HIGH DENSITY ORANGE POLYETHYLENE OR CHAINLINK ALONG PERIMETER.
- 8" (203mm) - 12" (304mm) THICK LAYER OF MULCH OR APPROVED ALTERNATIVE ON TEMPORARY ACCESS ROUTE.
- WOOD OR METAL POST BELOW GRADE. IF METAL IS SPECIFIED, THE WOOD POST MUST BE BOLTED TO THE METAL POST. DO NOT INSTALL ON OR THROUGH A TREE ROOT.



**BOULEVARD TREE PROTECTION ZONE**

Date Approved: JUNE 2017	Drawn By: PARKS PLANNING	Approved:	Revision	Drawing No. LA101
Scale: N.T.S.	Checked By: PARKS PLANNING			Old Drawing No. SP403a

**ALL CITY TREE (S) WITHIN 5 METERS OF THE CONSTRUCTION SITE TO INCLUDE:**

- DIAMETER AT BREAST HEIGHT (DBH). TO BE MEASURED AT 1.2m ABOVE GROUND.
- SPECIES.
- LOCATION AND DIMENSION OF THE TREE PROTECTION ZONE (TPZ).
- A DETAIL OF THE (TPZ) FENCING.
- ALL EXISTING AND PROPOSED INFRASTRUCTURE CHANGES WITHIN THE (TPZ). EG. STRUCTURES, UTILITY SERVICES, HARD SURFACES.
- ACCESS POINTS TO THE CONSTRUCTION SITE TO BE DEFINED ON THE PLAN.
- LOCATION OF PROPERTY LINE.
- ALL UTILITY LOCATIONS ARE TO BE IDENTIFIED PRIOR TO ANY GROUND DISTURBANCE. AND ADHERE TO SAFE DIG PRACTICES AND SETBACK REQUIREMENTS.
- REFER TO CITY OF EDMONTON TREE PROTECTION GUIDELINES AND DETAILS FOR WRITTEN PROPOSAL REQUIREMENTS, AND ADDITIONAL CITY OF EDMONTON TREE PROTECTION INFORMATION.

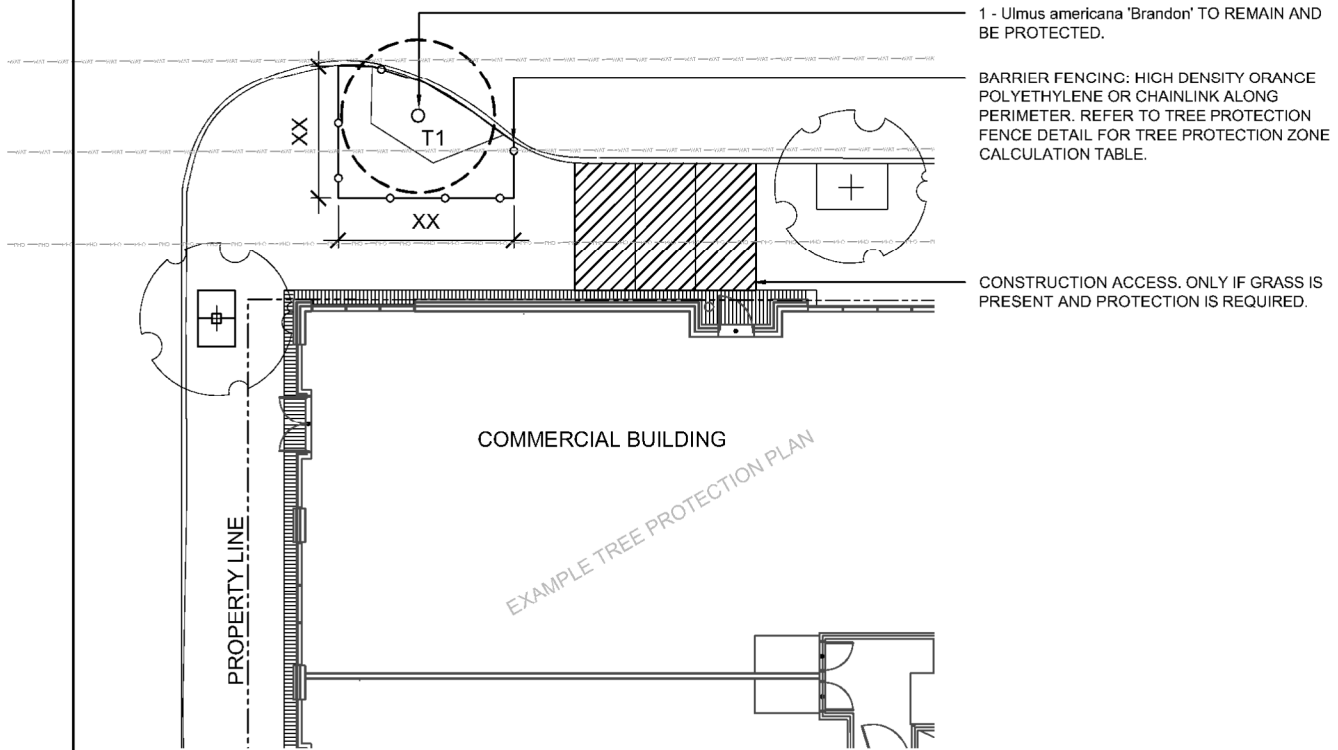

1 - *Ulmus americana* 'Brandon' TO REMAIN AND BE PROTECTED.

BARRIER FENCING: HIGH DENSITY ORANGE POLYETHYLENE OR CHAINLINK ALONG PERIMETER. REFER TO TREE PROTECTION FENCE DETAIL FOR TREE PROTECTION ZONE CALCULATION TABLE.

CONSTRUCTION ACCESS. ONLY IF GRASS IS PRESENT AND PROTECTION IS REQUIRED.

**COMMERCIAL TREE PROTECTION PLAN VIEW**

TREE PROTECTION SCHEDULE				
TREE #	TREE SPECIES (can be found at <a href="#">vegtreeapp</a> )	TREE SIZE MEASURED 1.2m ABOVE GROUND (cm)		FENCING TOTAL PER TREE
-	-	DBH (cm)	CIRCUMFERENCE (cm)	W X L
T1	BRANDON ELM	12cm	37cm	1.8m x 1.2m



**COMMERCIAL TREE PROTECTION PLAN**

Date Approved: JUNE 2017	Drawn By: PARKS PLANNING	Approved:	Revision	Drawing No. LA101
Scale: N.T.S.	Checked By: PARKS PLANNING			Old Drawing No. SP403a

**ALL CITY TREE (S) WITHIN 5 METERS OF THE CONSTRUCTION SITE TO INCLUDE:**

- DIAMETER AT BREAST HEIGHT (DBH). TO BE MEASURED AT 1.2m ABOVE GROUND.
- SPECIES.
- LOCATION AND DIMENSION OF THE TREE PROTECTION ZONE (TPZ).
- A DETAIL OF THE (TPZ) FENCING.
- ALL EXISTING AND PROPOSED INFRASTRUCTURE CHANGES WITHIN THE (TPZ), EG. STRUCTURES, UTILITY SERVICES, HARD SURFACES.
- ACCESS POINTS TO THE CONSTRUCTION SITE TO BE DEFINED ON THE PLAN.
- LOCATION OF PROPERTY LINE.
- ALL UTILITY LOCATIONS ARE TO BE IDENTIFIED PRIOR TO ANY GROUND DISTURBANCE. AND ADHERE TO SAFE DIG PRACTICES AND SETBACK REQUIREMENTS.
- REFER TO CITY OF EDMONTON TREE PROTECTION GUIDELINES AND DETAILS FOR WRITTEN PROPOSAL REQUIREMENTS, AND ADDITIONAL CITY OF EDMONTON TREE PROTECTION INFORMATION.

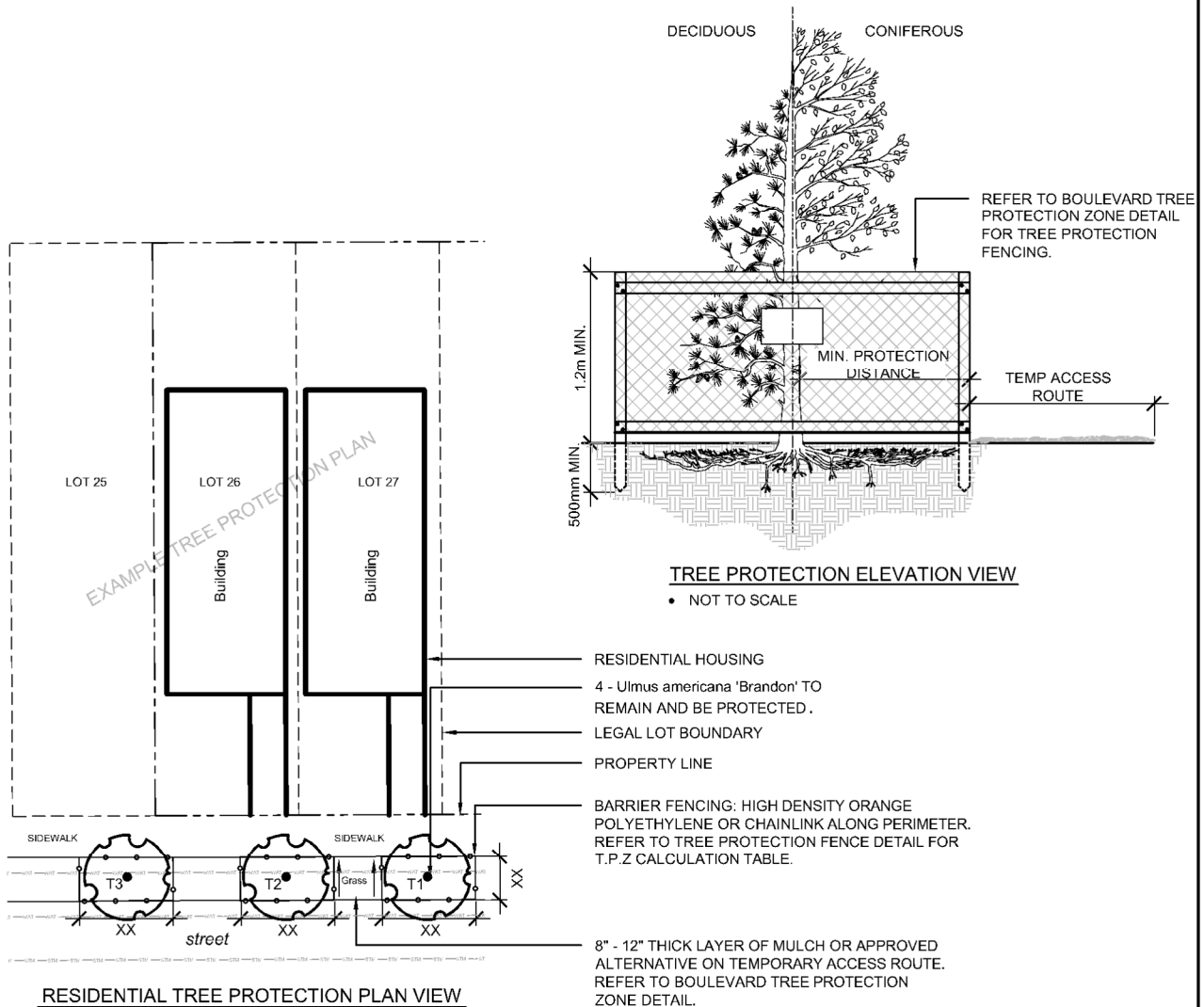

**TREE PROTECTION SCHEDULE**

TREE #	TREE SPECIES (can be found at <a href="#">yestreetmap</a> )	TREE SIZE MEASURED 1.2m ABOVE GROUND (cm)		FENCING TOTAL PER TREE
		DBH (cm)	CIRCUMFERENCE (cm)	
T1	BRANDON ELM	12cm	37cm	2.4m x 1.2m



**RESIDENTIAL TREE PROTECTION PLAN**

Date Approved: JUNE 2017	Drawn By: PARKS PLANNING	Approved:	Revision	Drawing No. LA101
Scale: N.T.S.	Checked By: PARKS PLANNING			Old Drawing No. SP403a