

ALL CITY TREE (S) WITHIN 5 METERS OF THE CONSTRUCTION SITE TO INCLUDE:

- DIAMETER AT BREAST HEIGHT (DBH). TO BE MEASURED AT 1.2m ABOVE GROUND.
- SPECIES.
- LOCATION AND DIMENSION OF THE TREE PROTECTION ZONE (TPZ).
- A DETAIL OF THE (TPZ) FENCING.
- ALL EXISTING AND PROPOSED INFRASTRUCTURE CHANGES WITHIN THE (TPZ). EG. STRUCTURES, UTILITY SERVICES, HARD SURFACES.
- ACCESS POINTS TO THE CONSTRUCTION SITE TO BE DEFINED ON THE PLAN.
- LOCATION OF PROPERTY LINE.
- ALL UTILITY LOCATIONS ARE TO BE IDENTIFIED PRIOR TO ANY GROUND DISTURBANCE. AND ADHERE TO SAFE DIG PRACTICES AND SETBACK REQUIREMENTS.
- REFER TO CITY OF EDMONTON TREE PROTECTION GUIDELINES AND DETAILS FOR WRITTEN PROPOSAL REQUIREMENTS, AND ADDITIONAL CITY OF EDMONTON TREE PROTECTION INFORMATION.

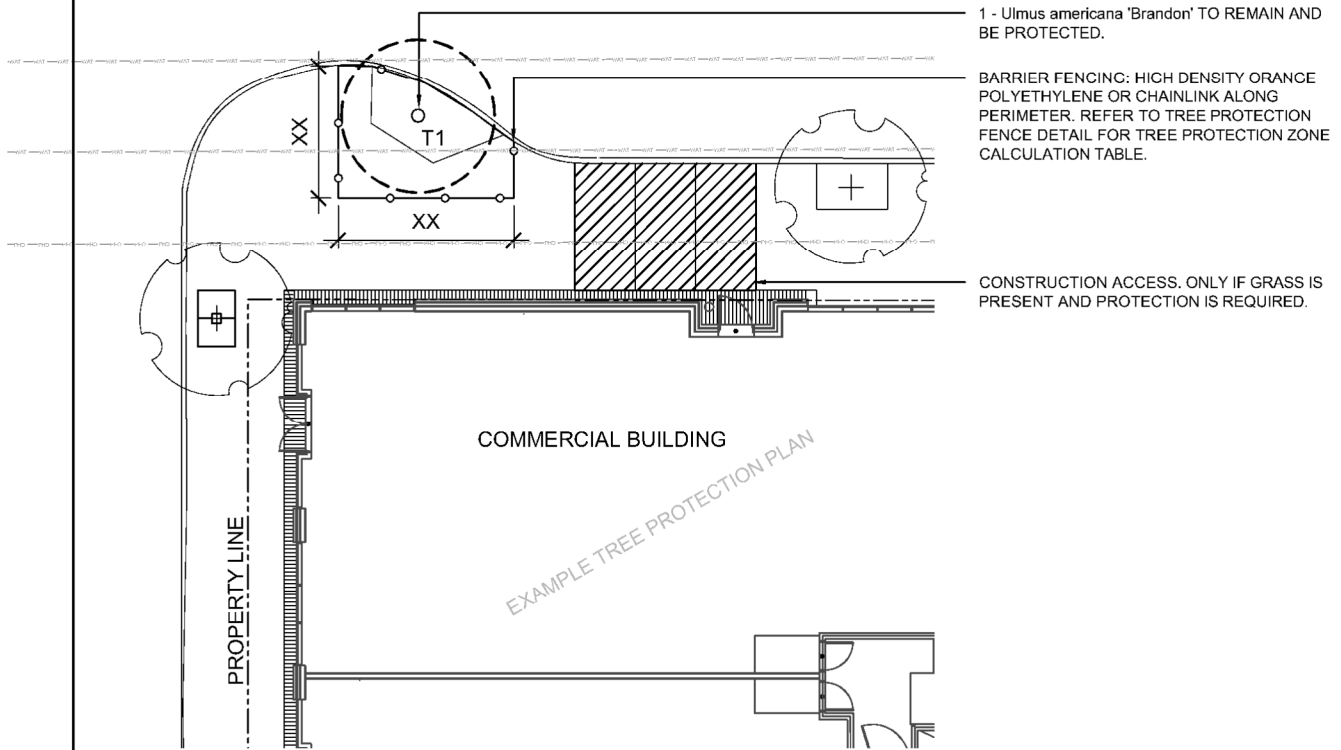

COMMERCIAL TREE PROTECTION PLAN VIEW

TREE PROTECTION SCHEDULE				
TREE #	TREE SPECIES (can be found at vegtreeapp)	TREE SIZE MEASURED 1.2m ABOVE GROUND (cm)		FENCING TOTAL PER TREE
-	-	DBH (cm)	CIRCUMFERENCE (cm)	W X L
T1	BRANDON ELM	12cm	37cm	1.8m x 1.2m



COMMERCIAL TREE PROTECTION PLAN

Date Approved: JUNE 2017	Drawn By: PARKS PLANNING	Approved:	Revision	Drawing No. LA101
Scale: N.T.S.	Checked By: PARKS PLANNING			Old Drawing No. SP403a