



NEIGHBOURHOOD DESCRIPTION

The area that became the Beaumaris neighbourhoods was annexed by the City of Edmonton in 1971 as part of the Castle Downs area. Development of the neighbourhoods in the Castle Downs area began shortly after the land was subdivided and construction continued into the 1980s.

Like adjacent neighbourhoods, Beaumaris was named by the developer of the Castle Downs area, Business and Construction Materials Inc., now known as Genstar. The intent was to name the subdivisions and neighbourhoods after famous castles. Beaumaris is a famous castle in Wales. The castle theme is echoed by the design of the neighbourhood. An illusion of a “keep” (fortress castle) and moat are created by the houses enclosed by Castle Keep road and Beaumaris Lake.

Population by Age and Gender

Age Group	Male	Female	Total	% of Total	City %
0-9	205	195	400	9	12
10-19	240	220	460	10	11
20-29	365	325	690	15	18
30-39	215	225	440	10	15
40-49	235	245	480	11	14
50-59	300	395	695	15	14
60-69	290	330	620	14	8
70+	335	450	785	17	8
Total	2,185	2,385	4,570	100	100

Marital Status (Population 15 years of age and older)

Marital Status	People	% of Total	City %
Married	2,005	50	45
Common-Law	190	5	9
Single (Never Legally Married)	1,105	28	32
Separated	100	3	2
Divorced	225	6	7
Widowed	370	9	5
Total	3,995	100	100

Family Households

Family Type	Households	% of Total	City %
Married Couples	990	-	-
Without Children at Home	505	39	29
With Children at Home	485	38	40
Common-Law Couples	95	-	-
Without Children at Home	70	5	9
With Children at Home	25	2	4
Total Lone-Parent Families	195	-	-
Female Parent	155	12	14
Male Parent	40	3	4
Total	1,280	100	100

Household Size

People Per Household	Households	% of Total	City %
1 Person	605	32	29
2 People	650	34	33
3 People	270	14	16
4 People	225	12	14
5 People	90	5	5
6 or More	75	4	3
Total	1,915	100	100

Source: 2011 Census of Canada, Statistics Canada

Note: totals may not sum due to random rounding

2010 Household Income

Household Income in 2010	Households	% of Total	City %
Under \$10,000	40	2	5
\$10,000 to \$19,999	105	6	6
\$20,000 to \$29,999	180	9	7
\$30,000 to \$39,999	230	12	8
\$40,000 to \$49,999	210	11	8
\$50,000 to \$59,999	170	9	8
\$60,000 to \$79,999	230	12	14
\$80,000 to \$99,999	160	8	12
\$100,000 to \$124,999	175	9	11
\$125,000 to \$149,999	105	6	7
\$150,000 and Over	290	15	14
Total	1,895	100	100
Median Household Income	\$60,589	-	\$72,248
Average Household Income	\$84,539	-	\$90,340

Highest Level of Education (Population 15 years of age and older)

Education Level	People	% of Total	City %
No Certificate, Diploma or Degree	985	24	18
High School Diploma or Equivalent	1,060	26	26
Apprenticeship or Trades Certificate or Diploma	285	7	9
College or Other Non-University Certificate or Diploma	780	19	18
University Certificate or Diploma Below Bachelor Level	230	6	5
University Certificate or Diploma at Bachelor Level or Above	735	18	24
Total	4,075	100	100

Population by Ethnic Origin

Ethnic Origins	People	% of Total	City %
European Origins	1,280	23	15
British Isle Origins	1,175	21	29
Other North American Origins (Includes Canadian)	705	13	15
French Origins	365	7	9
Aboriginal Origins	125	2	5
Latin, Central, and South American Origins	155	3	2
Caribbean Origins	55	1	1
South Asian Origins	205	4	6
West Central Asian and Middle Eastern Origins	750	14	3
East and Southeast Asian Origins	545	10	12
African Origins	115	2	3
Oceania Origins	-	0	0
Total	5,475	100	100

Note: The sum of ethnic groups in this table is greater than the total population count because an individual may report more than one ethnic origin.

Source: 2011 Census of Canada, Statistics Canada

Note: totals may not sum due to random rounding

Population by Mobility Status (Based on address 5 years previous)

Mobility	People	% of Total	City %
Non-movers	3,000	68	53
Moved From Elsewhere in Edmonton	910	20	28
Moved From Elsewhere in Alberta	135	3	5
Moved From Elsewhere in Canada	165	4	7
Moved From Outside Canada	230	5	7
Total	4,440	100	100

Residential Units by Structure Type

Type of Unit	Units	% of Total	City %
Single-Detached House	825	43	51
Semi-Detached House, Duplex	125	7	7
Row House	255	13	10
Apartment Building (5+ Stories)	0	0	8
Apartment Building (< 5 Stories)	710	37	23
Moveable Dwelling	0	0	1
Other	0	0	0
Total	1,915	100	100

Period of Construction

Year of Construction	Units	% of Total	City %
1960 or Before	0	0	18
1961-1980	600	33	35
1981-1990	730	40	15
1991-2000	250	14	11
2001-2005	245	13	11
2006-2011	0	0	10
Total	1,825	100	100

Occupied Private Dwellings by Tenure

Housing by Tenure	Number	% of Total	City %
Owner Occupied	1,410	74	65
Renter Occupied	490	26	35
Total	1,900	100	100

Journey to Work (Employed Labour Force)

Transportation Method	People	% of Total	City %
Car, Truck, Van - as Driver	1,730	80	72
Car, Truck, Van - as Passenger	145	7	6
Public Transit	225	10	15
Walked	55	3	5
Bicycle	0	0	1
Other Methods	0	0	1
Total	2,155	100	100

Source: 2011 Census of Canada, Statistics Canada

Note: totals may not sum due to random rounding

NEIGHBOURHOOD PROFILE 2014 NEIGHBOURHOOD EXISTING LAND USE BEAUMARIS

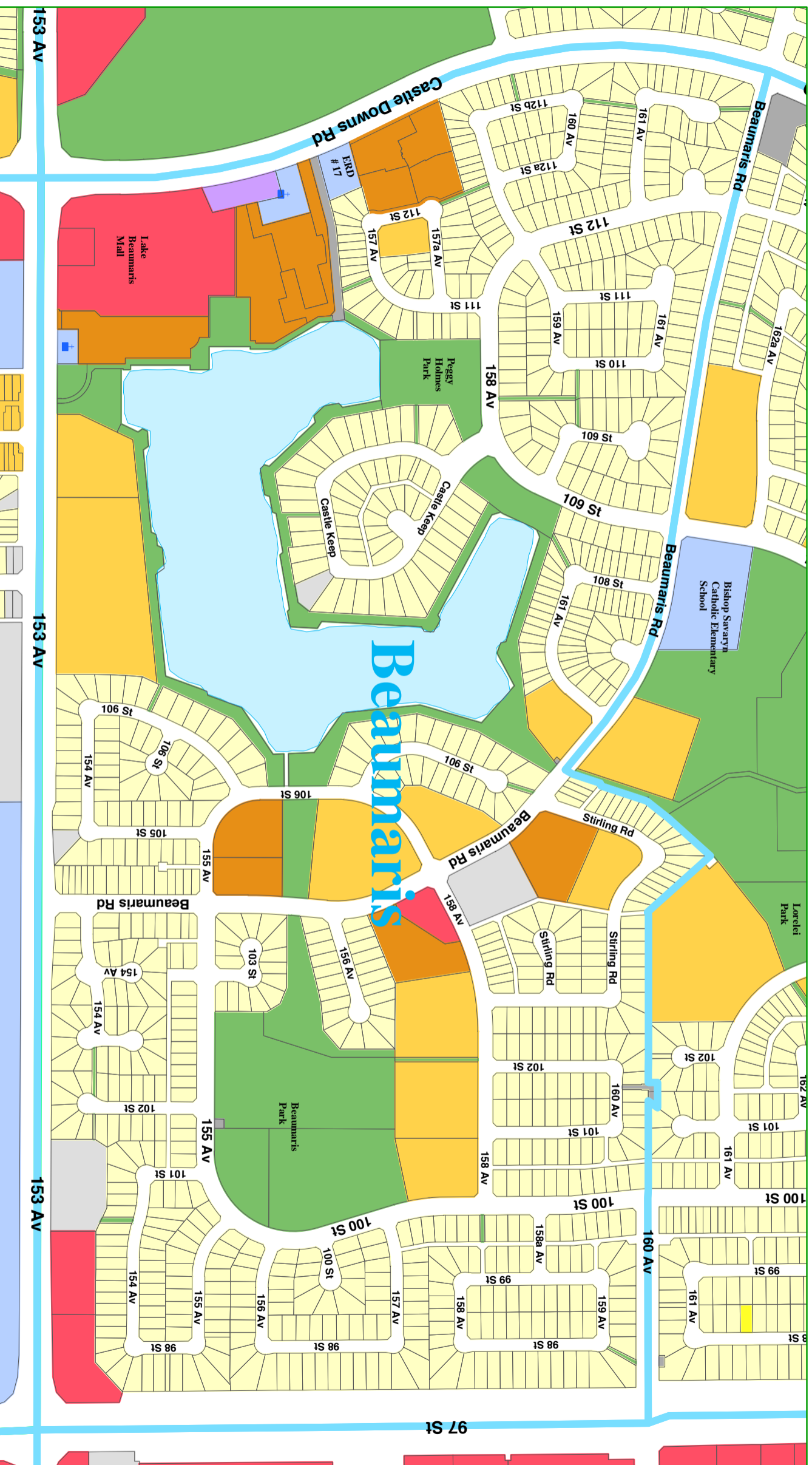

Existing Land Use

- One Unit Dwelling
- Two Unit Dwelling
- Multiple Dwelling Units
- Apartments
- Apartments High Rise
- Other Residential
- Commercial
- Industrial and Utilities
- Institutional
- Religious Assembly
- Recreation and Open Space
- Agriculture
- Transportation
- Vacant (Undeveloped/Underdred)
- No Data / Unknown

No reproduction of this map, in whole or in part, is permitted without express written consent of The City of Edmonton. Sustainable Development Department

Map compiled by:
Geospatial Services Unit
Urban Planning and Environment Branch

The City of Edmonton disclaims any liability for the use of this map.

