

BULLETIN

Reference: 17-1200-07
April 18, 2017

Lansdowne Neighbourhood Renewal

As part of the 2017 Neighbourhood Renewal Construction Program, the City of Edmonton, Integrated Infrastructure Services will be involved in construction in the Lansdowne Neighbourhood. **Please refer to the map on the back of this bulletin for the scope of work for the completion of neighbourhood renewal work in the 2017 construction season.** The contractor will be delivering another bulletin prior to construction on your side of the street with estimated start and end dates.

Construction is tentatively scheduled to commence on the week of April 24, 2017. Please anticipate that the duration of construction in front of your residences may be up to 12 weeks (weather dependent).

Scope of work

The construction consists of removal and replacement of public sidewalk, curb and gutter, and streetlight replacement as required and reconstruction and paving of the road.

Access

During the construction period, one lane of traffic in each direction will be maintained at all times, under flagperson control. No parking will be permitted in signed areas. Access to businesses, residences and alleys will be maintained, where possible, at all times. Emergency access will be maintained at all times. All residents are asked to access their homes through the alleys, if possible, for the majority of use during construction.

If you have special access requirements, such as DATS, please advise the contact person listed below.

Toward the completion of each portion of the project, the roadway will be closed to traffic on selected days to facilitate road reconstruction and asphalt paving. A bulletin will be circulated to the affected homes and businesses 5 working days prior to this work.

Landscaping

As part of the construction process, some re-landscaping will be necessary.

Please mark all underground sprinkler systems to avoid damage during construction.

Please retain this bulletin for contact information.

For information about what to expect during reconstruction, please visit:

edmonton.ca/buildinglansdowne

For further information, please contact:

Mr. Mark Morton PMP
Integrated Infrastructure Services
Phone: 780-944-7692

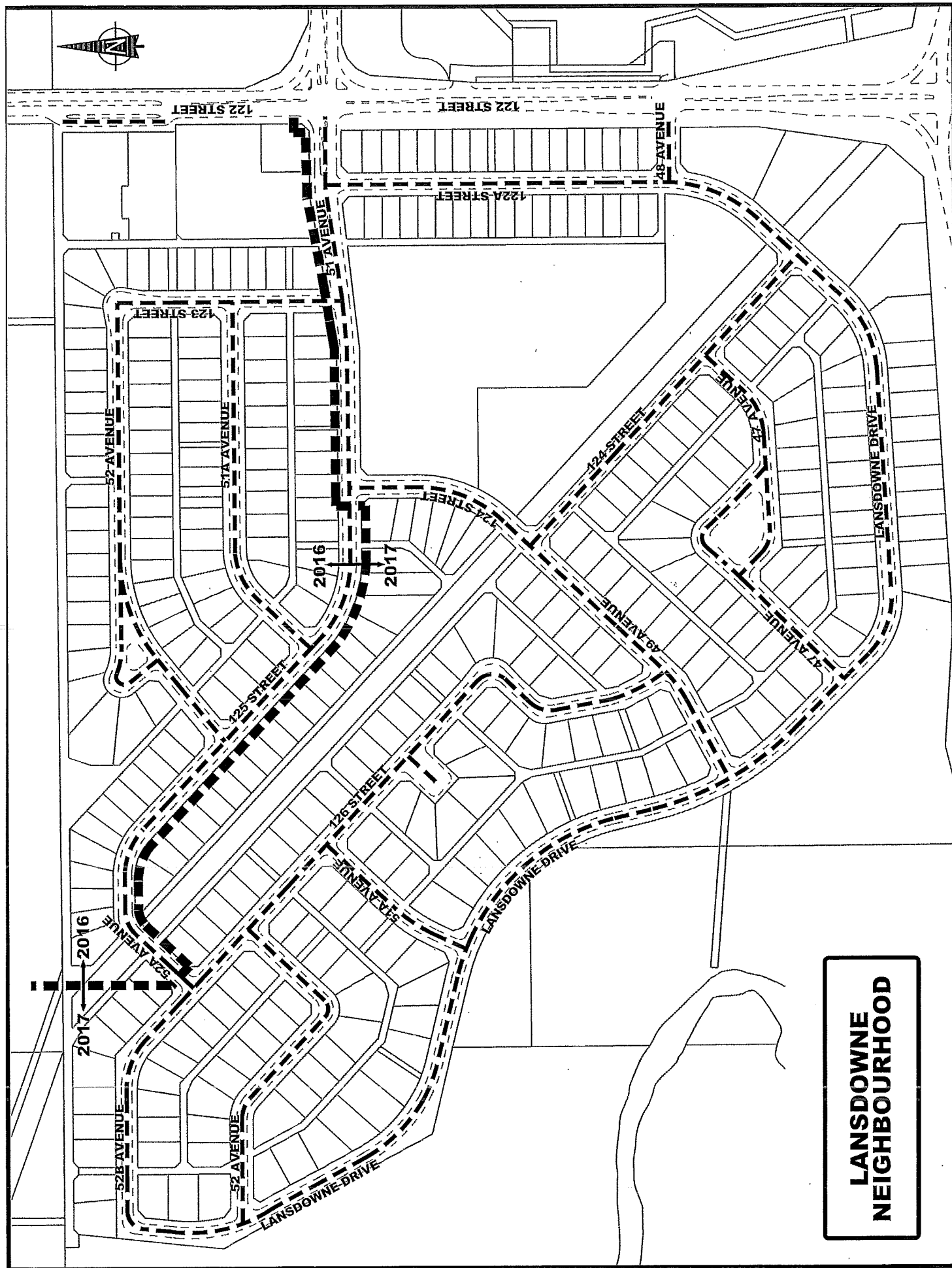

LANDSLOWNE NEIGHBOURHOOD