

**STOP** **LOOK** **learn**

Planning an **Escape Route** and a **Safe Meeting Place** in case an **Emergency** is good fire safety practice.

Try drawing your own house plan on the next page and plan your **ROUTE !**

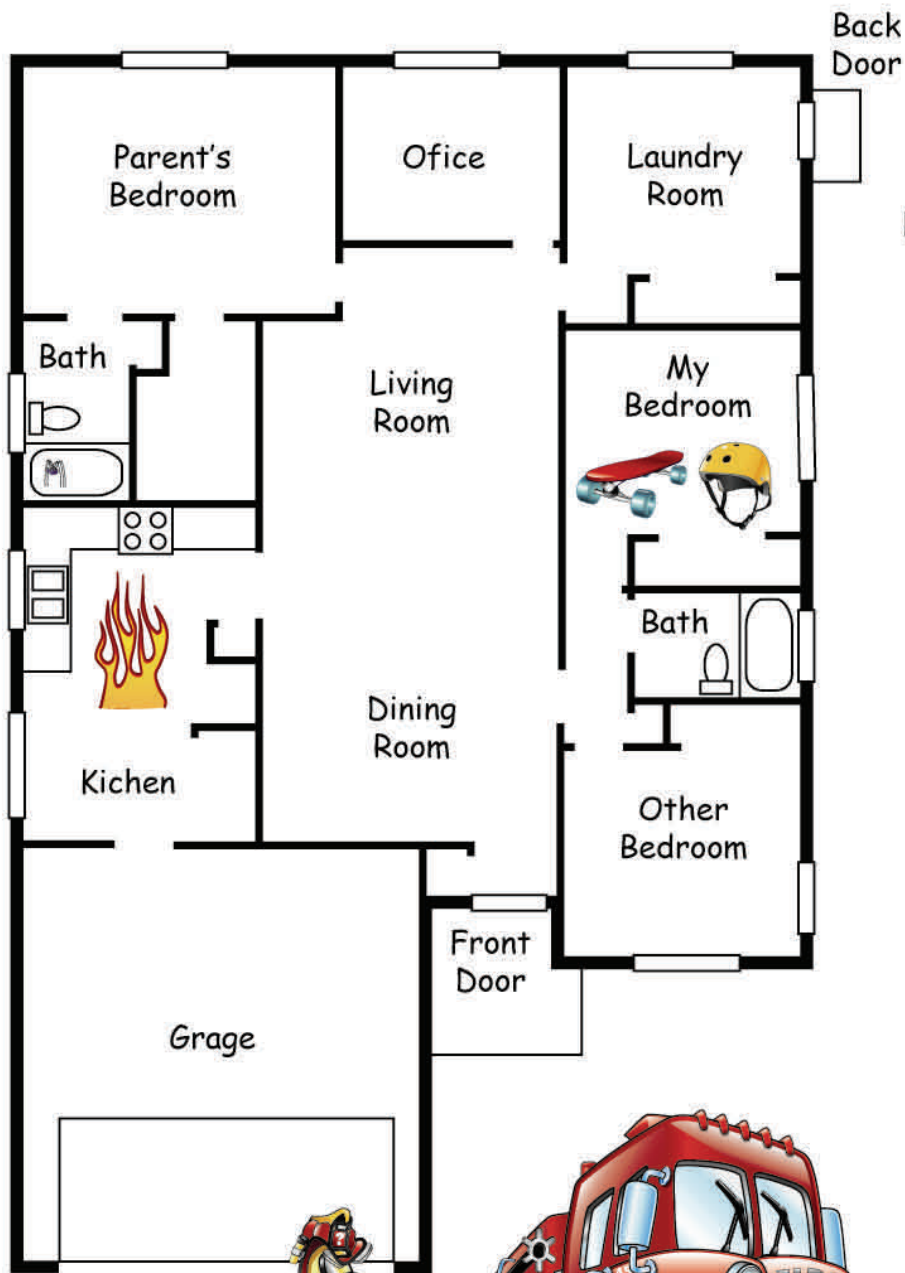

**Question ?**

1. How many escape routes should you know from each bedroom?

\_\_\_\_\_

2. How often should you **TEST** your smoke alarm ?

\_\_\_\_\_

3. Can a window be used to escape from ?

\_\_\_\_\_

4. What number do you dial when you reach the Safe Area ?

\_\_\_\_\_



Place the Fire Safe sticker where you would meet in your yard.



**Edmonton**

There are 3 spelling mistakes in the house plan above me. Can you find them ?

