

FOR CONTINUATION SEE PLAN S170 111 D02

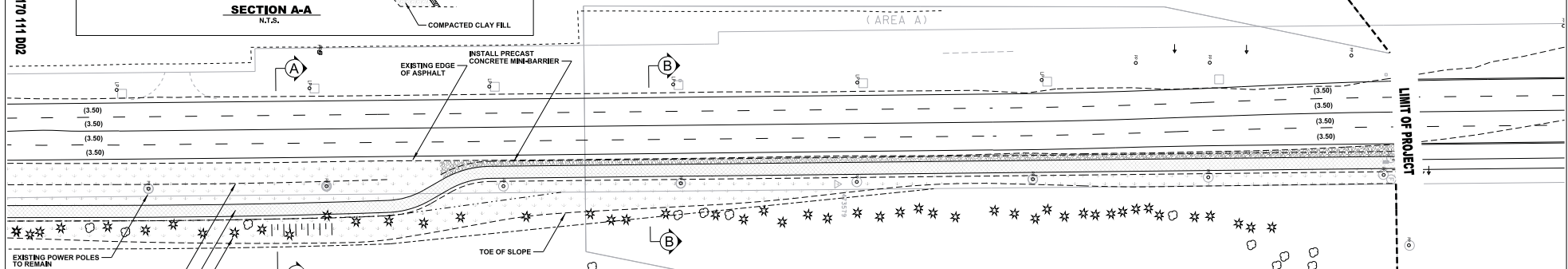
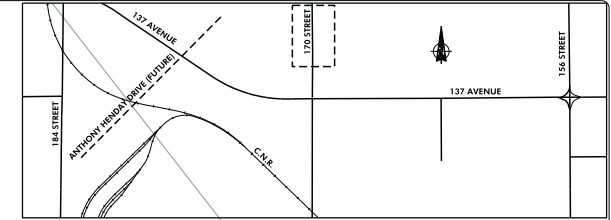
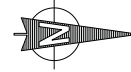
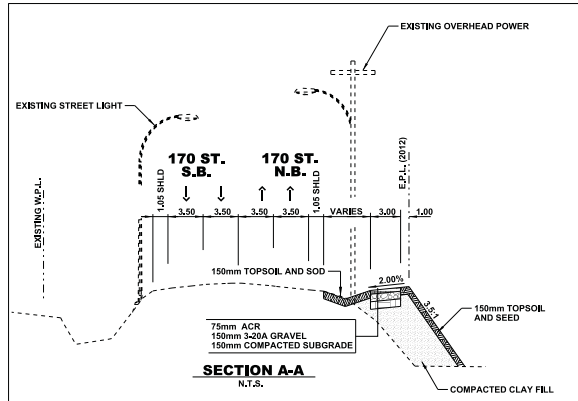

DETAIL NOTES

- STRUCTURAL ASPHALT OVERLAY REFERS TO THE DEPTH OF OVERLAY REQUIRED OVER THE EXISTING ASPHALT SURFACE (PRIOR TO COLD MILLING)
- REMOVE ALL LOOSE ASPHALT IN GUTTERS PRIOR TO OVERLAY.
- LANDSCAPING OF ALL BOULEVARD AREAS TO MEET COMMUNITY SERVICES SPECIFICATIONS:
ALL SOD OVER 100mm TOPSOIL
ALL SEED OVER 150mm TOPSOIL
- FOR ALL OVERLAYED GUTTERS, MAINTAIN A MINIMUM CURB HEIGHT OF 50mm FOR BOULEVARD WALKS AND A MINIMUM CURB HEIGHT OF 75mm FOR CURBLINE WALKS.
- ADJUST MANHOLES AND VALVES AS REQUIRED TO MATCH NEW PAVEMENT.
- ALL NEW CURB & GUTTER CONSTRUCTION TO BE 150mm STRAIGHT FACE CURB AND 250mm GUTTER, UNLESS OTHERWISE NOTED.
- ALL NEW MONOLITHIC SIDEWALKS TO BE 150mm STRAIGHT FACE CURB AND 250mm GUTTER, UNLESS OTHERWISE NOTED.
- REMOVE EXISTING CURB, GUTTER AND WALK AS REQUIRED.
- WHERE ASPHALT OVERLAY EXTENDS INTO EXISTING ACCESSES AND CURB RAMPS, ENSURE POSITIVE DRAINAGE TOWARDS ROADWAY.
- ALL TIES ARE TO LIP OF GUTTER (FOR CURB AND GUTTER CONSTRUCTION), TO CURBFACE (FOR SLABON CONSTRUCTION) AND ALL LANE DIMENSIONS ARE TO CURB FACE, UNLESS OTHERWISE NOTED.
- FINAL LIMITS OF BASE REMOVAL, CURB REPLACEMENT AND GRINDING AT MATCH LOCATIONS TO BE FIELD DETERMINED.
- ALL GRINDING IS BASED ON EXISTING PAINT LINE CONFIGURATION. FOR NEW PAINT LINE CONFIGURATION SEE PAINT PLANS
- NEW OVERLAY TO MATCH LIP OF GUTTER AT ALL NEW CURB RAMP LOCATIONS.
- SAW-CUT AREAS OF BASE REMOVAL.
- DEPRESS ALL NOSES ON NEW CONSTRUCTION.
- REPAIR ALL CRACKS PRIOR TO OVERLAY. ALL CRACKS GREATER THAN 25mm IN WIDTH SHALL BE GROUND DOWN 50mm x 1000mm WIDE. IF CRACK IS NOT CLOSED THEN GRIND DOWN ANOTHER 75mm x 600mm WIDE THEN PREFILL AND OVERLAY.
- C.B. NOTES:
a) RELOCATE/ADJUST CATCH BASINS TO MATCH NEW ALIGNMENT/GRADES (AS REQUIRED).
b) IF NEW ASPHALT OVERLAY IS 50mm OR LESS, WARP ASPHALT TO MATCH EXISTING LIP OF GUTTER AT ALL CATCH BASINS.
c) IF NEW ASPHALT OVERLAY IS GREATER THAN 50mm, RECONSTRUCT CURB, GUTTER AND CATCH BASINS TO MATCH OVERLAY REQUIREMENT.

DETAIL LEGEND

- GRAVEL BASE
- 3.0m SHARED USE PATH
- SEEDING
- PRECAST CONCRETE MINI-BARRIER

SURFACE UTILITY LEGEND

- TROLLEY POLES
- WOODEN POWER POLE
- POWER POLE
- STREET LIGHT POLE
- POWER MANHOLE
- POLE ANCHOR
- TRAFFIC POLE
- TELEPHONE MANHOLE
- TELEPHONE POLE
- DRAINAGE MANHOLE (SANITARY)
- DRAINAGE MANHOLE (STORM)
- CATCH BASIN MANHOLE
- CATCH BASIN
- FIRE HYDRANT
- WATER VALVE
- WATER TEE
- ANODE

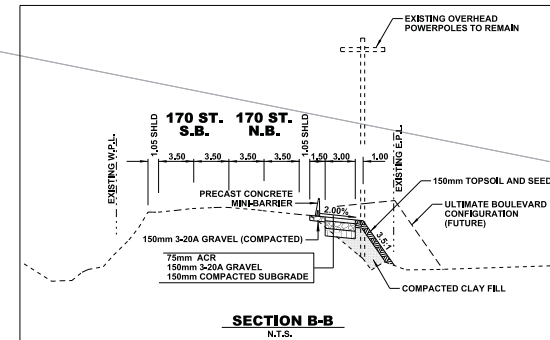

ISSUED FOR TENDER

7				
6				
5				
4				
3				
2				
1				
NO.	REVISIONS	BY	DATE	APPD

PROGRAM NO. 1612			
CONTRACT NO. 1240			
3	TO GOALS		
2	AS BUILT		
1	TENDER AWARD		
NO.	ISSUE	BY	DATE

CONSTRUCTION RETURN
CONTRACTOR
DATE
DATE
DATE
DATE
DATE
DATE
DATE
DATE
DATE

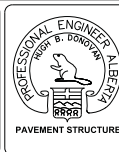

PERMIT TO PRACTICE
THE CITY OF EDMONTON
Signature
Date
PERMIT NUMBER: P 05038
The Association of Professional Engineers, Geologists and Geophysicists of Alberta
APPROVED FOR CONSTRUCTION

DEPARTMENT / BRANCH	APPROVAL	DATE

DIRECTOR OF ROADS DESIGN AND CONSTRUCTION	DATE
MANAGER OF ROADS DESIGN AND CONSTRUCTION	DATE
SURVEY	DATE
DESIGN	DATE
CONSTRUCTION	DATE
SCALE	1:500
SCALE	1:500
SCALE	1:500
SCALE	1:500
SCALE	1:500

THE CITY OF EDMONTON	TRANSPORTATION SERVICES
ROADS DESIGN AND CONSTRUCTION BRANCH	
137 AVENUE - 170 STREET	
138 AVENUE TO T.U.C.	
DETAIL PLAN	
S170 111 D03	