

Welcome to QEII Highway and 41 Avenue SW Interchange Information Session

Tuesday, June 18, 2013, 4:00 PM - 8:00 PM
Ellerslie Road Baptist Church - 10603 Ellerslie Rd SW, Edmonton

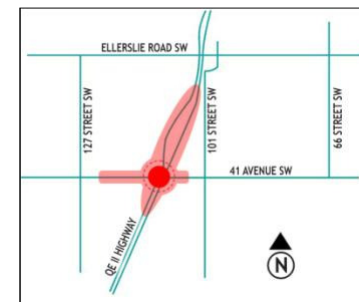

Purpose

- To inform about project construction - the extent and nature of the work
- To display the anticipated construction schedule
- To outline anticipated impacts to traffic
- To respond to questions and inquiries

For further information visit the project website at: www.edmonton.ca/roadprojects

About the Project

- A partial cloverleaf interchange will convert 41 Avenue SW into a continuous corridor with full access to and from QEII highway. New bridges over Blackmud Creek, QEII Highway and the CP Rail tracks will be constructed along with widening and pavement improvements to QEII, utility modifications and new storm water drainage components.
- The \$205 Million project is jointly funded by the City of Edmonton, Alberta Transportation, and the Federal Government, through the Asia-Pacific Gateway and Corridor Initiative (APGCI).
- The City of Edmonton is leading construction phase delivery of the project. Alberta Transportation will assume ownership and maintenance responsibility upon construction completion.

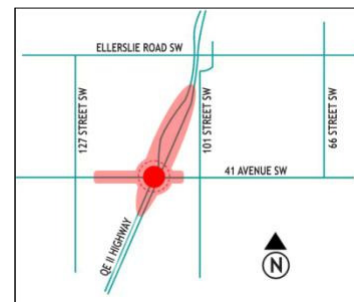

For further information visit the project website at: www.edmonton.ca/roadprojects

Public Communication Summary

Previous Meetings / Communications

- January 25, 2007 - QEII Planning Study Open House at the Ellerslie Baptist Church
- June 13, 2007 - QEII Planning Study Open House at the Nisku Inn
- June 14, 2007 - QEII Planning Study Open House at the Holiday Inn (The Palace)
- June 24, 2008 - QEII Planning Study Open House at the Ellerslie Rugby Park
- June 24, 2008 - City of Edmonton 41st Avenue SW Open House at the Ellerslie Rugby Park
- June 23, 2009 - QEII Planning Study Open House at the Nisku Inn
- April 26, 2013 - Media update announcing joint funding for the project at Gateway Park

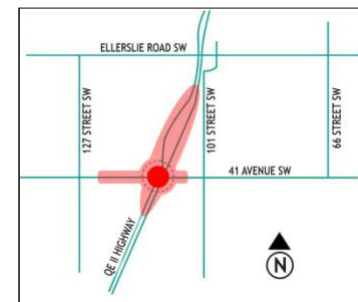

Moving Forward

- Media updates during construction - eg. major traffic closure notices
- Website updates - project progress during construction
- Responses to inquiries

For further information visit the project website at: www.edmonton.ca/roadprojects

Environmental

- Prior to design phase a Canadian Environmental Assessment Act (CEAA) Screening Report was prepared to identify environmental considerations for the project.
- The project has been designed and will be constructed in accordance with Federal and Provincial environmental legislation, as well as Municipal bylaws.
- The work will be completed in accordance with the City of Edmonton's ENVISO Program.

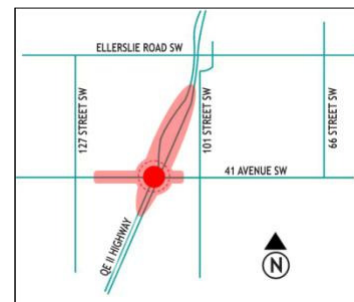

For further information visit the project website at: www.edmonton.ca/roadprojects

Interchange Traffic Movement

The partial cloverleaf interchange at 41 Avenue SW will create full access to and from QE II Highway allowing traffic movements as shown below.

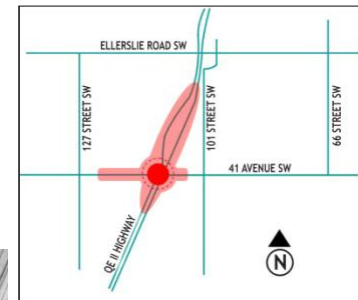
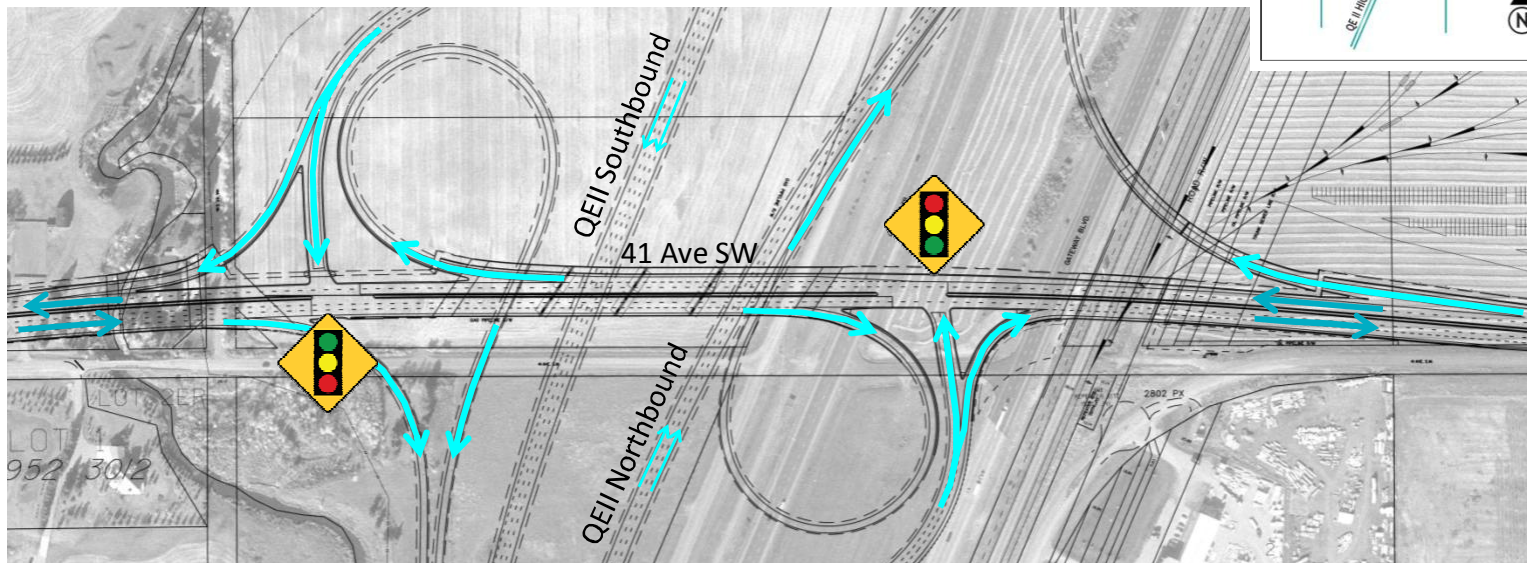

For further information visit the project website at: www.edmonton.ca/roadprojects

Bridges on 41 Avenue SW

New bridges will be constructed over:

1. Blackmud Creek,
2. QEII Highway,
3. CP Rail tracks - Main, and
4. CP Rail tracks - Ramp

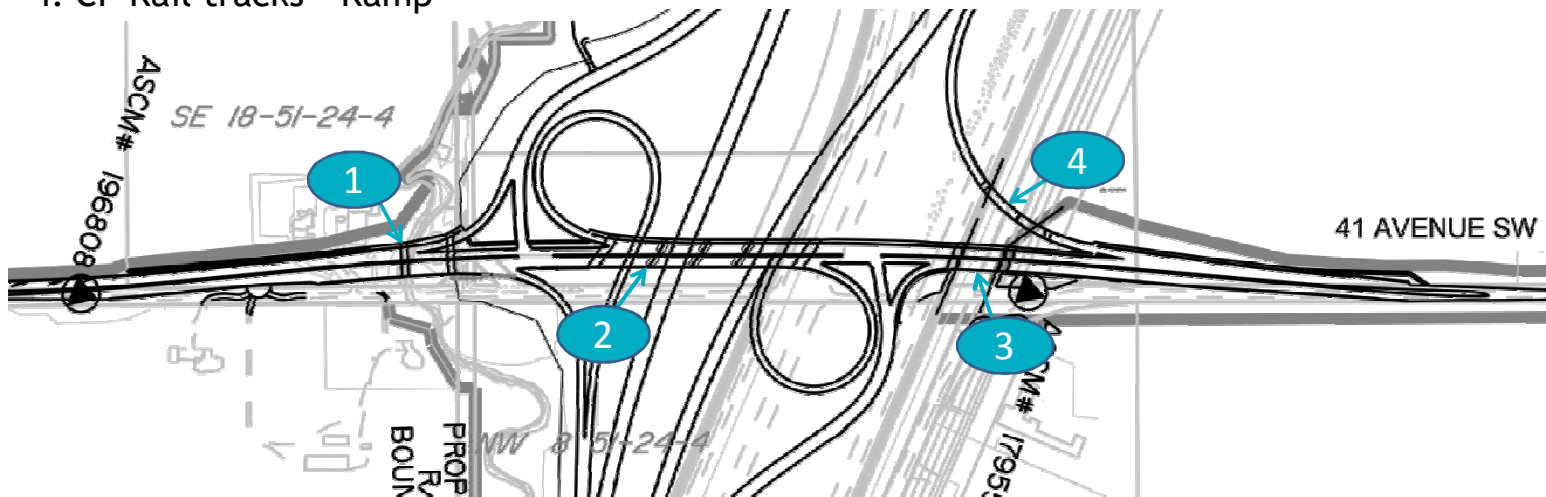
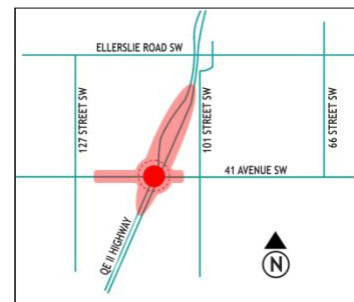

For further information visit the project website at: www.edmonton.ca/roadprojects

Pedestrian & Cyclist Accommodation on 41 Avenue SW

The 41 Avenue SW interchange approach roadways and bridges will incorporate a multi-use trail along the north side of the avenue to accommodate pedestrian and cyclist movements from the west side of the QEI Highway corridor over Blackmud Creek, QE II Highway, and the CP Rail tracks to the east side.

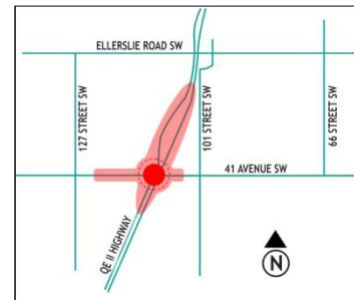

For further information visit the project website at: www.edmonton.ca/roadprojects

Lane Closures Permitted	a.m.											p.m.												
	12	1	2	3	4	5	6	7	8	9	10	11	12	1	2	3	4	5	6	7	8	9	10	11
Monday to Thursday																								
Friday																								
Saturday																								
Sunday																								
Legend:	= No lanes closed											= Up to 1 lane closed												
												= Up to 2 adjacent lanes closed												





Asia-Pacific Gateway and Corridor Initiative (APGCI)
 Queen Elizabeth II (QEII) Highway and 41 Avenue SW



Anticipated Traffic Routing - Initial Stage of Construction

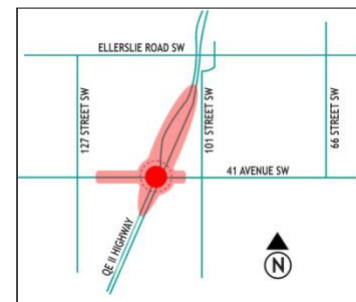
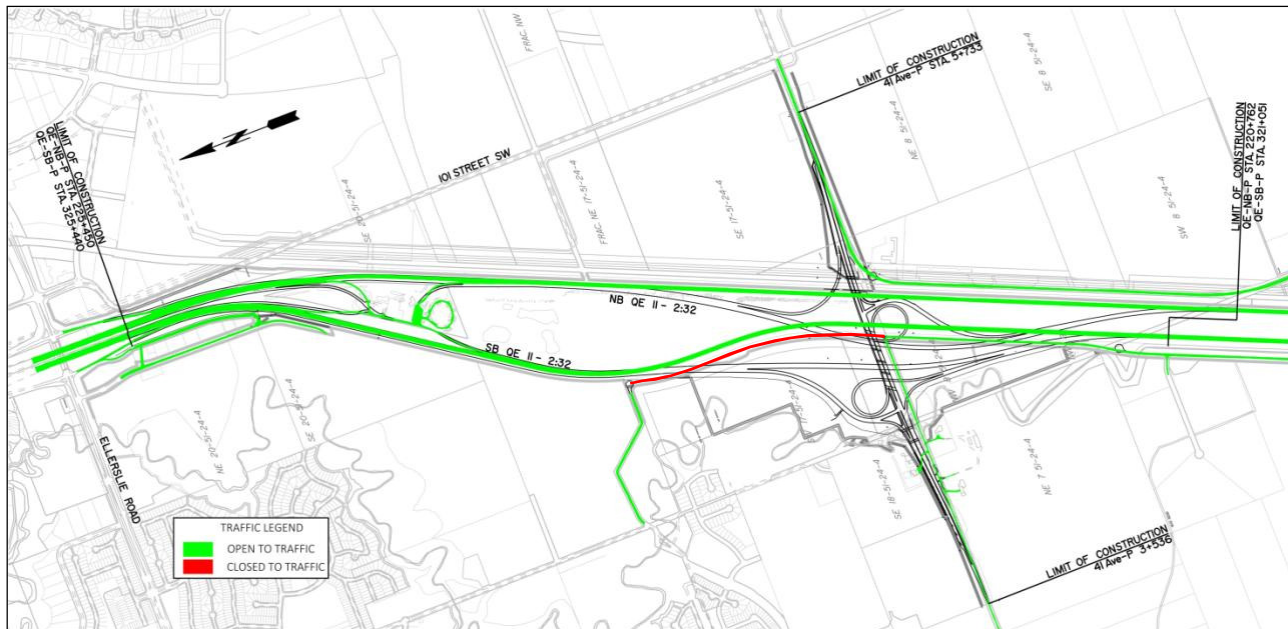

For further information visit the project website at: www.edmonton.ca/roadprojects

Anticipated Traffic Routing - Local Road Changes

The new interchange results in the need to interrupt local service roads flanking QE II Highway. Advance notice/signs of service road changes will be provided.

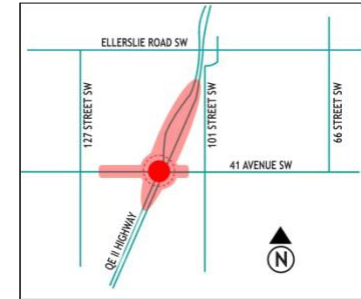
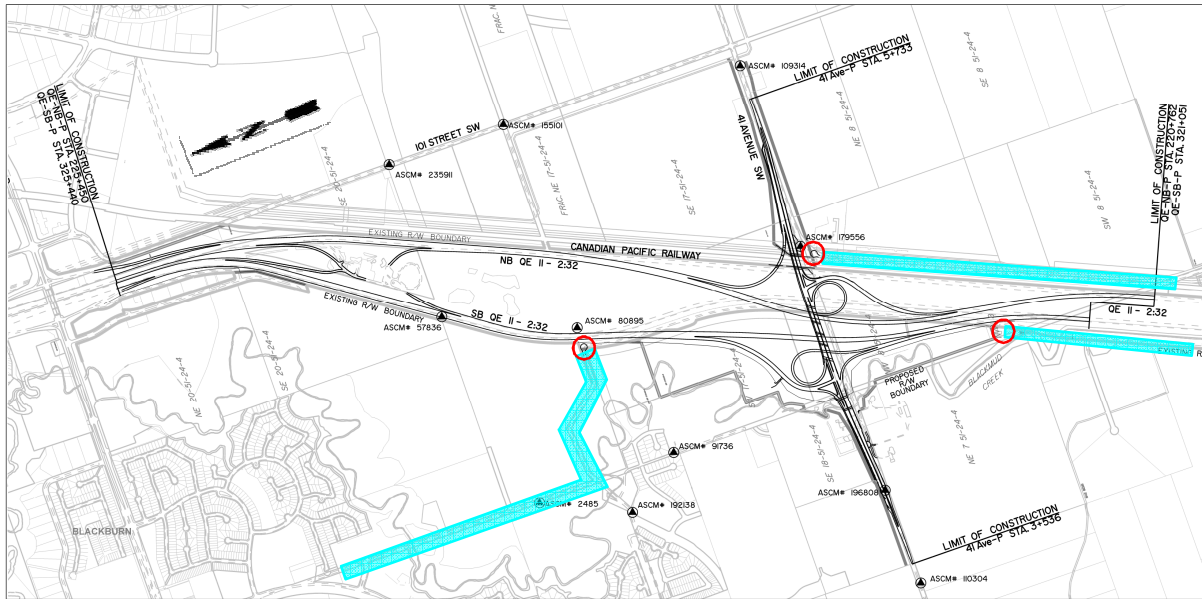

For further information visit the project website at: www.edmonton.ca/roadprojects

Anticipated Traffic Routing - Intermediate Stage (1) of Construction

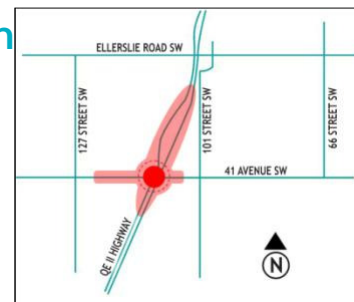
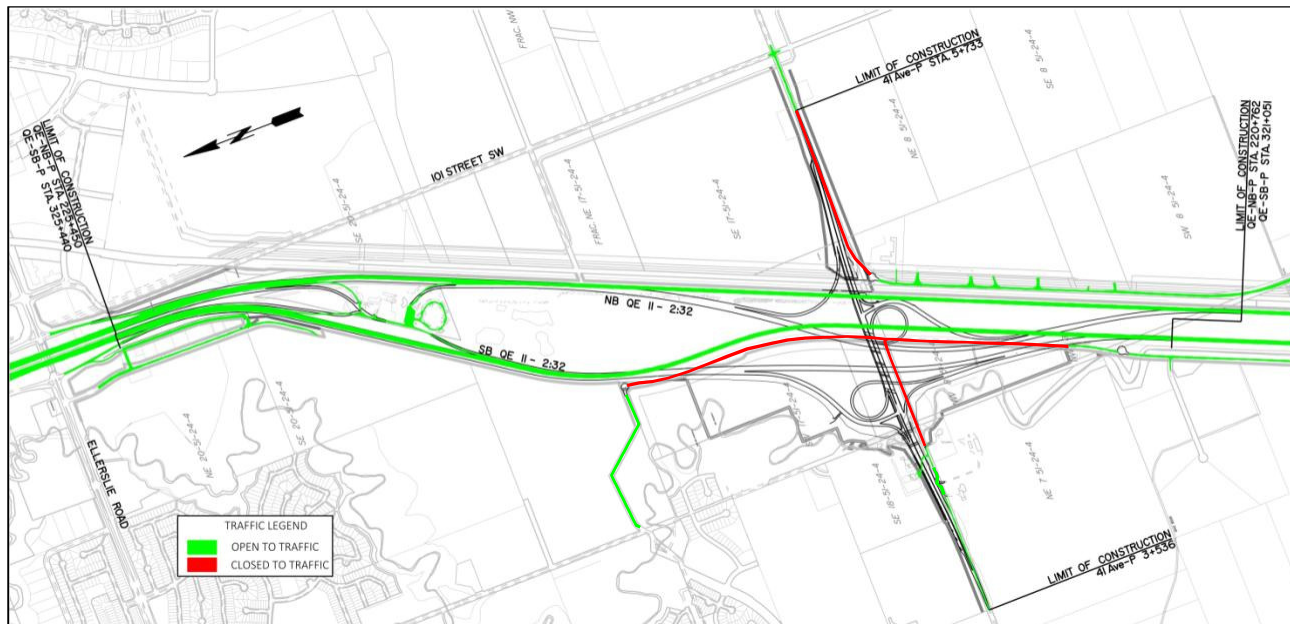

For further information visit the project website at: www.edmonton.ca/roadprojects

Anticipated Traffic Routing - Intermediate (Stage 2) of Construction

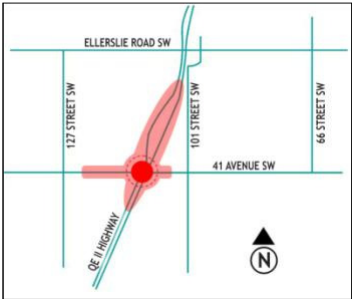
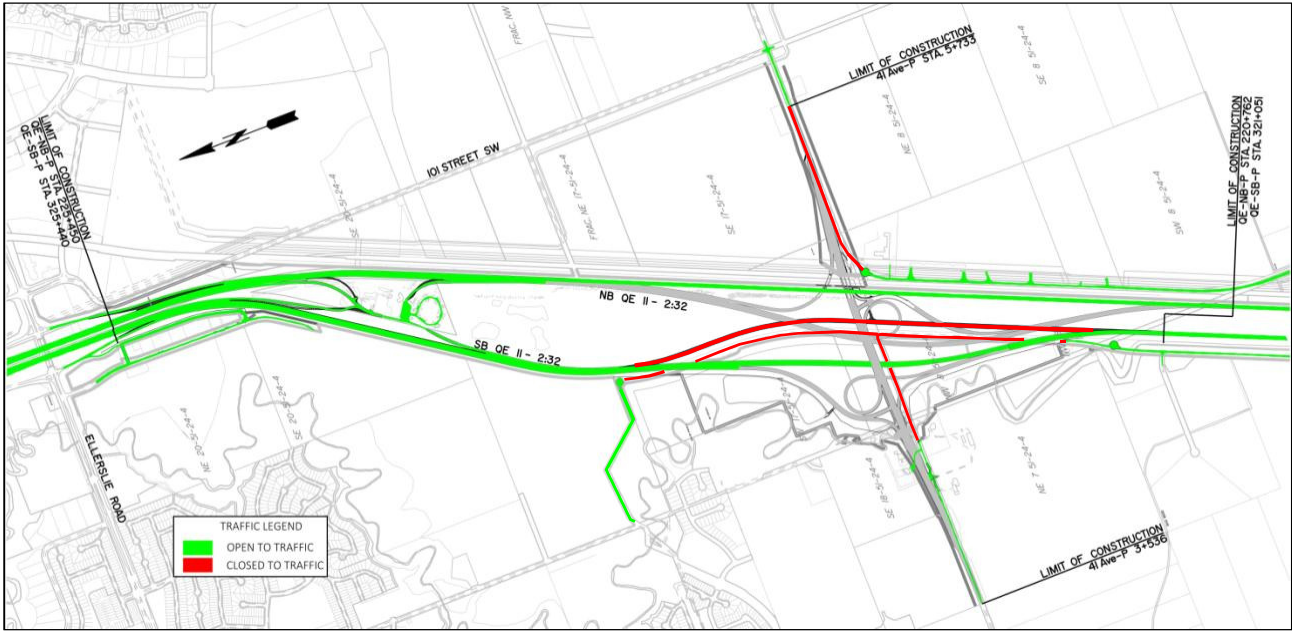

For further information visit the project website at: www.edmonton.ca/roadprojects

Traffic Routing - Construction Complete

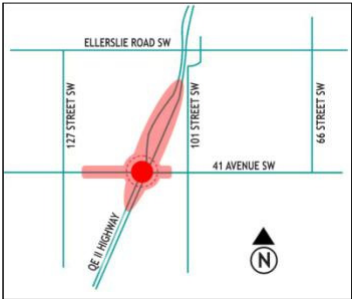
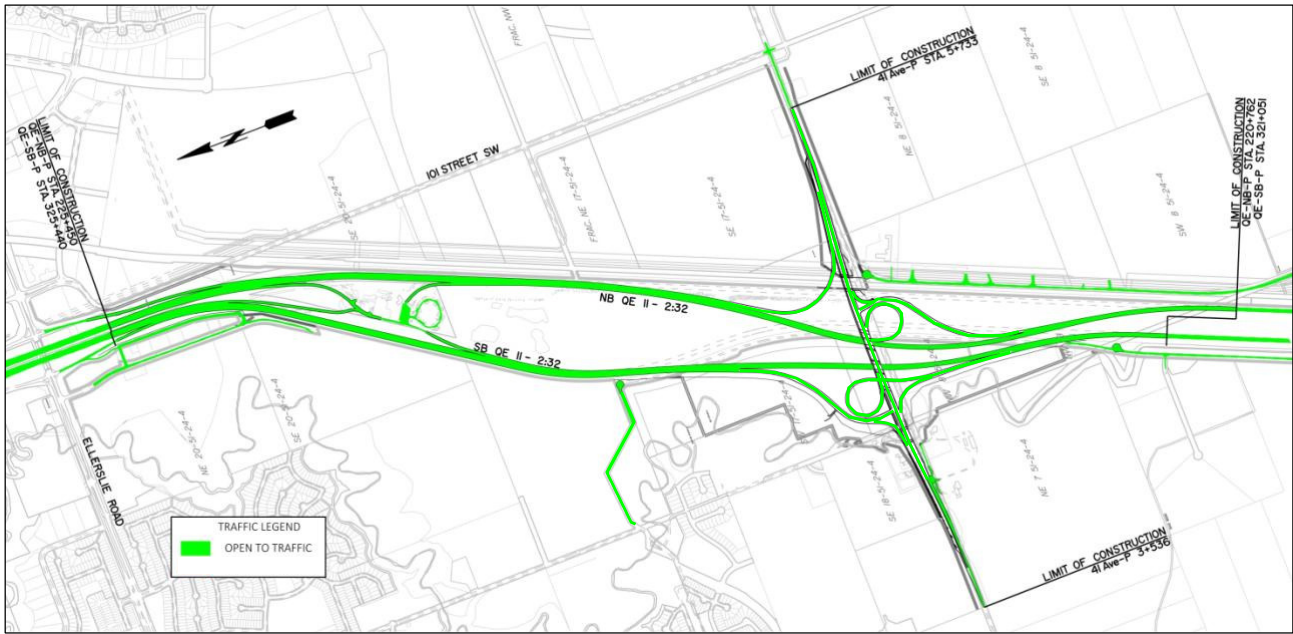

For further information visit the project website at: www.edmonton.ca/roadprojects

Anticipated Construction Schedule

The contract for interchange construction was awarded to a Joint venture of Alberco Construction and Prairie Roadbuilders in June of 2013.

Interchange construction is presently scheduled to begin in July 2013 with completion by 2016.

Construction has three major components:

- Utility Relocations (initiated in spring 2013)
- Highway & Drainage Work
- Bridge Work

Specific staging details and schedule of construction execution is the responsibility of the Contractor.

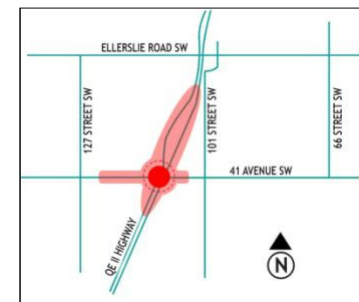

For further information visit the project website at: www.edmonton.ca/roadprojects

QEII Highway and 41 Avenue SW Interchange Public Meeting

Tuesday, June 18, 2013

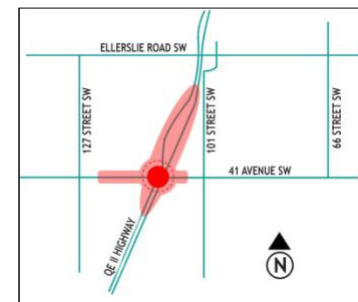

- Thank you for your participation
- Please complete the feedback form before you leave and drop it in the box provided



For further information visit the project website at: www.edmonton.ca/roadprojects