

An aerial photograph of a city street, likely in Edmonton, showing a mix of residential and commercial buildings, trees, and a bus. The image is partially obscured by a blue overlay on the left side.

Transportation Services

Pleasantview Community Traffic Management Plan

Trial: Ongoing Feedback
November 26, 2015

Agenda

- Welcome and Introductions
- Sharing Information
 - Background and Context
 - Data Collection - Results
- Gathering Input
- Wrap-up



Background/Context

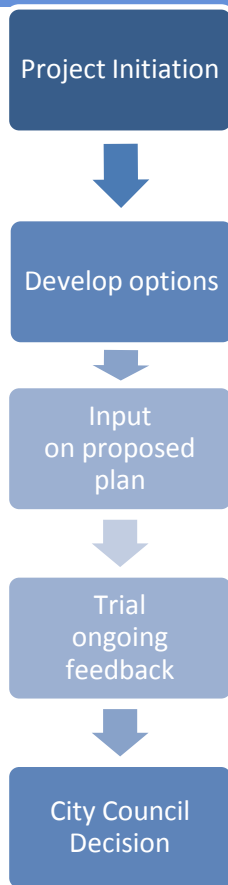

Project Initiation

- History of traffic concerns in the community
- Community group survey identified concerns with traffic & safety
- Expression of Interest (signed by 25% of households)
- Council approved

Background/Context

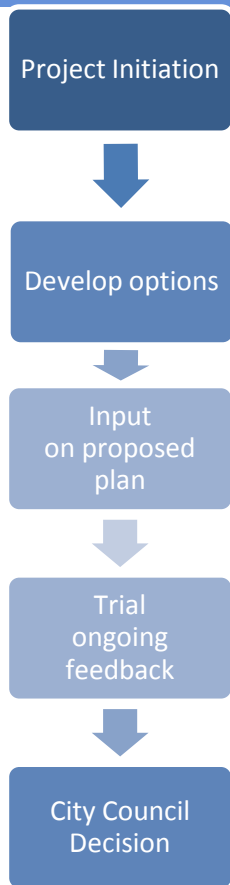

Milestones

- March 2014: Drop-in Workshops - Feedback on potential measures
- April 2015: Public Meeting to review plans for the trial
- July 2015: Trial measures installed

Current Status

Trial: Ongoing Feedback (Oct- Nov 2015)

- Meetings: 109 Street, 106 Street, community-wide
- 93 participants at initial meetings
- Input: What are your experiences? What are your ideas?
- Process: input to new policy

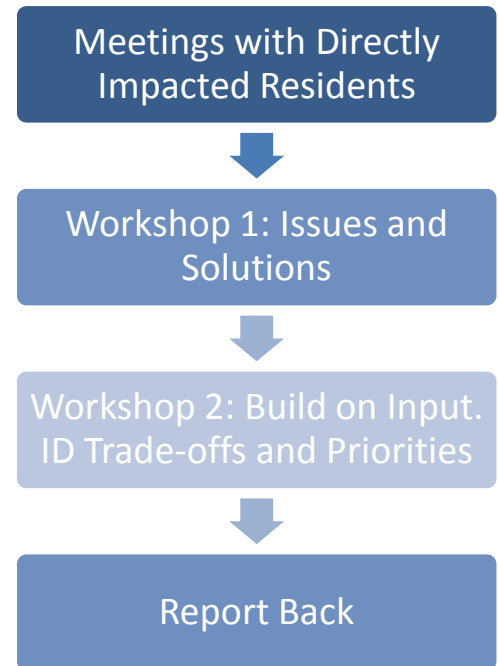



Competing Themes

- Engineering solutions: traffic diverters, road closures, speed humps, stop signs, school drop-off
- Non-engineering solutions: speed limit reduction, parking programs, bus route changes
- Process: broader reaching, more input for wider community, more rigour in decision-making



Next steps

January/February (2016)

- Workshop to talk about next steps for the trial
- What are the priorities? What tradeoffs could be made?
- Report to Council's Transportation Committee on next steps for the project based on what we heard



This is a passionate issue

- It impacts you where you live – your home
- We know there is division

This is about balance

- There's no perfect answer or solution
- Individual needs need to be balanced with community-wide needs

An aerial photograph of a city street, likely in Edmonton, showing a mix of residential and commercial buildings, trees, and a bus. The image is partially obscured by a blue overlay on the left side.

Transportation Services

Pleasantview Community Traffic Management Plan

Results of Fall Data Collection

Pleasantview Traffic Monitoring

PLEASANTVIEW TRAFFIC MONITORING

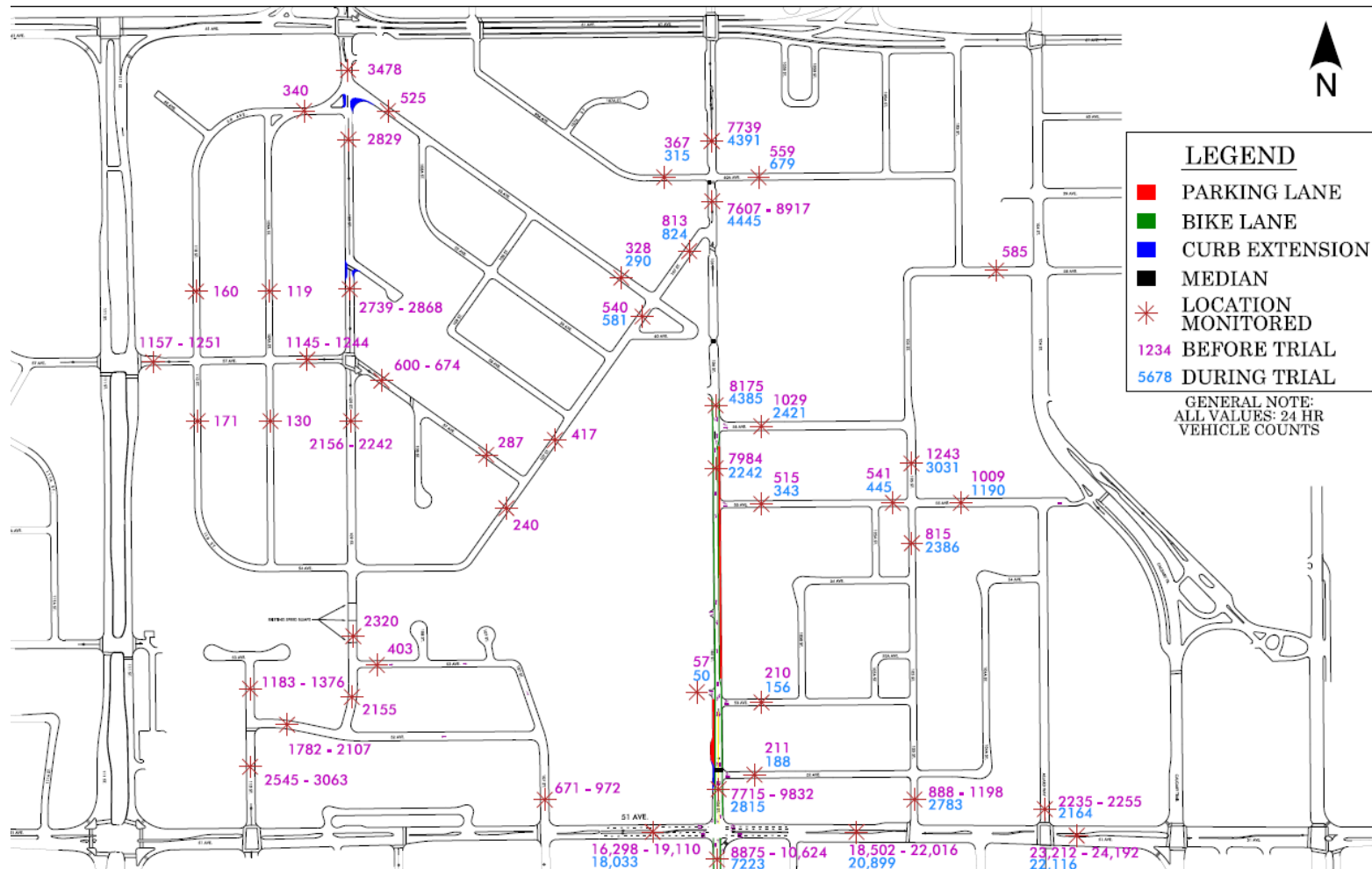

NOVEMBER 26, 2015

An aerial photograph of a residential street in Pleasantview, showing a row of colorful houses, a paved road with parked cars, and a sidewalk with trees and pedestrians. A semi-transparent blue banner is overlaid on the left side of the image, containing the text 'Pleasantview Speed Monitoring' in white.

Pleasantview Speed Monitoring

PLEASANTVIEW SPEED MONITORING

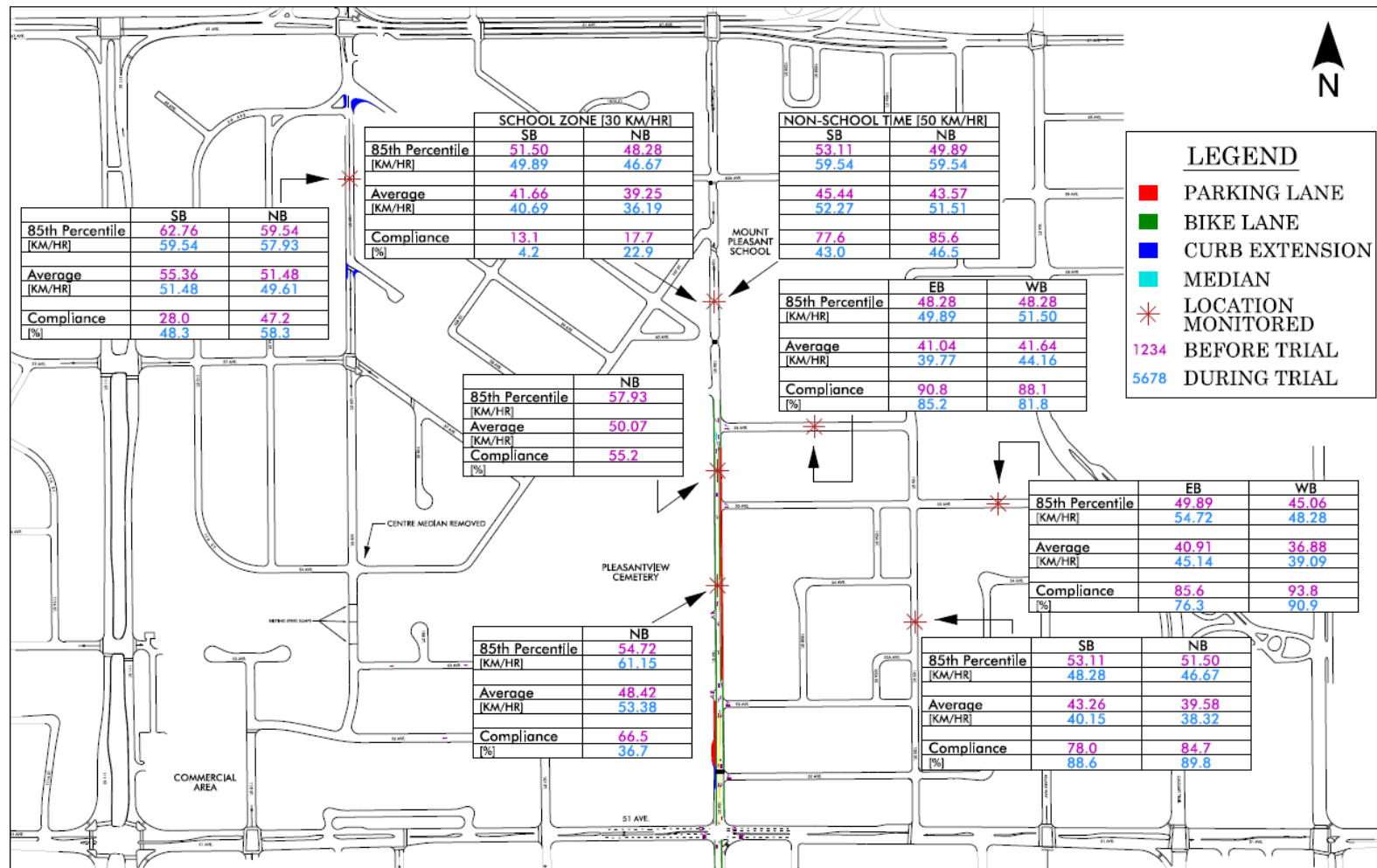

NOVEMBER 26, 2015

Pleasantview Traffic Monitoring – 106 Street

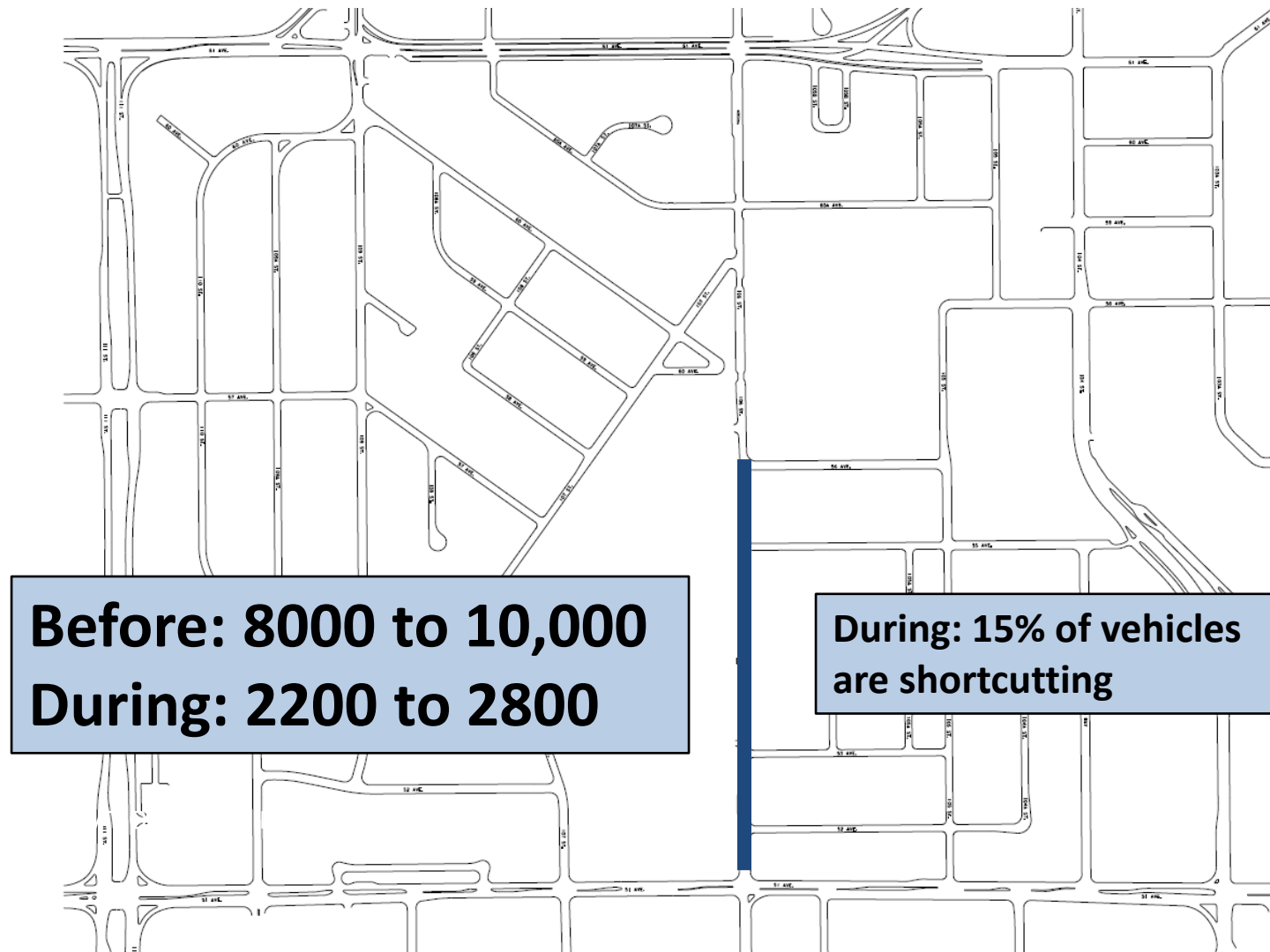

Pleasantview Traffic Monitoring – 106 Street



Pleasantview Traffic Monitoring – 56 Avenue

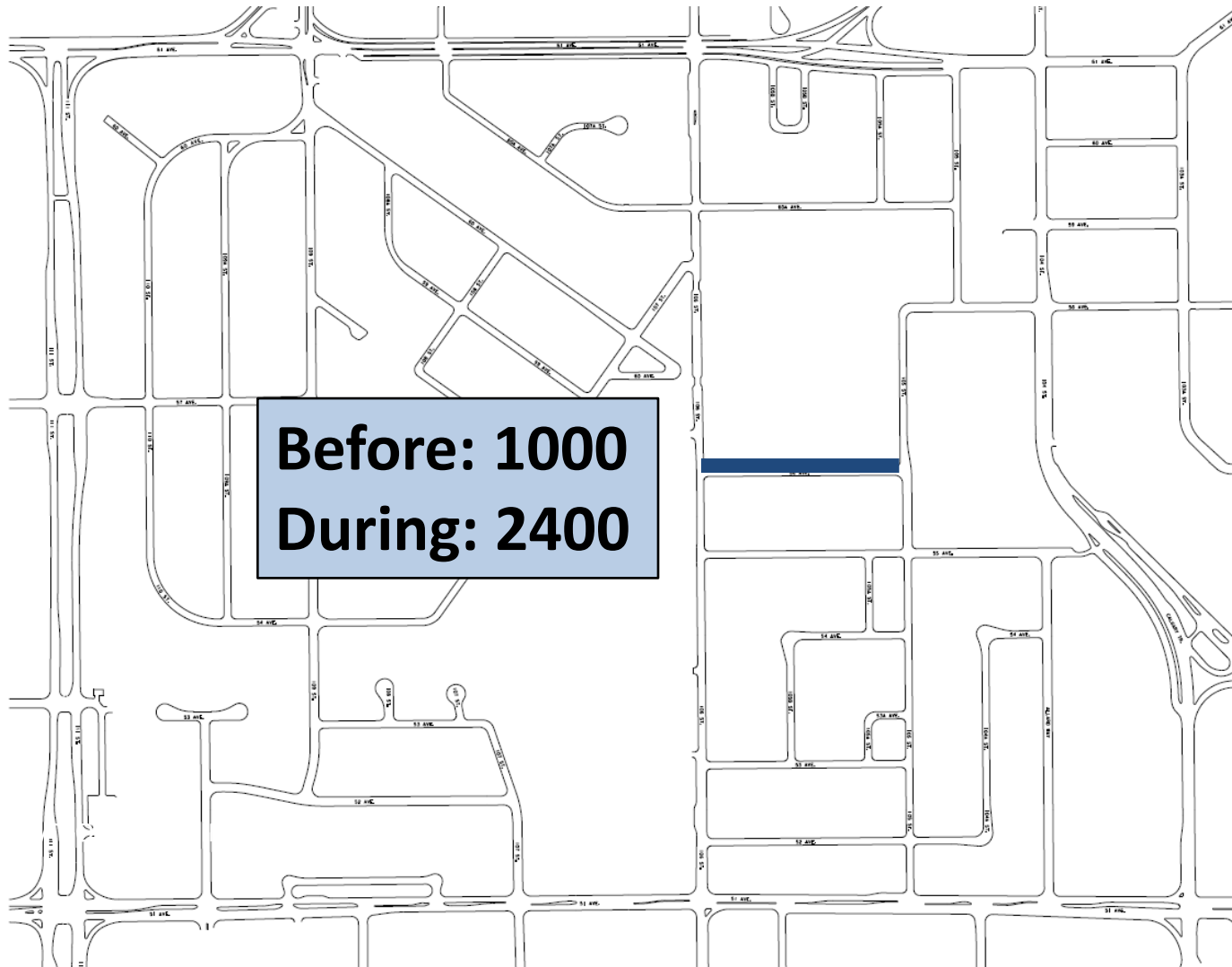

Pleasantview Traffic Monitoring – 105 Street

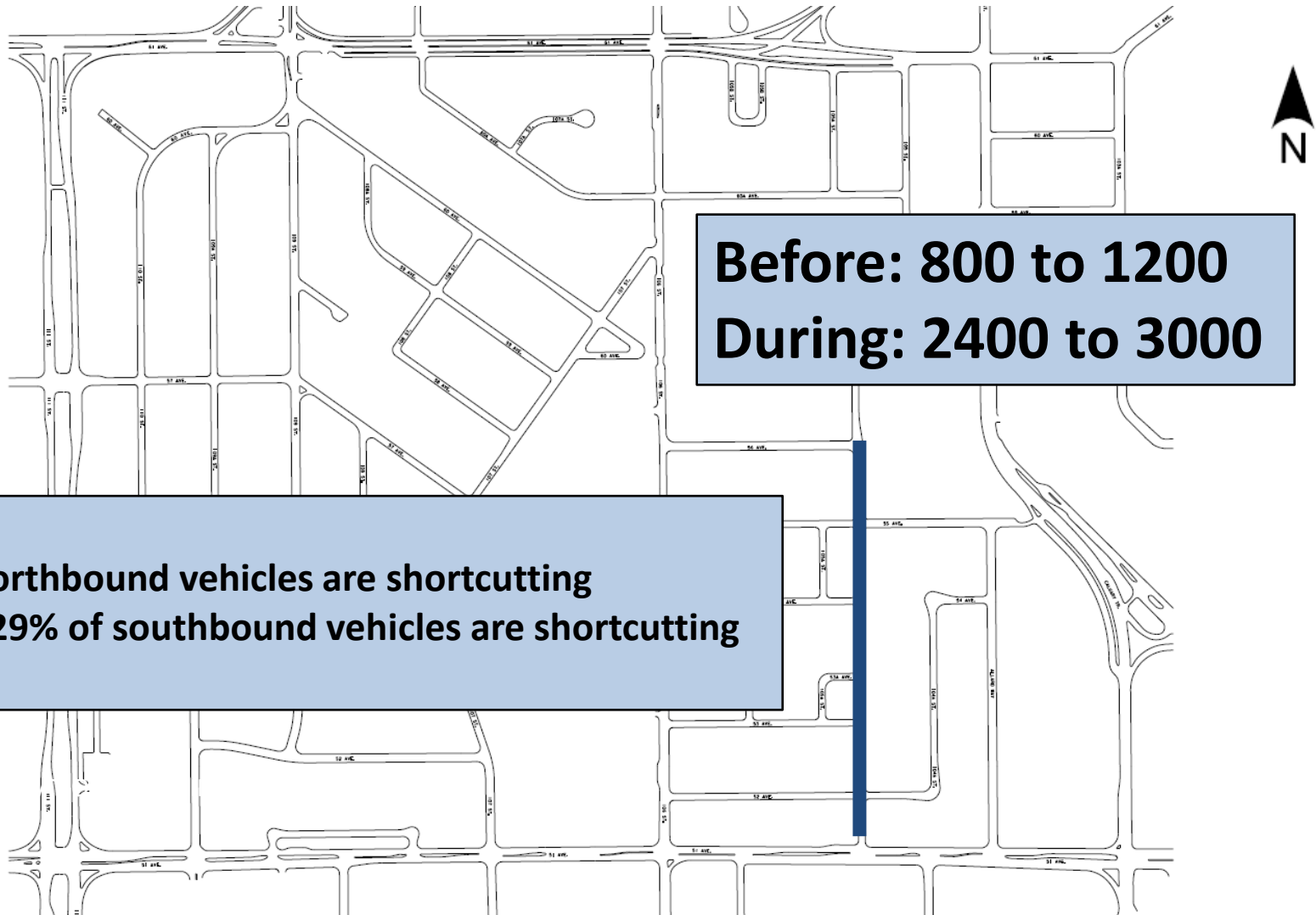

Pleasantview Traffic Monitoring – Allard Way

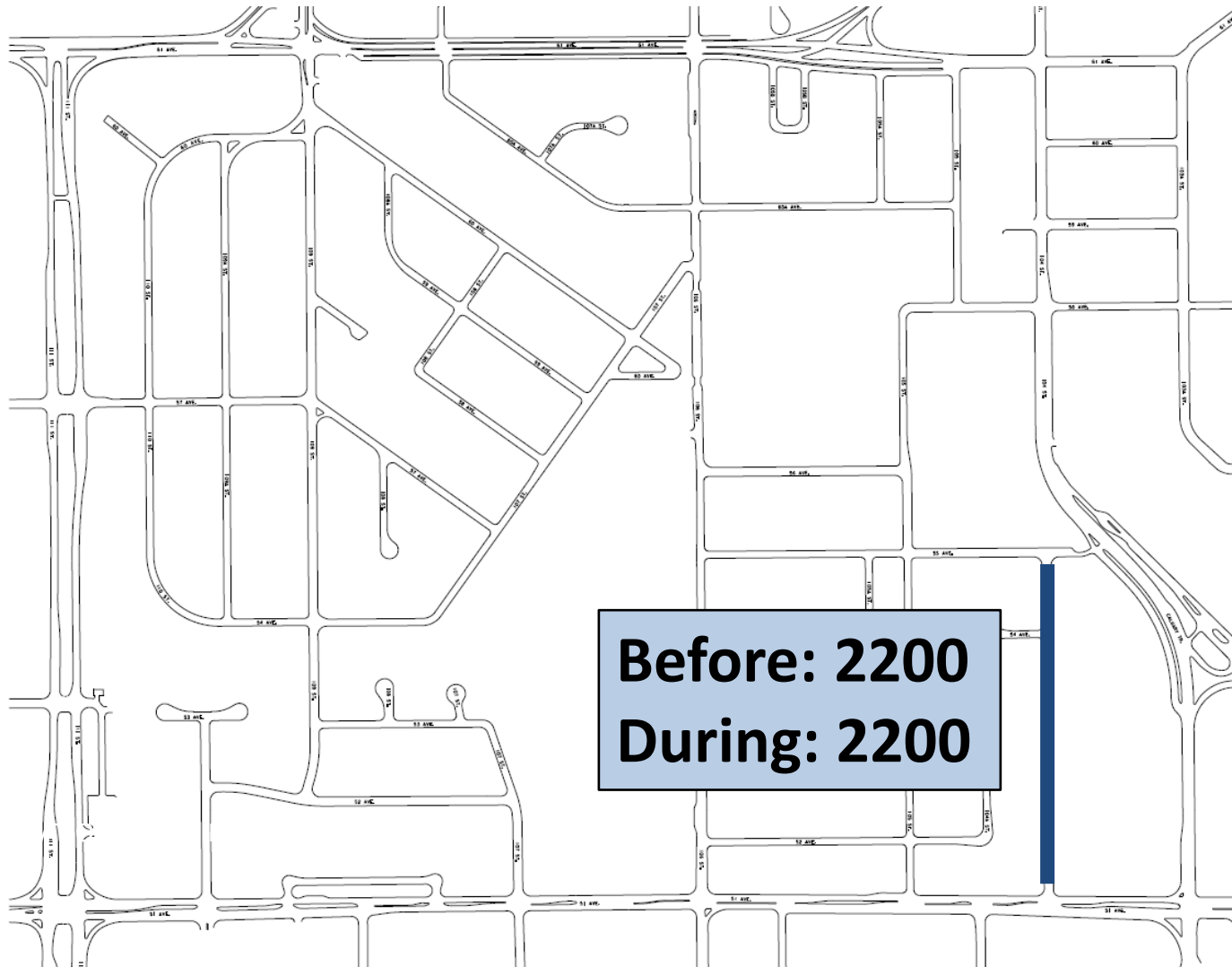

Pleasantview Traffic Monitoring - Summary

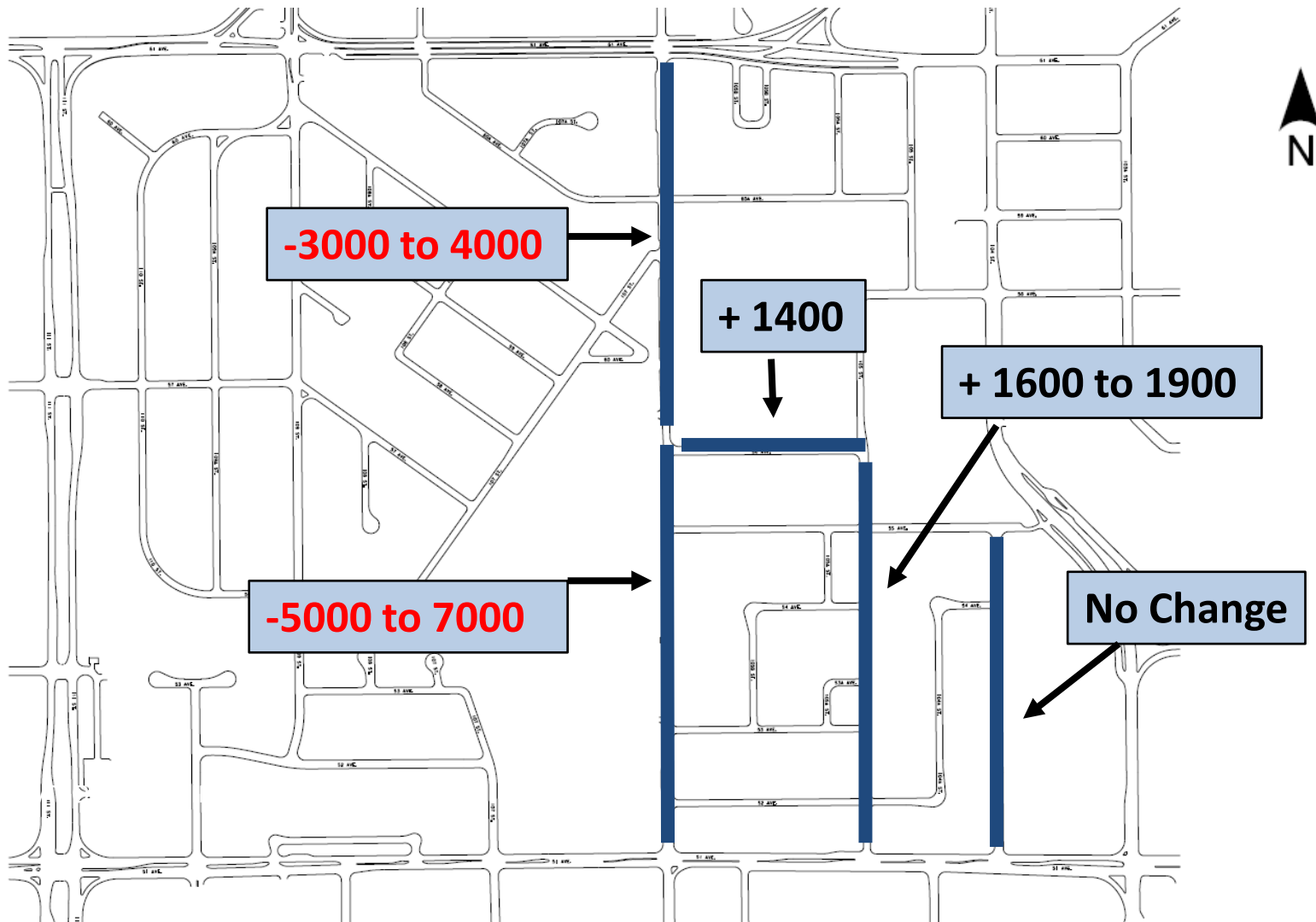

Pleasantview Speed Monitoring – School Zone

Posted 30 km/hr

Speeds have reduced

Compliance between 4% and 23%

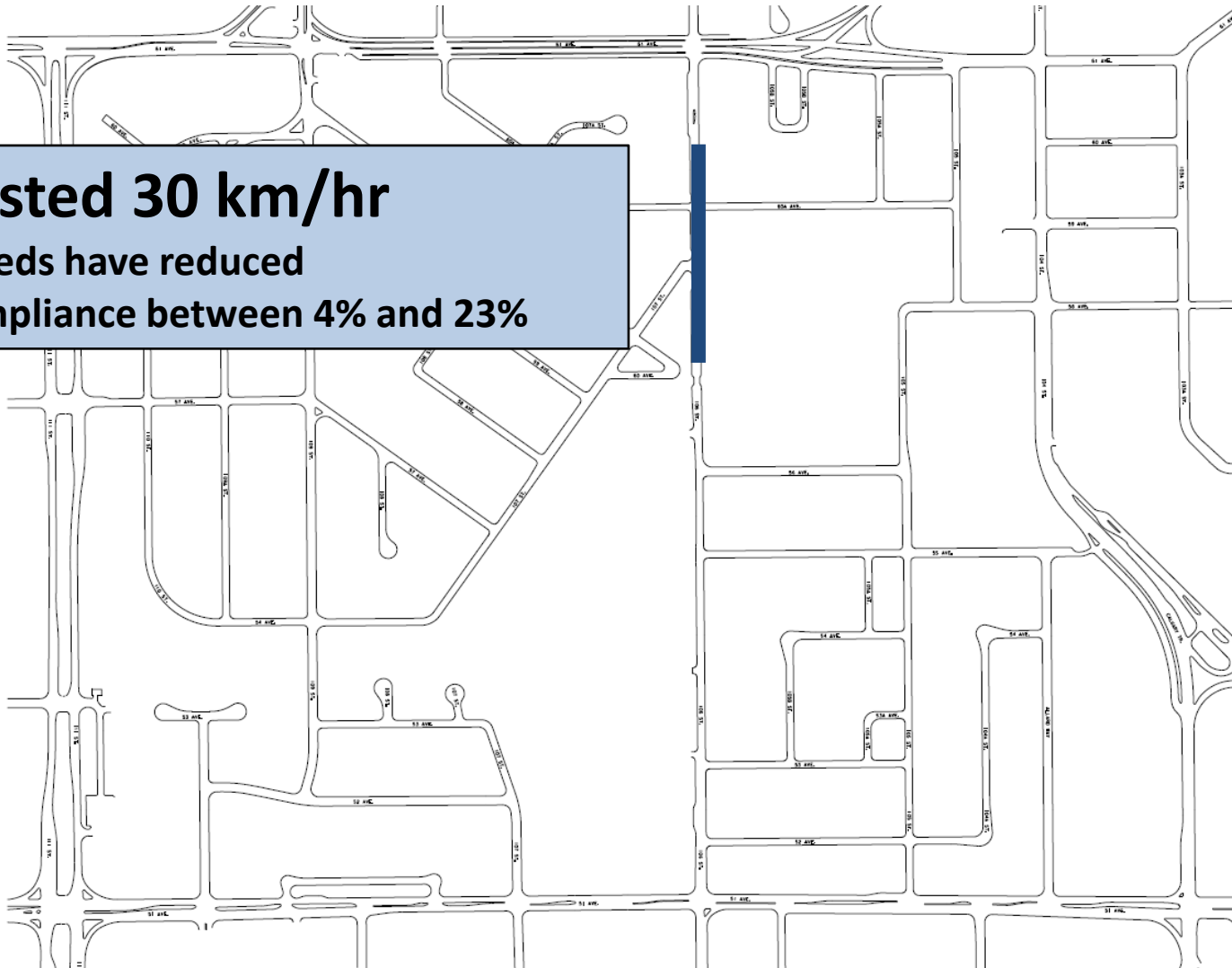

Pleasantview Speed Monitoring – 106 Street

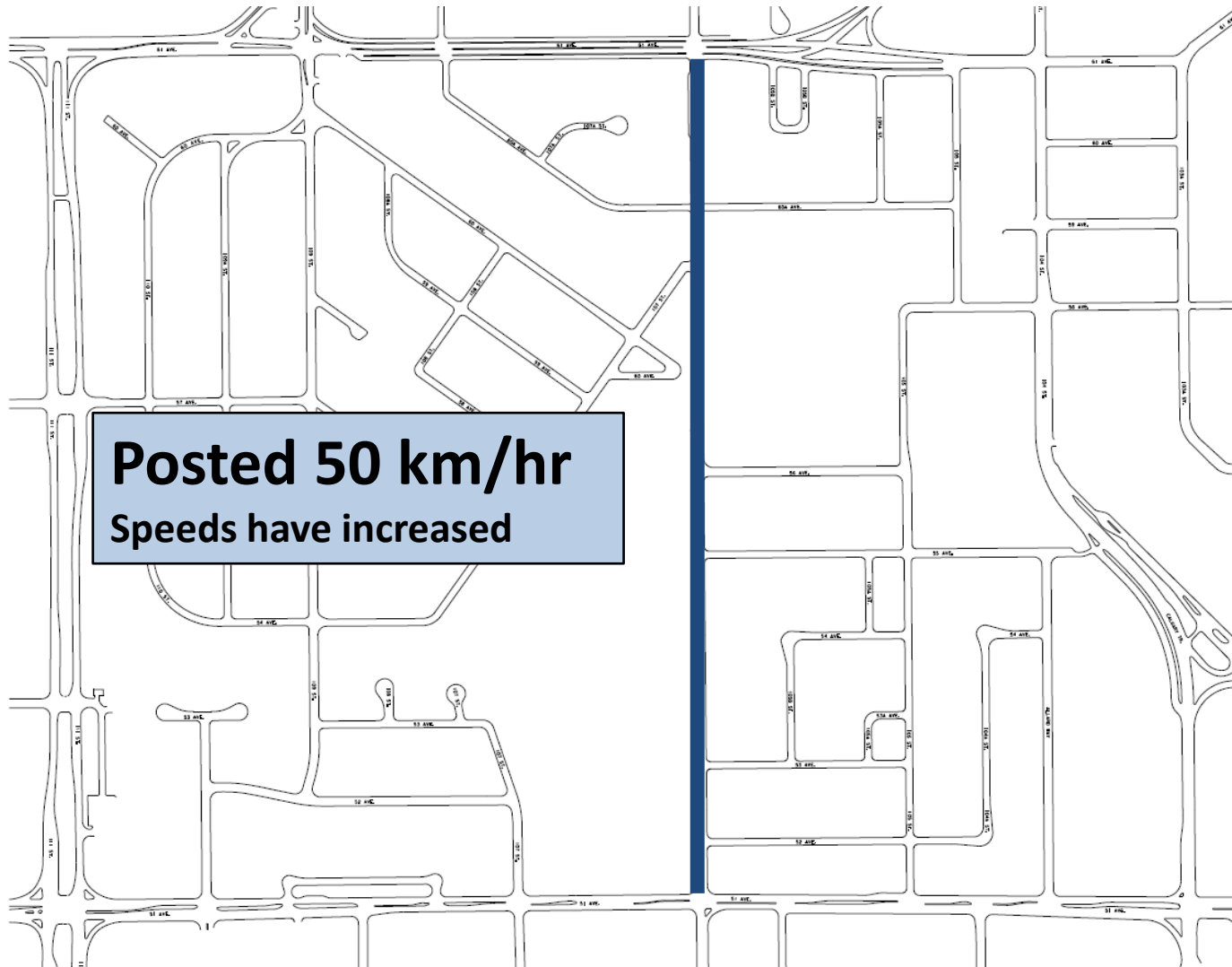

Pleasantview Speed Monitoring – 56 Avenue

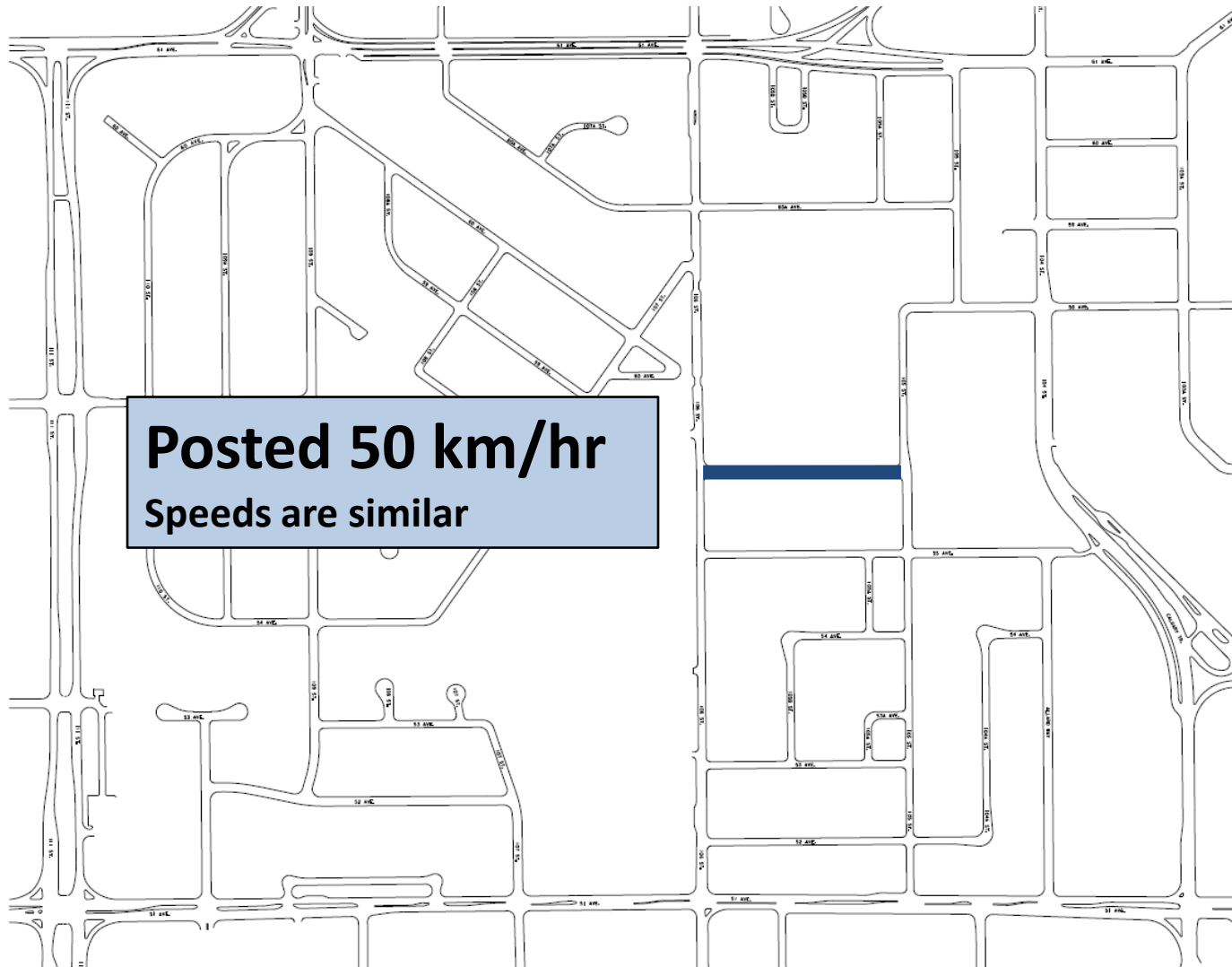

Pleasantview Speed Monitoring – 105 Street

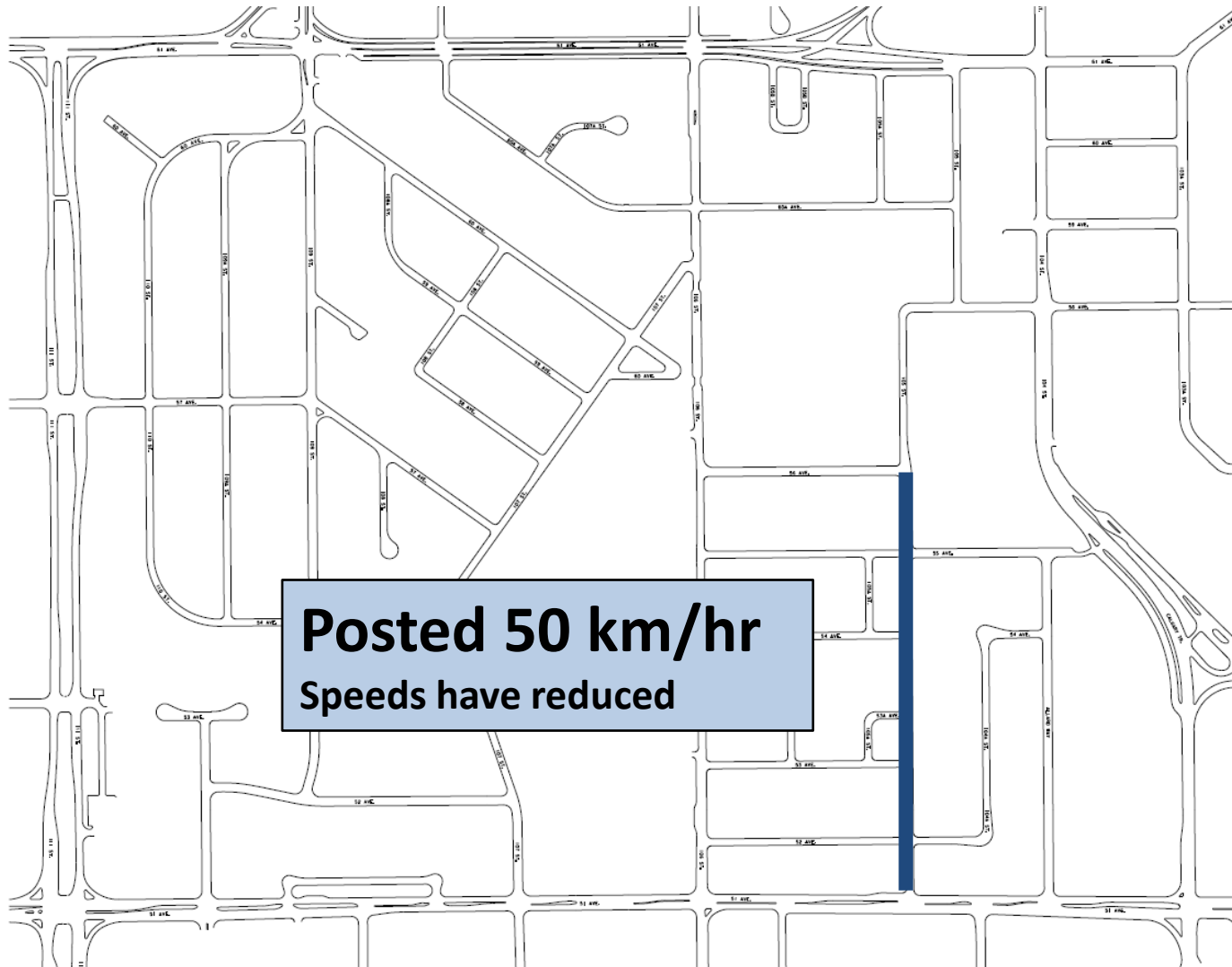

Pleasantview Traffic Monitoring - Summary

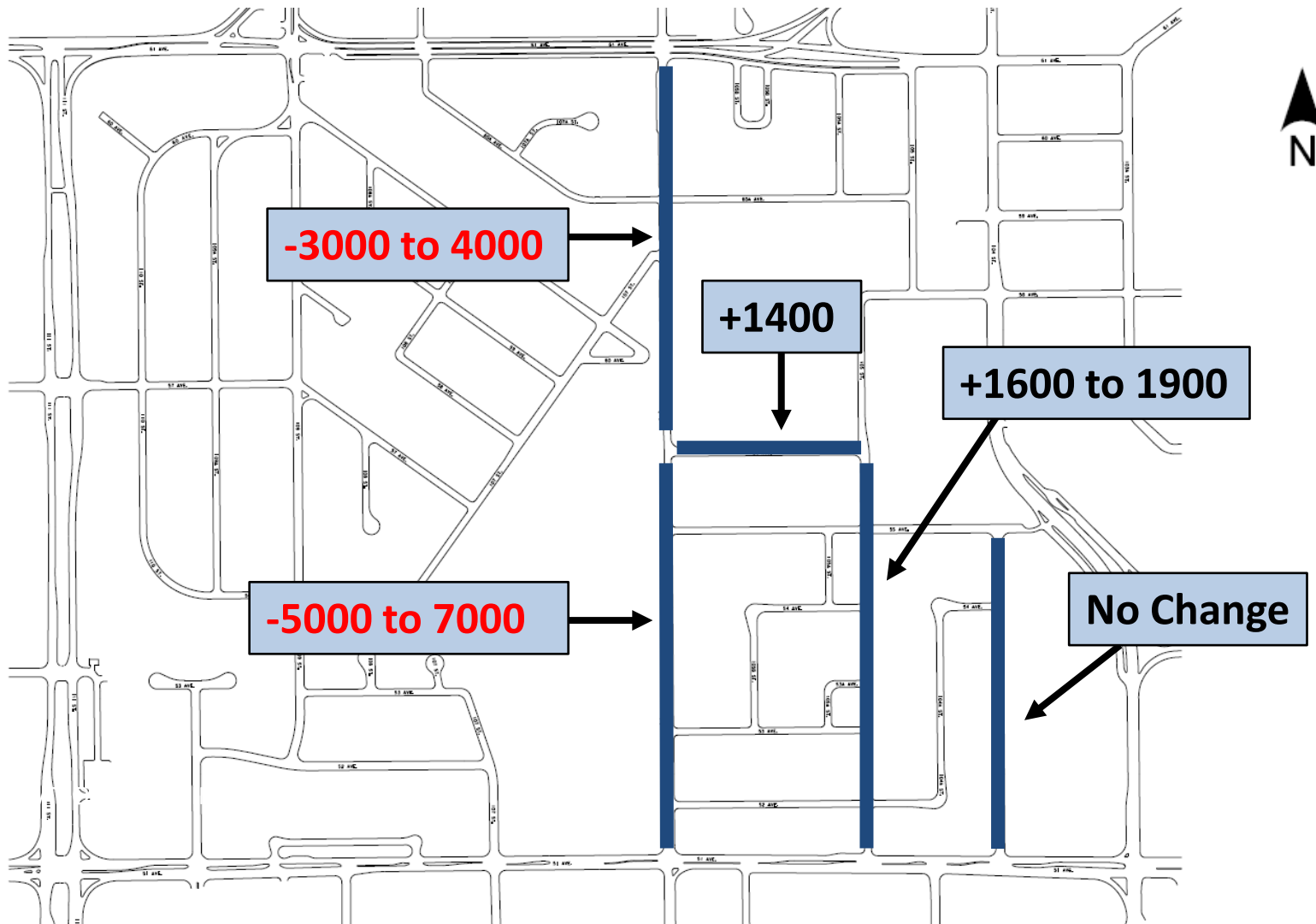



Gathering Input Process

- Structured so all have equal opportunity to provide input
- Hear/record both issues and solutions
- Requires reflective work
 - Write and post responses

Questions



1. What has your experience been with the trial measures?

- What has worked well?*
- Have there been issues?*

2. What solutions would you suggest to address issues?

Closure

- Evaluation
- www.edmonton.ca/pleasantviewtraffic
- January/February – Next Workshop



An aerial photograph of a city street scene, featuring a row of colorful townhouses on the left, a multi-lane road with cars and a bus in the center, and a park-like area with trees and a playground on the right. The entire image is covered with a semi-transparent blue overlay.

Transportation Services

Thank you.