



THE WAY WE MOVE

GUARDIAN ROAD / LEWIS ESTATES
BOULEVARD WIDENING
GRANTHAM DRIVE TO POTTER GREENS DRIVE

TRANSFORMING | **EDMONTON**

BRINGING OUR CITY VISION TO LIFE



WELCOME

Today we are introducing the concept planning project for the widening of Guardian Road/Lewis Estates Boulevard from Grantham Drive to Potter Greens Drive

PURPOSE

- To provide background information on the widening project
- To gather input from you about existing issues, opportunities and risks

Representatives from the City of Edmonton are available to discuss the project and answer questions

PROJECT VISION

- To develop Concept Plans for a four lane urban arterial roadway which balances the needs of area businesses and residents with the long term transportation needs of the City.

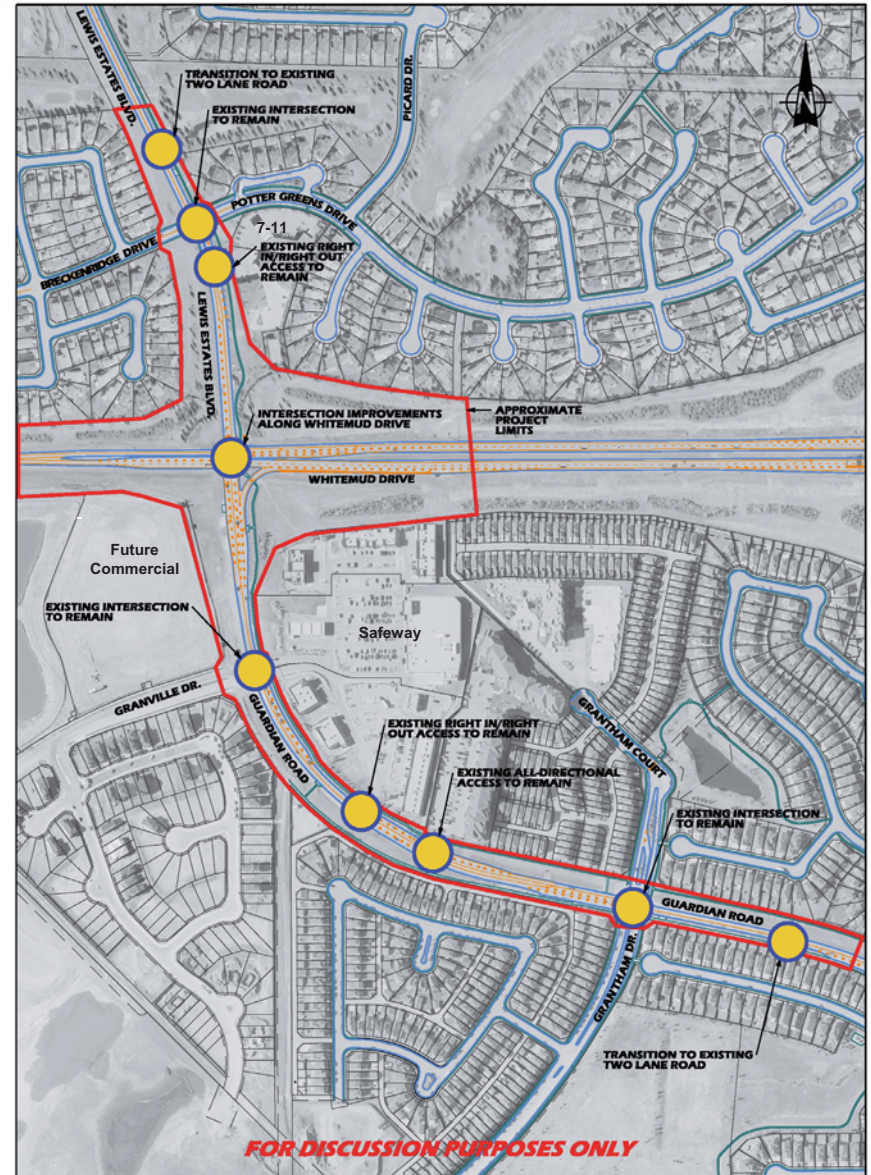

PROJECT PROCESS



GUARDIAN ROAD/LEWIS ESTATES BOULEVARD WIDENING

PROJECT SCOPE

- Study corridor extends from Grantham Drive in the south to Potter Greens Drive in the north – approximately 1.0 km.
- The project will include:
 - Widening of Guardian Road/Lewis Estates Boulevard to a 4 lane urban arterial with turn lanes
 - Transitions to existing two lane roadways north of Potter Greens Drive and south/east of Grantham Drive
 - Improvements at the Whitemud Drive intersection

PROJECT SCOPE

- Construction of sidewalk and trail connections along the corridor
- Retention of existing access and intersection locations and configurations, with the addition of turn lanes where needed
- Relocation and consolidation of bus stops
- Additional property will not be required for the widening

BRINGING OUR CITY VISION TO LIFE

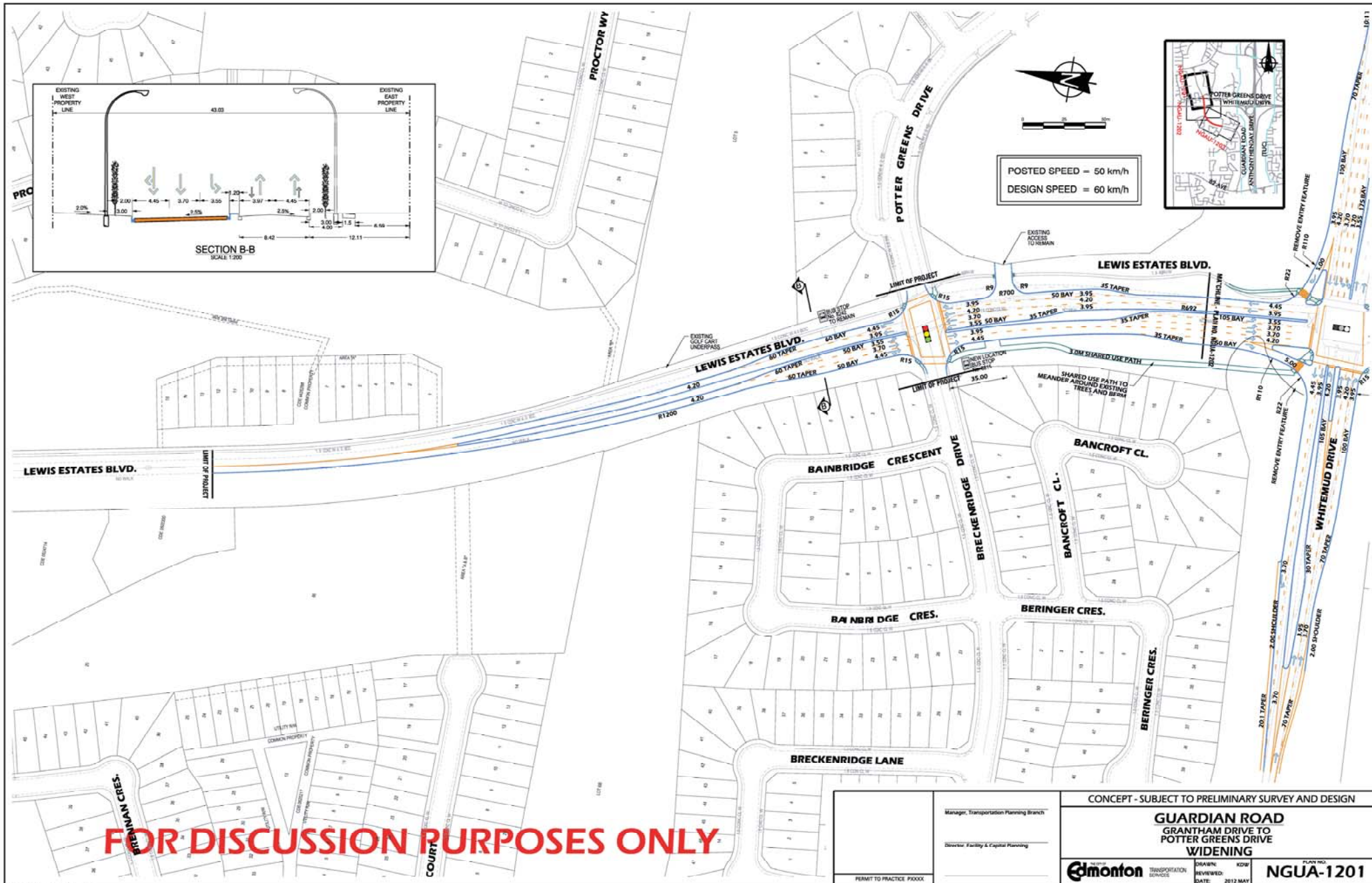

TRANSFORMING | EDMONTON

BRINGING OUR CITY VISION TO LIFE

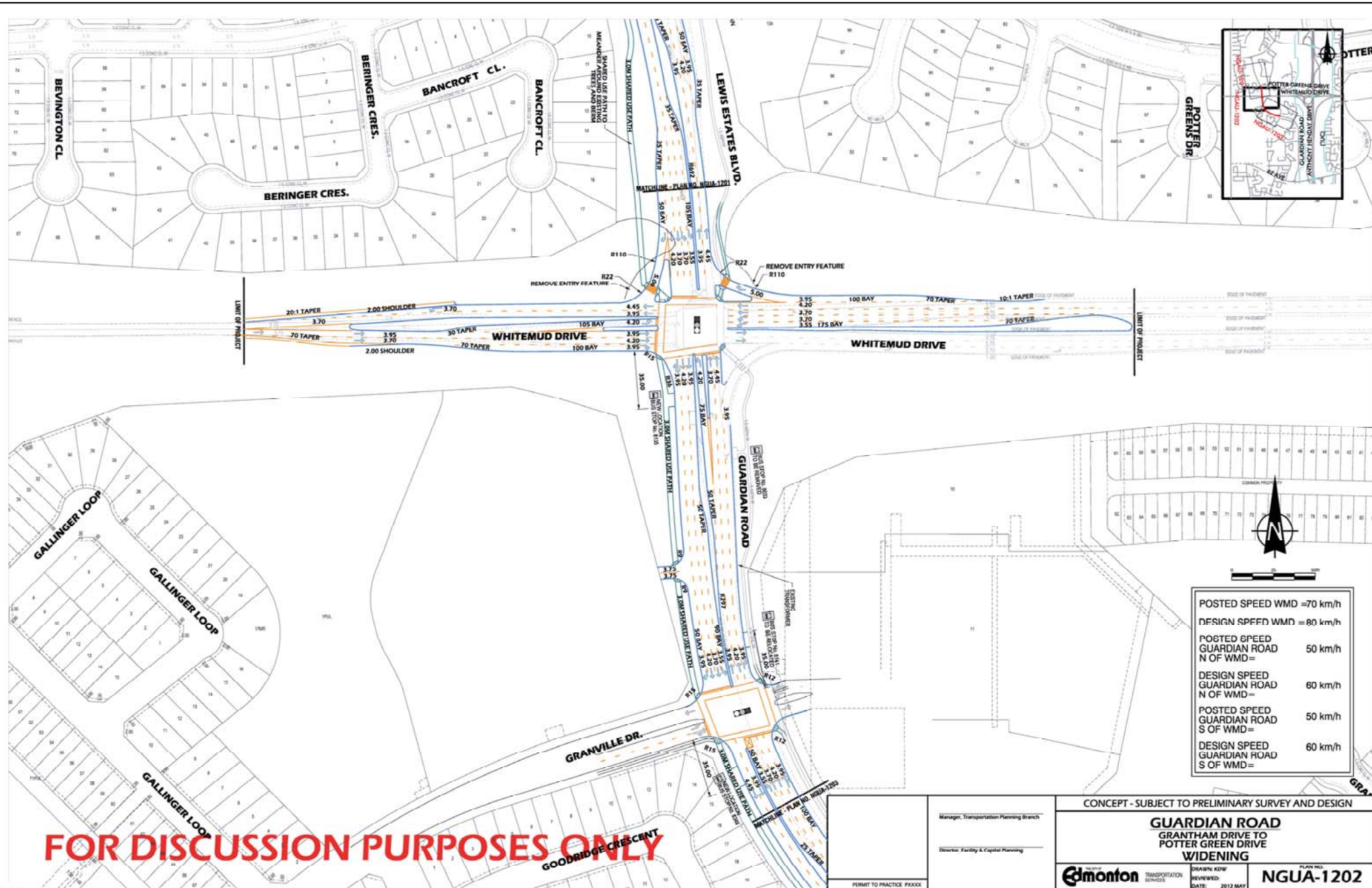

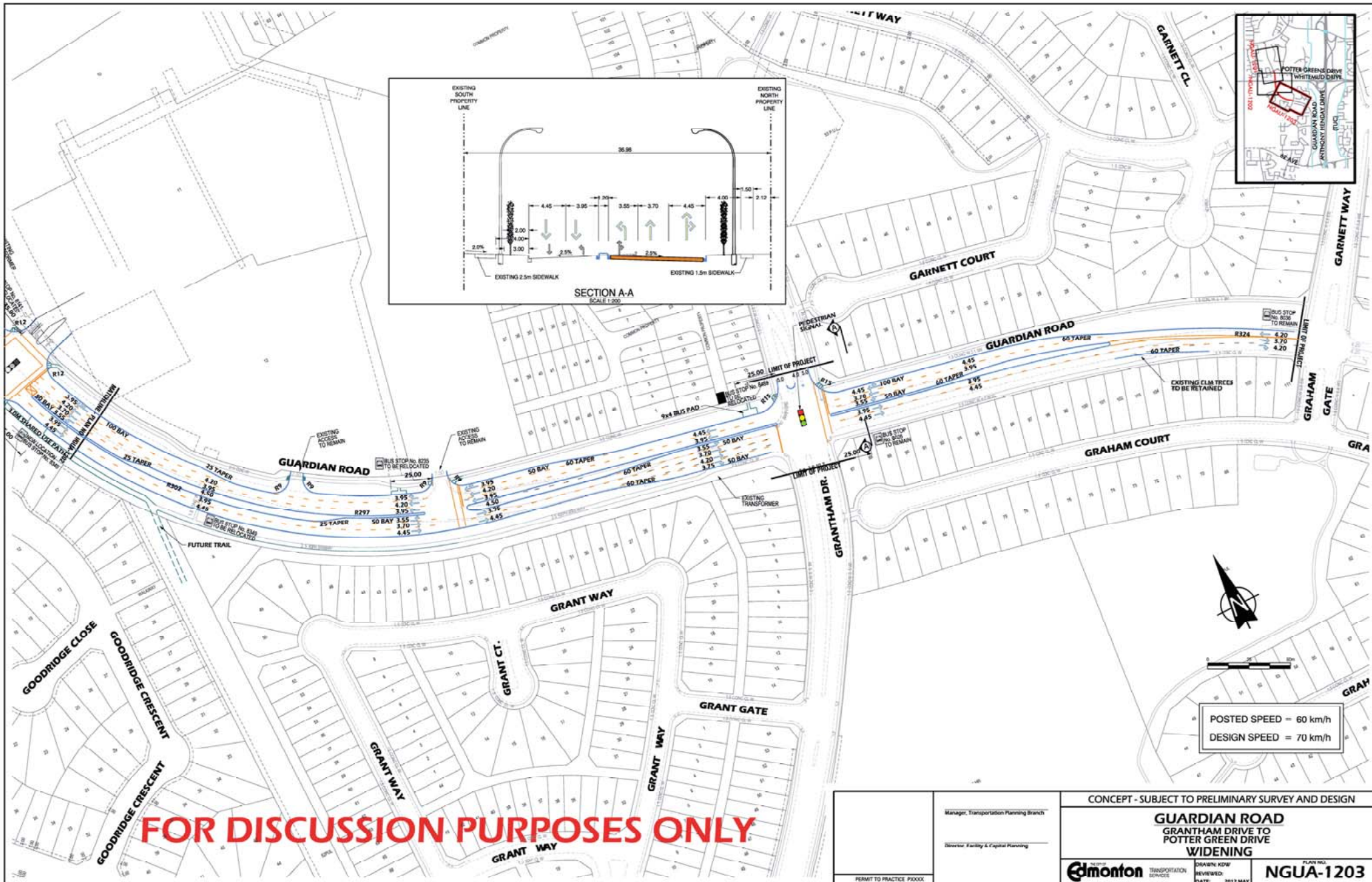

NEXT STEPS

- Completion of concept plans – summer 2012
- Preliminary and detailed design, with second Open House – fall 2012 to spring 2013
- Construction – scheduled to start in 2013



Thank you!

Please fill out the comment form.



GUARDIAN ROAD/LEWIS ESTATES BOULEVARD WIDENING