

# CENTRAL LRT STATION REHABILITATION & JASPER AVENUE (100 ST TO 102 ST) STREETSCAPING

## CENTRAL LRT STATION STRUCTURAL DETAILS

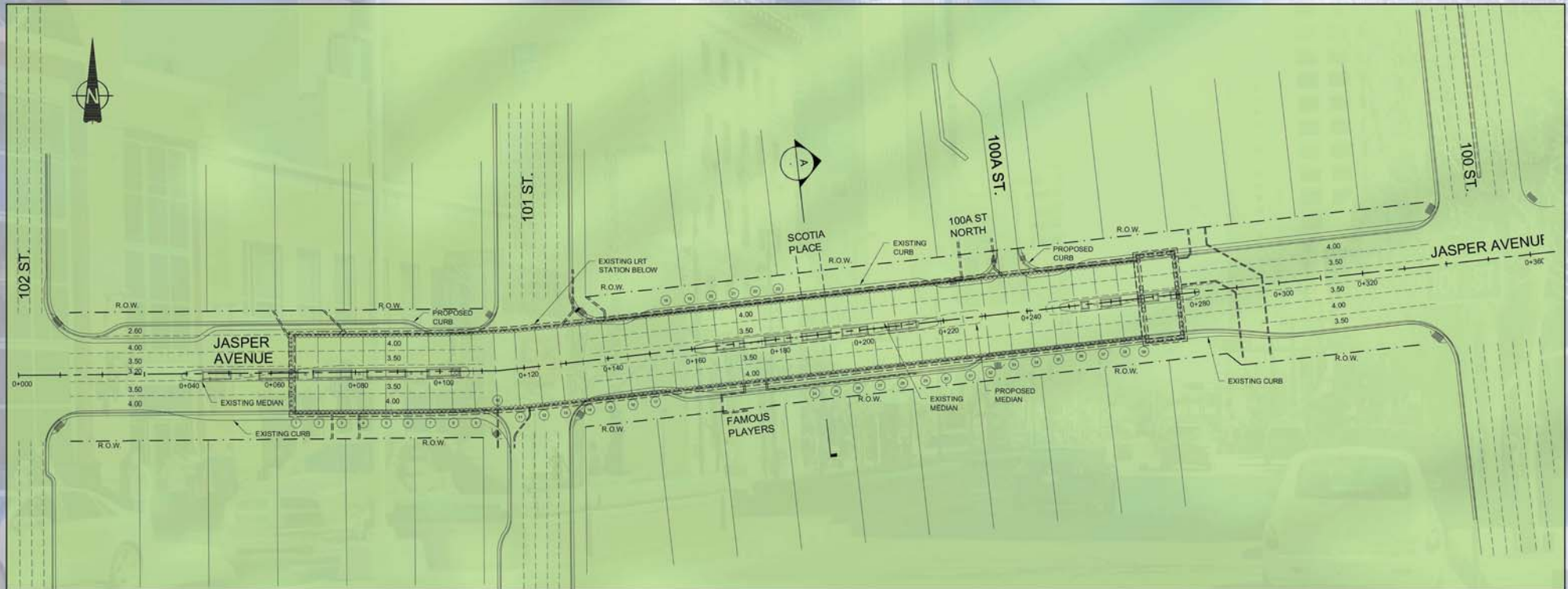

### STRUCTURAL WORK

- Concrete road surface will be replaced
- Central LRT roof structure will be waterproofed
- Damage to structural elements due to leakage will be repaired

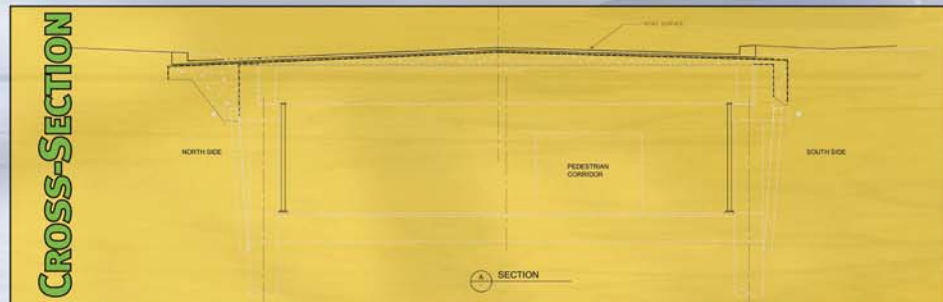



- Existing kiosks will be removed
- Existing medians/planter boxes will be removed
- Jasper Avenue concrete roadway will be replaced
- Jasper Avenue will include two lanes each direction during peak hours and one lane each direction and parking during off-peak periods
- Intersection at Jasper Avenue/100A Street (Rice Howard Way) will include a "scramble" crosswalk
- 101 Street asphalt roadway will be rehabilitated (to alleys immediately north and south of Jasper Avenue)

<h1>LEGEND</h1>	
	1. Name of Affiliate 2. City, State, and Zip 3. Phone Number (Area Code) (Country Code) 4. Fax Number (Country Code)
	NEW SHOW 1. Name of Show 2. City, State, and Zip 3. Phone Number (Area Code) (Country Code) 4. Fax Number (Country Code)
	1. Name of Region 2. City, State, and Zip 3. Phone Number (Area Code) (Country Code) 4. Fax Number (Country Code)
	NEW SHOW 1. Name of Show 2. City, State, and Zip 3. Phone Number (Area Code) (Country Code) 4. Fax Number (Country Code)

## CROSS-SECTIONS

The image displays two cross-sections of a bridge deck. The left section, labeled 'NORTH SIDE', shows a cross-section with a central span and two side spans. The right section, labeled 'SOUTHER SIDE', shows a similar cross-section. Both diagrams include dimensions and labels for various components like 'ROADWAY', 'SIDEWALK', and 'CURB'.