



## CENTRAL STATION LRT REHABILITATION & JASPER AVENUE (100 ST TO 102 ST) STREETSCAPING JASPER AVENUE STREETSCAPE PERSPECTIVES



This project includes road and streetscape construction within the existing right of way. Building facades in the above images are illustrative only.



# CENTRAL STATION LRT REHABILITATION & JASPER AVENUE (100 ST TO 102 ST) STREETSCAPING

## JASPER AVENUE STREETSCAPE PLAN

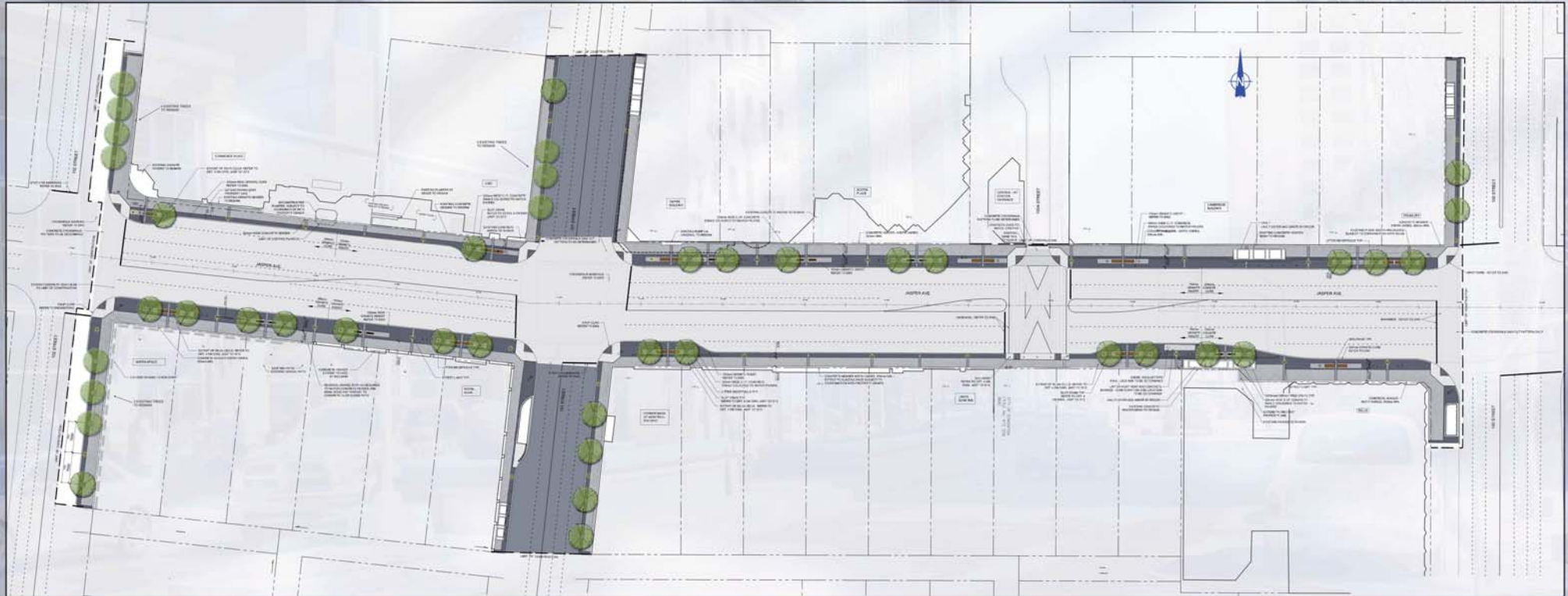

### LEGEND

	CUSTOM TREE GRATE 1200mm x 1200mm UNLESS NOTED		BOULEVARD TREES IN SOIL CELL STRUCTURE
	300x300mm LARGE FORMAT PAVER BAND COLOUR TO BE ICE GREY		STANDARD BENCH
	300x300mm LARGE FORMAT PAVERS COLOUR TO BE WATER MARBLE RUNNING LONG PATTERN		LITTER RECEPTACLE
	300x300mm LARGE FORMAT PAVER BAND COLOUR TO BE MONTAGNY RUNNING LONG PATTERN		BIKE RACK
	300x300mm LARGE FORMAT PAVER BAND COLOUR TO BE BLACK GRANITE		STREET LIGHT
	CROSSWALK PATTERNING		PROPOSED SIGNAL POLE ON MODIFIED EXISTING CONCRETE BASE
	GRANITE FEATURE BENCH AND PLANTER		PROPERTY LINE

NOTE: ALL DIMENSIONS IN MILLIMETRES UNLESS OTHERWISE NOTED

### NOTES

- 49 existing trees will be removed from Jasper Avenue, including those in the median planters
- Existing trees on the side streets will be kept as shown
- 31 new trees will be planted in new buried soil cells as shown on the plans

# CENTRAL STATION LRT REHABILITATION & JASPER AVENUE (100 ST TO 102 ST) STREETSCAPING

## JASPER AVENUE STREETSCAPE DETAILS

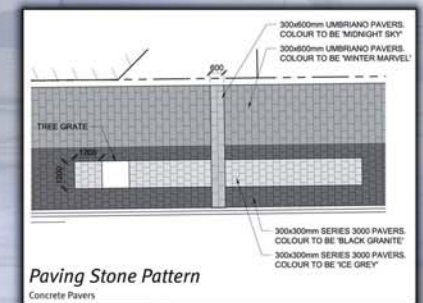
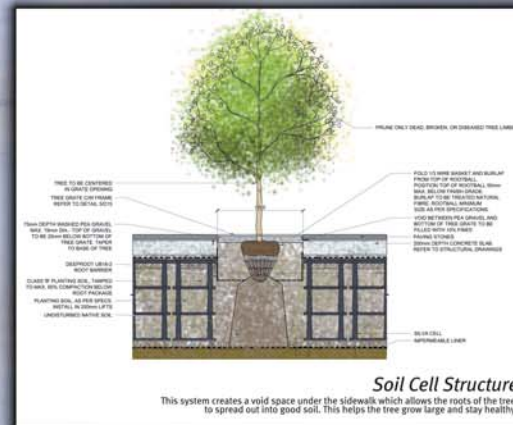
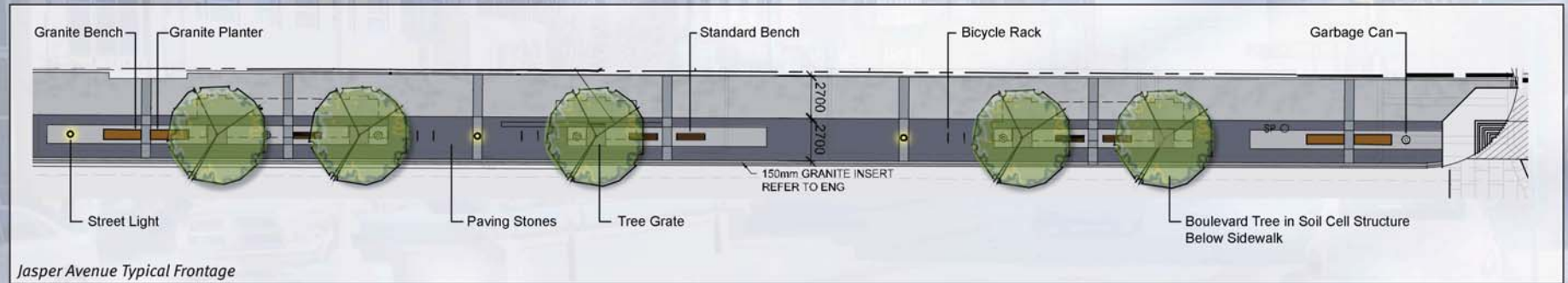
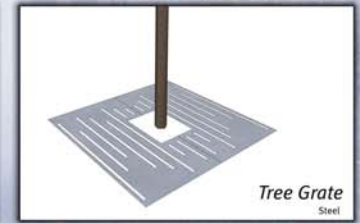

# CENTRAL STATION LRT REHABILITATION & JASPER AVENUE (100 ST TO 102 ST) STREETSCAPING

## JASPER AVENUE ROADWAY DETAILS

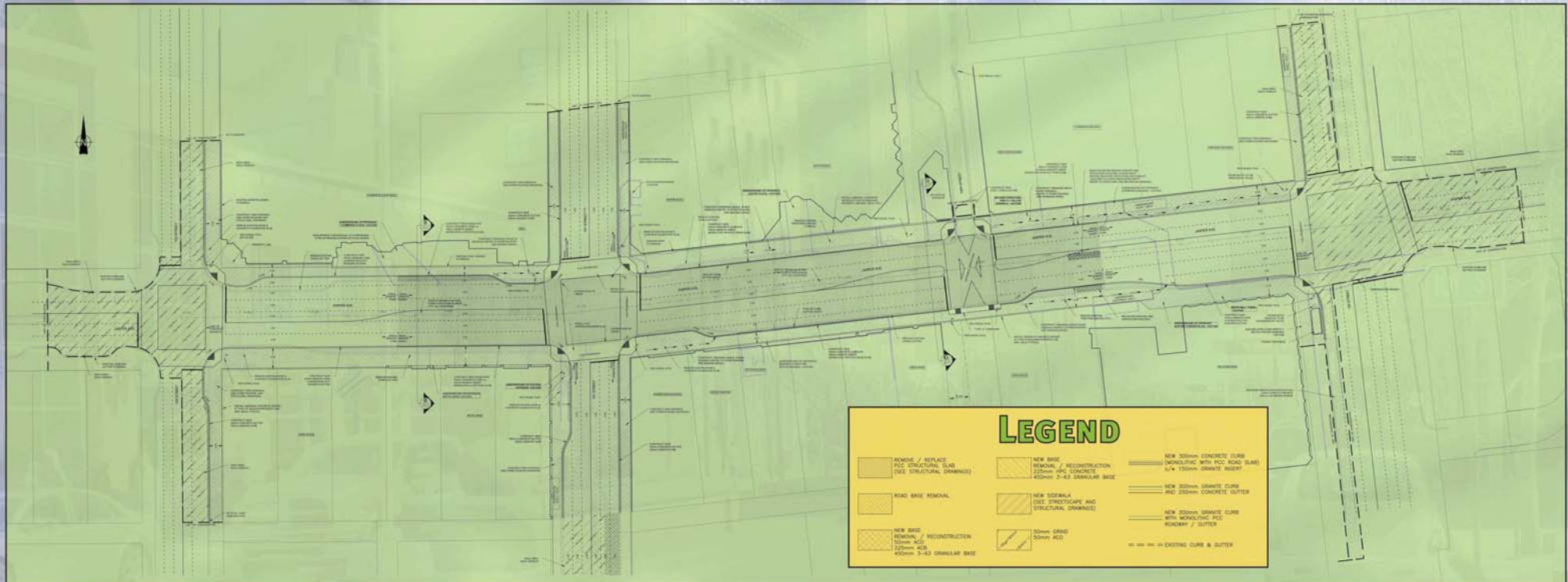

### ROADWAY WORK

- Existing kiosks will be removed
- Existing medians/planter boxes will be removed
- Jasper Avenue concrete roadway will be replaced
- Jasper Avenue will include two lanes each direction during peak hours and one lane each direction and parking during off-peak periods
- Intersection at Jasper Avenue/100A Street (Rice Howard Way) will include a "scramble" crosswalk
- 101 Street asphalt roadway will be rehabilitated (to alleys immediately north and south of Jasper Avenue)

### CROSS-SECTIONS

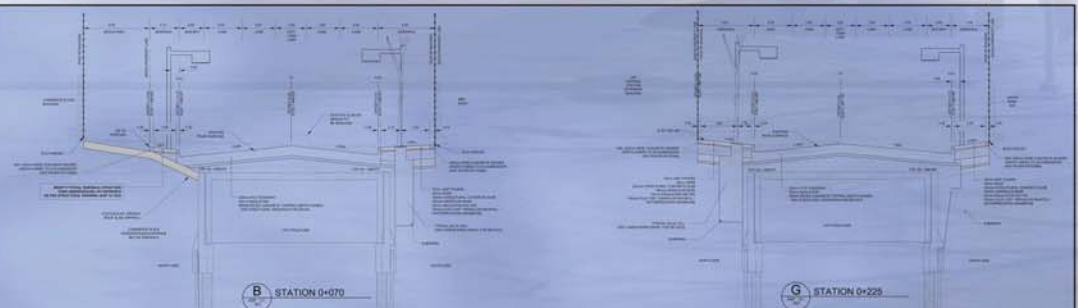

# CENTRAL STATION LRT REHABILITATION & JASPER AVENUE (100 ST TO 102 ST) STREETSCAPING

## CENTRAL LRT STATION STRUCTURAL DETAILS

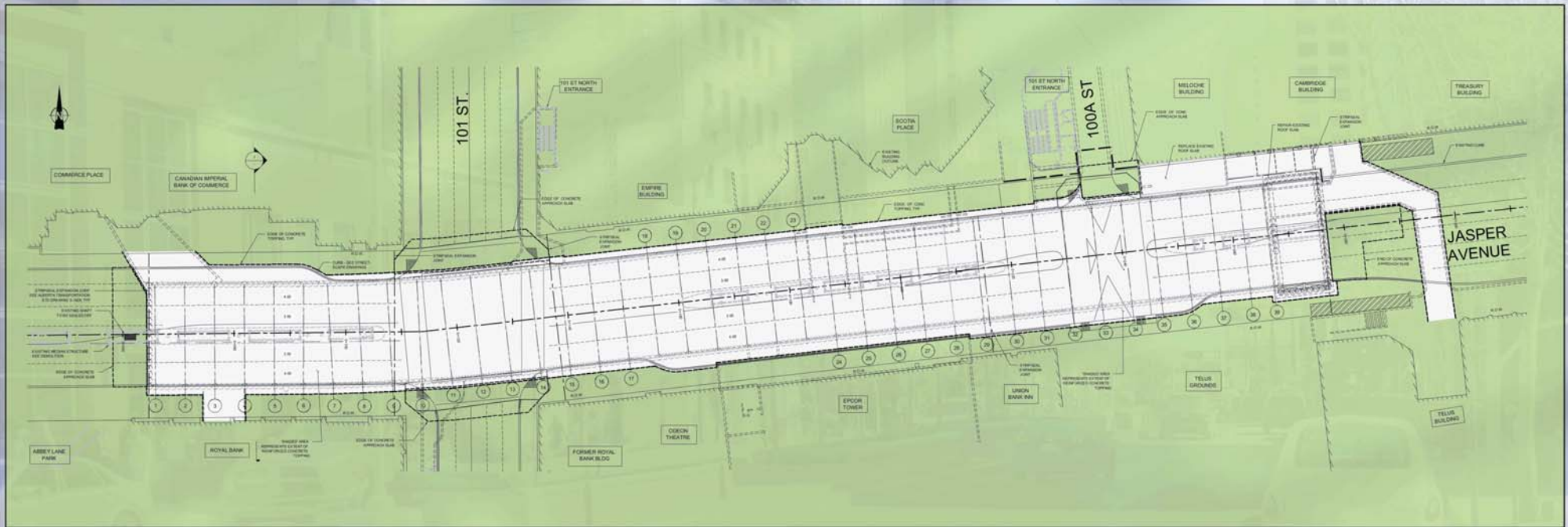

### STRUCTURAL WORK

- Concrete road surface will be replaced
- Central LRT roof structure will be waterproofed
- Damage to structural elements due to leakage will be repaired

