



MATCHLINE - PLAN NO. S-127-1502

STONY PLAIN RD.

INSTALL RB-92 SIGN

MOUNTABLE CURB AND ISLAND

INSTALL WA-801R SIGN

1.5 CONC W 0.9 EW

127 ST

1.5 CONC W 1.4 WE

INSTALL RB-91 SIGN
AND WA-801R SIGN

105 AVE

INSTALL WA-801R SIGN

FINAL DESIGN TO
BE DETERMINED

FINAL DESIGN TO
BE DETERMINED

NOTES:

ALL PAVEMENT MARKINGS TO BE MEASURED FROM CURB FACE OR AS OTHERWISE NOTED



PERMIT TO PRACTICE P 05038

Manager, Transportation Planning Branch
Manager, Transportation Operations Branch
Director, Sustainable Transportation
Director, Traffic Engineering

CONCEPT PLAN - SUBJECT TO PRELIMINARY DESIGN

**TWO-WAY CYCLE TRACK AND
CURB EXTENSIONS**
127 STREET, STONY PLAIN ROAD TO 118 AVENUE

Edmonton TRANSPORTATION
SERVICES

DATE: FEB 2015
SCALE: 1:500

PLAN NO.
S-127-1501



MATCHLINE - PLAN No. S-127-1501

MATCHLINE - PLAN No. S-127-1503

FINAL DESIGN TO
BE DETERMINED

FINAL DESIGN TO
BE DETERMINED

INSTALL RB-91 SIGN

MOUNTABLE CURB AND ISLAND

INSTALL STOP SIGN

1.5 CONC W 0.9 EW

1.5m
1.5m
3.0m
2.5m

1.5m
1.5m
3.0m
2.5m

1.5m
1.5m
3.0m
2.5m

127 ST

1.5 CONC W 1.5 WE

NEW CURB EXTENSION

NEW CURB EXTENSION

INSTALL WA-801R SIGN

INSTALL RB-91 SIGN
AND WA-801R SIGN

106 AVE

NOTES:
ALL PAVEMENT MARKINGS TO BE MEASURED FROM CURB FACE OR AS OTHERWISE NOTED



Manager, Transportation Planning Branch

Manager, Transportation Operations Branch

Director, Sustainable Transportation

Director, Traffic Engineering

CONCEPT PLAN - SUBJECT TO PRELIMINARY DESIGN			
PROJECT: TWO-WAY CYCLE TRACK AND CURB EXTENSIONS			
127 STREET, STONY PLAIN ROAD TO 118 AVENUE			
	TRANSPORTATION SERVICES	DATE: FEB 2015 SCALE: 1:500	PLAN NO.: S-127-1502

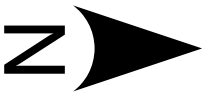

MATCHLINE - PLAN NO. S-127-1504

MATCHLINE - PLAN NO. S-127-1502

INSTALL
RB-91 SIGN

INSTALL IB-23 SIGN
WITH IS-7 TAB

MOUNTABLE CURB AND ISLAND

INSTALL
RB-91 SIGN

1.5 CONC W 0.6 FW

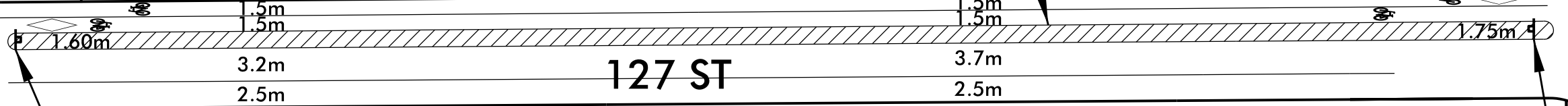
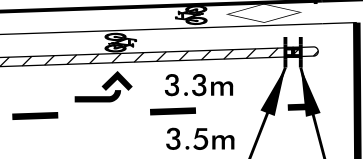

127 ST

INSTALL WA-801R SIGN

INSTALL RB-91 SIGN
AND WA-801R SIGN

INSTALL
WA-801R SIGN

107 AVE

INSTALL IB-23 SIGN
WITH IS-7 TAB

NOTES:

ALL PAVEMENT MARKINGS TO BE MEASURED FROM CURB FACE OR AS OTHERWISE NOTED

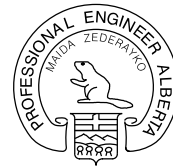

PERMIT TO PRACTICE P 05038

Manager, Transportation Planning Branch
Manager, Transportation Operations Branch
Director, Sustainable Transportation
Director, Traffic Engineering

CONCEPT PLAN - SUBJECT TO PRELIMINARY DESIGN

PROJECT: **TWO-WAY CYCLE TRACK AND
CURB EXTENSIONS**
127 STREET, STONY PLAIN ROAD TO 118 AVENUE

Edmonton TRANSPORTATION
SERVICES

DGN BY: TF
DATE: FEB 2015
SCALE: 1:500

PLAN NO.
S-127-1503

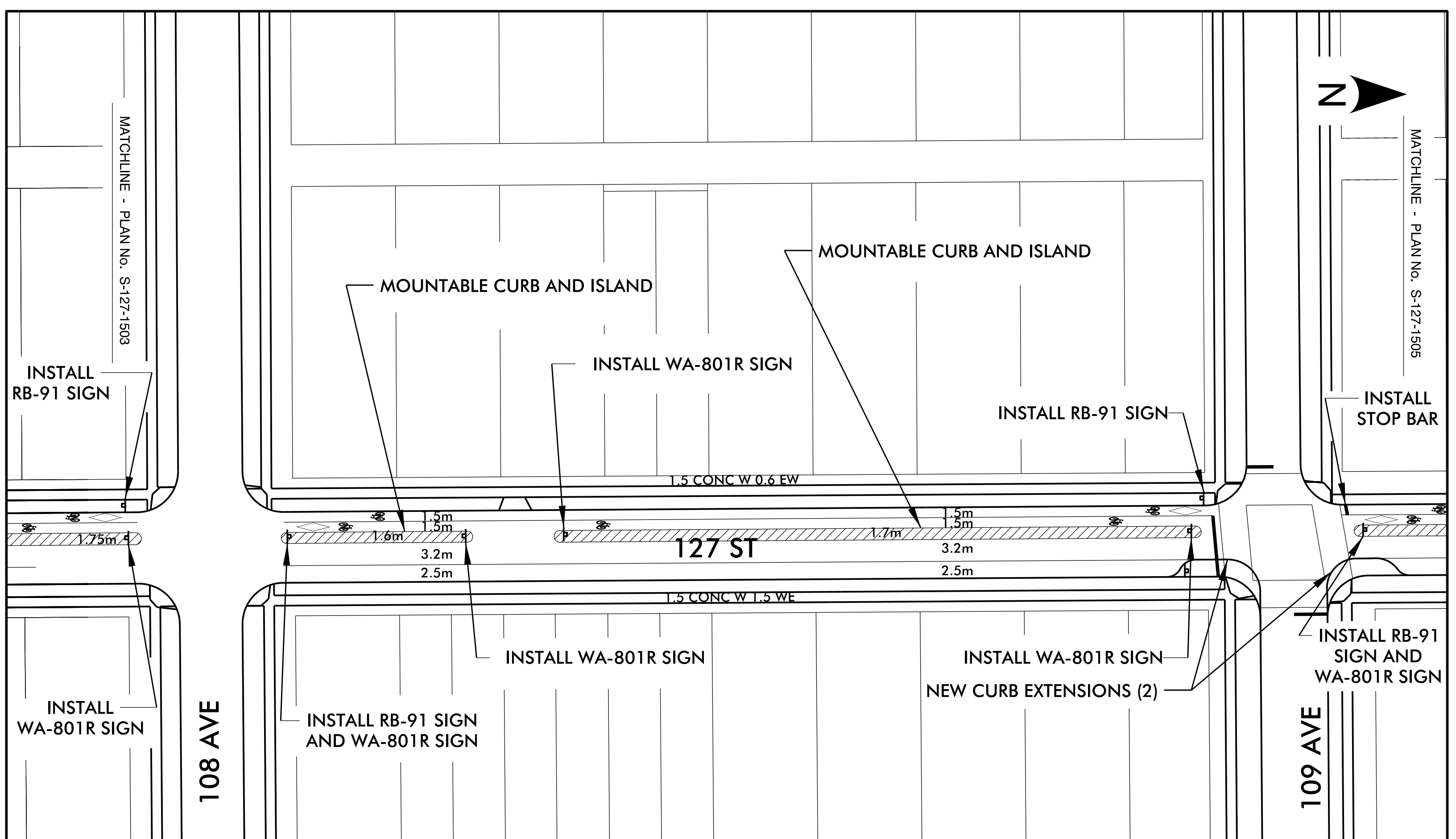

NOTES:
ALL PAVEMENT MARKINGS TO BE MEASURED FROM CURB FACE OR AS OTHERWISE NOTED

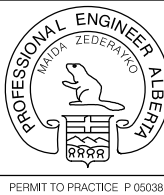

Manager, Transportation Planning Branch
Manager, Transportation Operations Branch
Director, Sustainable Transportation
Director, Traffic Engineering

CONCEPT PLAN - SUBJECT TO PRELIMINARY DESIGN

PROJECT: **TWO-WAY CYCLE TRACK AND CURB EXTENSIONS**
127 STREET, STONY PLAIN ROAD TO 118 AVENUE

Edmonton

TRANSPORTATION SERVICES

SCALE: 1:500

DATE: FEB 2015

PLAN NO.: **S-127-1504**

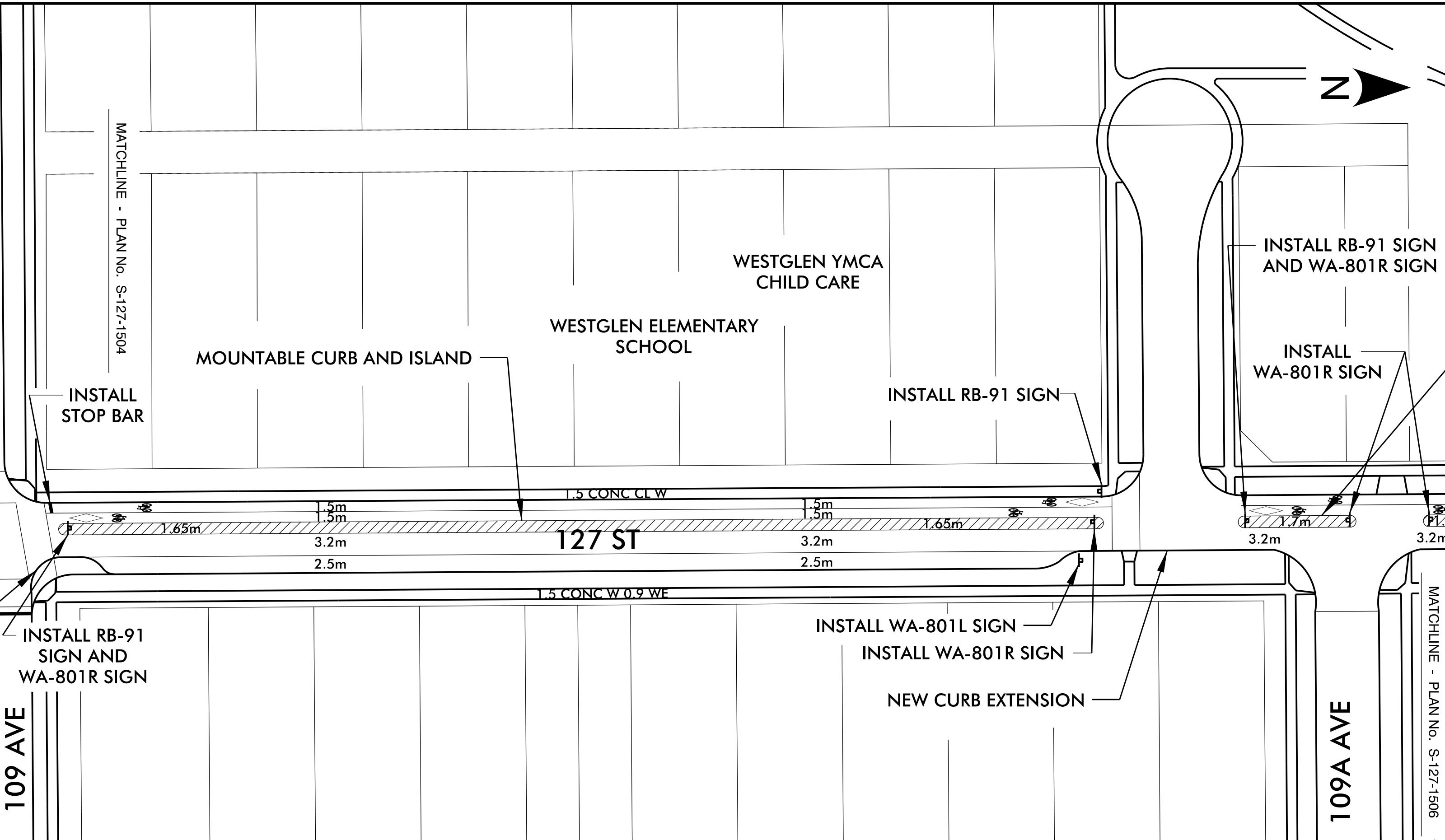

NOTES:
ALL PAVEMENT MARKINGS TO BE MEASURED FROM CURB FACE OR AS OTHERWISE NOTED

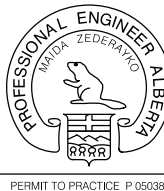

Manager, Transportation Planning Branch

Manager, Transportation Operations Branch

Director, Sustainable Transportation

Director, Traffic Engineering

CONCEPT PLAN - SUBJECT TO PRELIMINARY DESIGN		
PROJECT: TWO-WAY CYCLE TRACK AND CURB EXTENSIONS		
127 STREET, STONY PLAIN ROAD TO 118 AVENUE		
	DATE: FEB 2015 SCALE: 1:500	PLAN NO.: S-127-1505

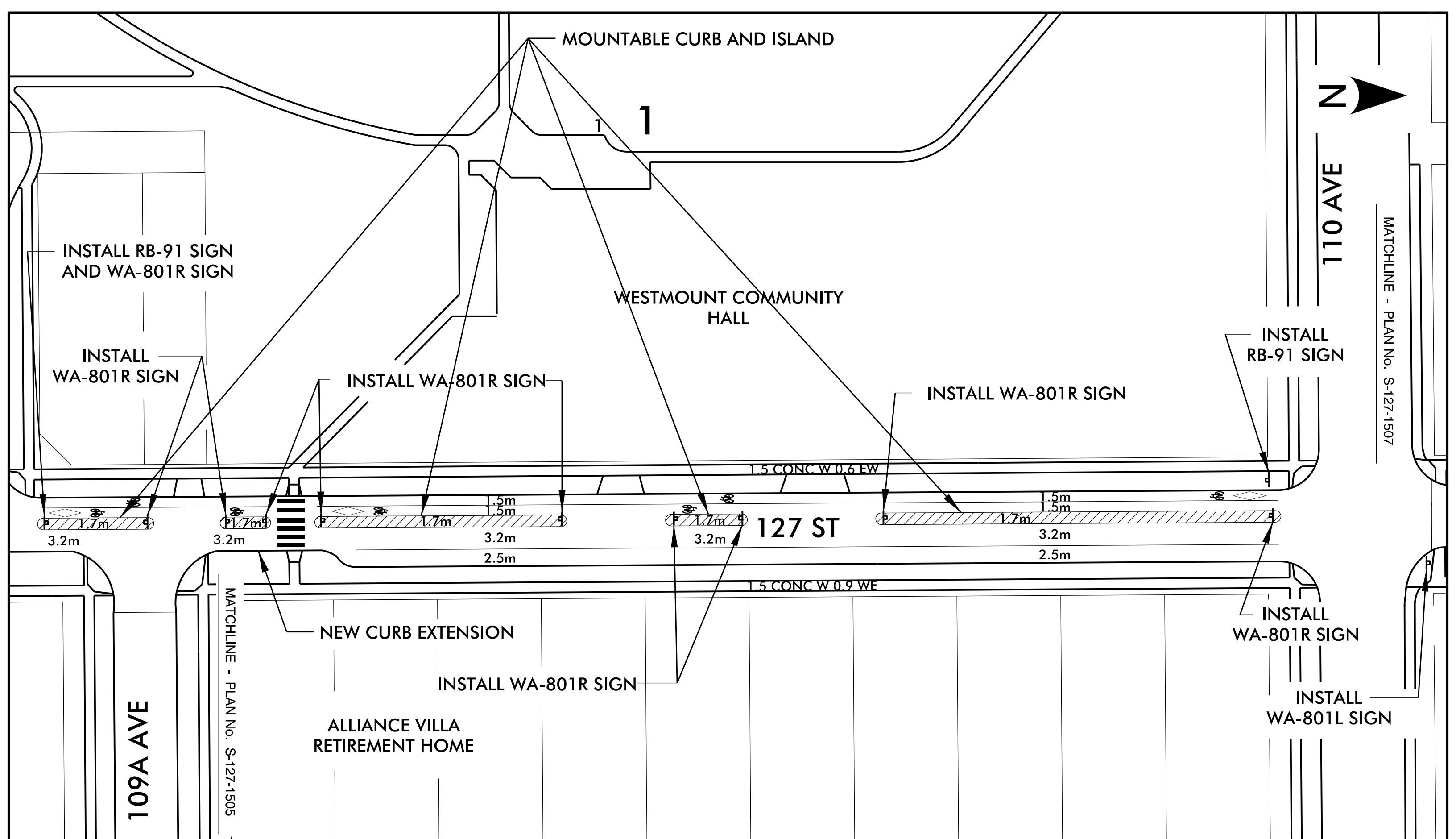

NOTES:
ALL PAVEMENT MARKINGS TO BE MEASURED FROM CURB FACE OR AS OTHERWISE NOTED



PERMIT TO PRACTICE: P 05038

Manager, Transportation Planning Branch
Manager, Transportation Operations Branch
Director, Sustainable Transportation
Director, Traffic Engineering

CONCEPT PLAN - SUBJECT TO PRELIMINARY DESIGN

PROJECT: **TWO-WAY CYCLE TRACK AND CURB EXTENSIONS**

127 STREET, STONY PLAIN ROAD TO 118 AVENUE

 **Edmonton** TRANSPORTATION SERVICES

DATE: FEB 2015
SCALE: 1:500

PLAN NO.: **S-127-1506**

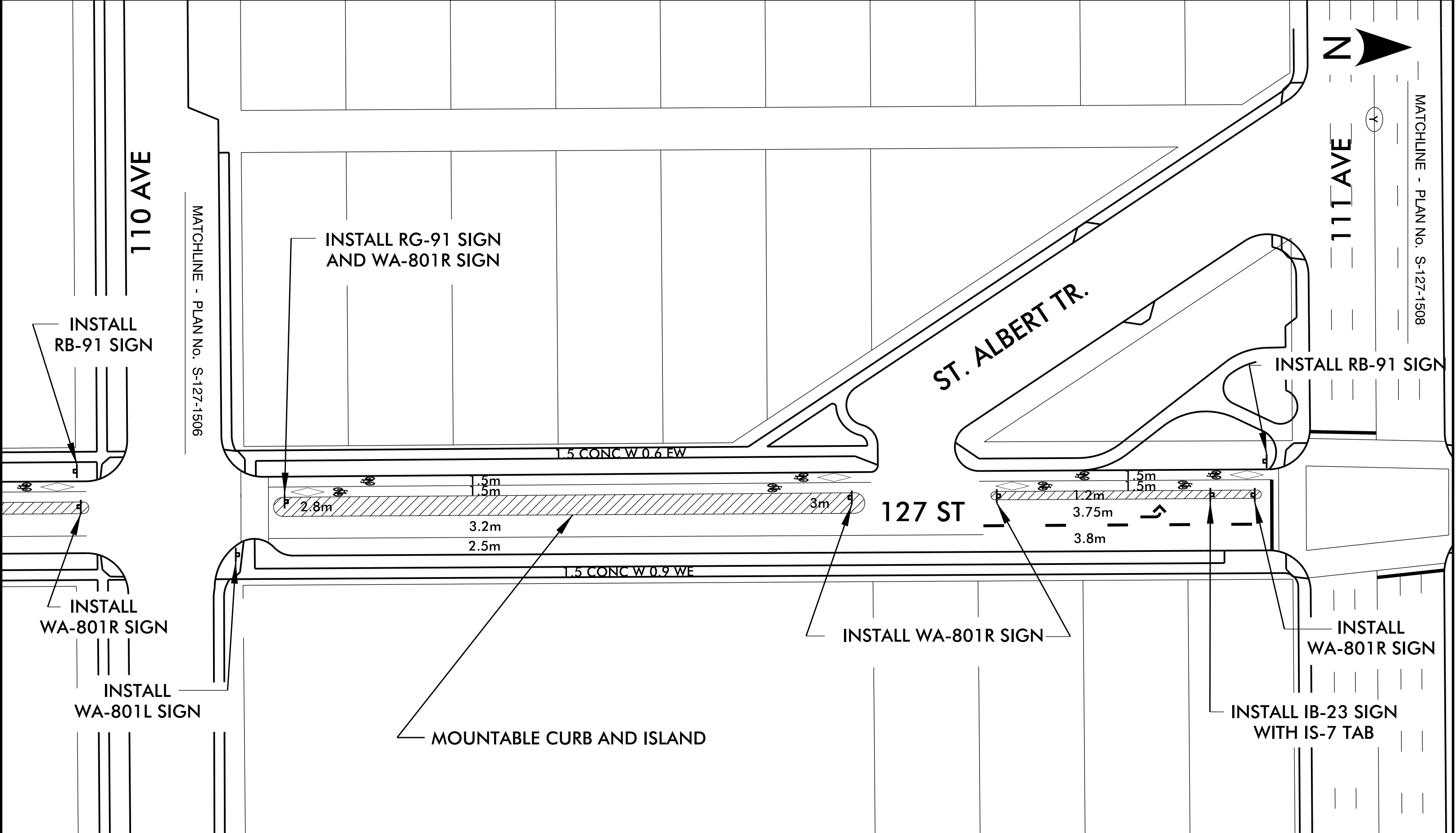

NOTES:

ALL PAVEMENT MARKINGS TO BE MEASURED FROM CURB FACE OR AS OTHERWISE NOTED



PERMIT TO PRACTICE: P 05038

Manager, Transportation Planning Branch

Manager, Transportation Operations Branch

Director, Sustainable Transportation

Director, Traffic Engineering

CONCEPT PLAN - SUBJECT TO PRELIMINARY DESIGN

PROJECT: **TWO-WAY CYCLE TRACK AND CURB EXTENSIONS**

127 STREET, STONY PLAIN ROAD TO 118 AVENUE



TRANSPORTATION SERVICES

CDL BY: TF

DATE: FEB 2015

SCALE: 1:500

PLAN NO.

S-127-1507

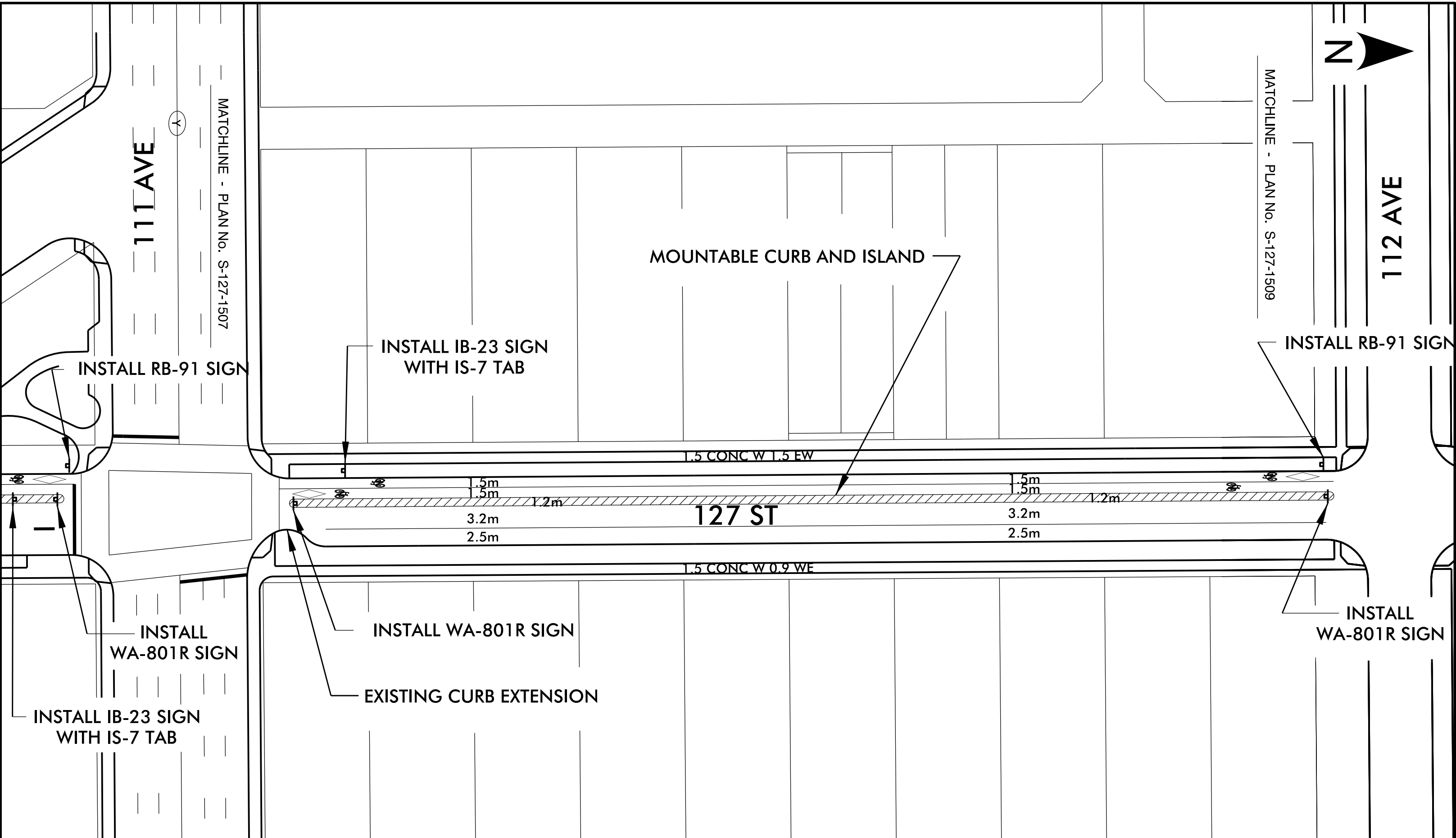

NOTES:

ALL PAVEMENT MARKINGS TO BE MEASURED FROM CURB FACE OR AS OTHERWISE NOTED



PERMIT TO PRACTICE P 05038

Manager, Transportation Planning Branch

Manager, Transportation Operations Branch

Director, Sustainable Transportation

Director, Traffic Engineering

CONCEPT PLAN - SUBJECT TO PRELIMINARY DESIGN

PROJECT: **TWO-WAY CYCLE TRACK AND CURB EXTENSIONS**

127 STREET, STONY PLAIN ROAD TO 118 AVENUE



TRANSPORTATION SERVICES

DESIGNED BY: TF

DRAWN BY: FEB 2015

SCALE: 1:500

PLAN NO.

S-127-1508



MATCHLINE - PLAN No. S-127-1510

113 AVE

INSTALL RB-91 SIGN

INSTALL WA-801R SIGN

MOUNTABLE CURB AND ISLAND

1.5 CONC W 1.5 EW

1.5 CONC W 0.9 WE

127 ST

112 AVE

MATCHLINE - PLAN No. S-127-1508

INSTALL RB-91 SIGN

INSTALL
WA-801R SIGN

INSTALL RB-91 SIGN
AND WA-801R SIGN

NOTES:

ALL PAVEMENT MARKINGS TO BE MEASURED FROM CURB FACE OR AS OTHERWISE NOTED

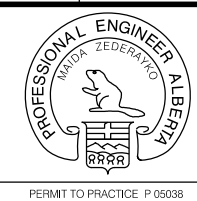

PERMIT TO PRACTICE: P 05038

Manager, Transportation Planning Branch
Manager, Transportation Operations Branch
Director, Sustainable Transportation
Director, Traffic Engineering

CONCEPT PLAN - SUBJECT TO PRELIMINARY DESIGN

PROJECT: **TWO-WAY CYCLE TRACK AND CURB EXTENSIONS**
127 STREET, STONY PLAIN ROAD TO 118 AVENUE



DESIGNED BY: TF
DATE: FEB 2015
SCALE: 1:500

PLAN NO.
S-127-1509

MATCHLINE - PLAN No. S-127-1509

113 AVE

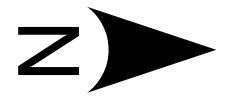
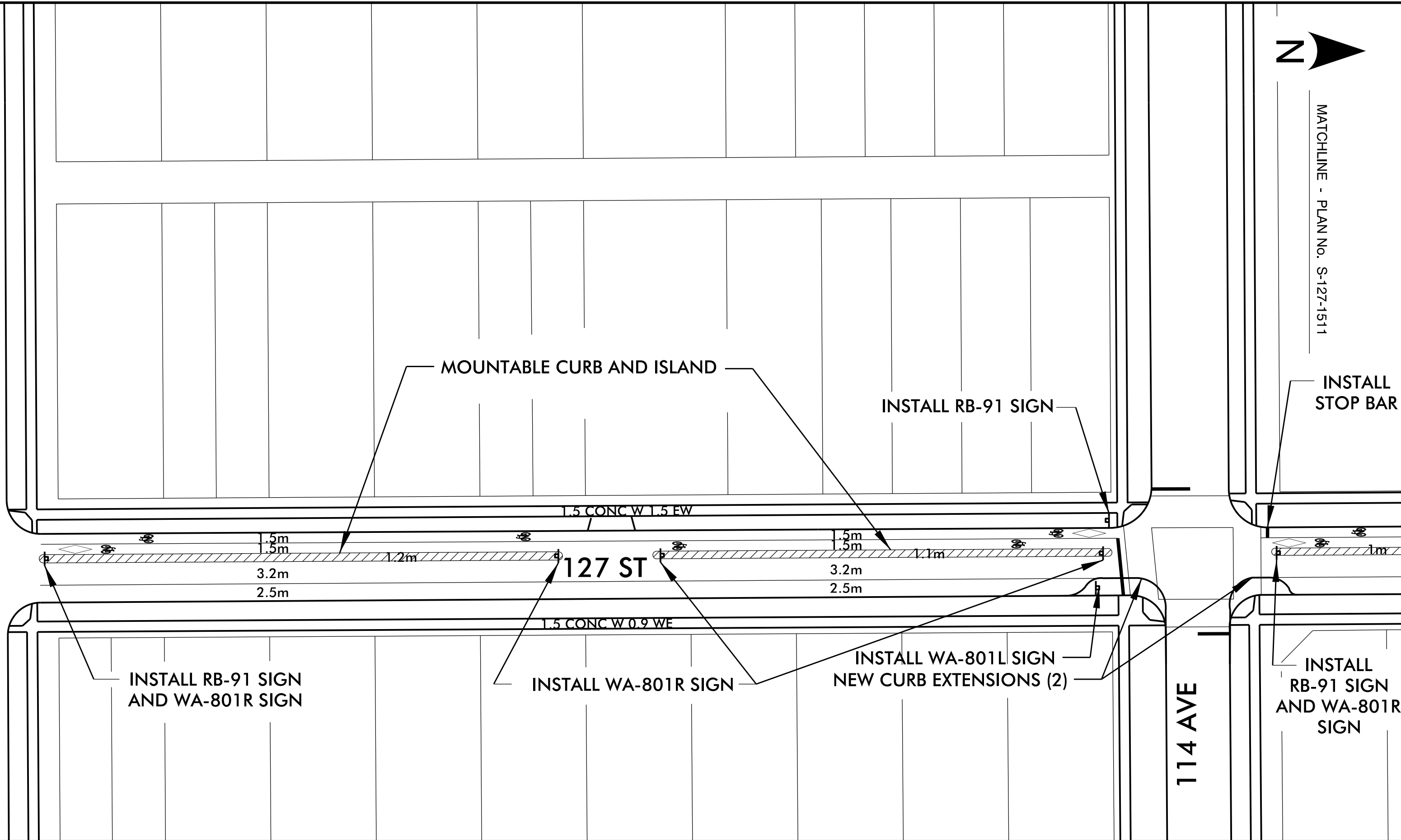

MATCHLINE - PLAN No. S-127-1511

INSTALL STOP BAR

INSTALL RB-91 SIGN AND WA-801R SIGN

NOTES:
ALL PAVEMENT MARKINGS TO BE MEASURED FROM CURB FACE OR AS OTHERWISE NOTED



Manager, Transportation Planning Branch
Manager, Transportation Operations Branch
Director, Sustainable Transportation
Director, Traffic Engineering

CONCEPT PLAN - SUBJECT TO PRELIMINARY DESIGN	
PROJECT: TWO-WAY CYCLE TRACK AND CURB EXTENSIONS	
127 STREET, STONY PLAIN ROAD TO 118 AVENUE	
	DATE: FEB 2015 SCALE: 1:500
PLAN NO. S-127-1510	

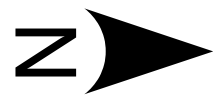

MATCHLINE - PLAN NO. S-127-1510

MATCHLINE - PLAN NO. S-127-1512

MOUNTABLE CURB AND ISLAND

INSTALL RB-91 SIGN

MOUNTABLE CURB AND ISLAND

INSTALL STOP BAR

INSTALL STOP BAR

1.5 CONC W 0.3 EW

127 ST

1.5 CONC W 0.9 WE

INSTALL WA-801L SIGN

INSTALL WA-801L SIGN
NEW CURB EXTENSIONS (2)

INSTALL WA-801R SIGN

INSTALL RB-91 SIGN
AND WA-801R SIGN

INSTALL RB-91 SIGN
AND WA-801R
SIGN

115 AVE

NOTES:

ALL PAVEMENT MARKINGS TO BE MEASURED FROM CURB FACE OR AS OTHERWISE NOTED

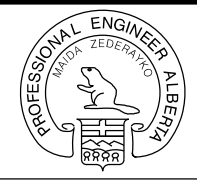

Manager, Transportation Planning Branch
Manager, Transportation Operations Branch
Director, Sustainable Transportation
Director, Transit Engineering

CONCEPT PLAN - SUBJECT TO PRELIMINARY DESIGN

PROJECT: **TWO-WAY CYCLE TRACK AND CURB EXTENSIONS**
127 STREET, STONY PLAIN ROAD TO 118 AVENUE

Edmonton TRANSPORTATION SERVICES
OOL BY: TF
DATE: FEB 2015
SCALE: 1:500
PLAN NO.: S-127-1511



MATCHLINE - PLAN NO. S-127-1511

MATCHLINE - PLAN NO. S-127-1513

116 AVE

MOUNTABLE CURB AND ISLAND

INSTALL RB-91 SIGN

INSTALL RB-91 SIGN
AND WA-801R SIGN

1.5 CONC W 1.5 FW

127 ST

1.5 CONC W 0.9 WE

INSTALL WA-801R SIGN

INSTALL WA-801L SIGN

NEW CURB EXTENSION

INSTALL WA-801R SIGN

INSTALL
WA-801R SIGN

INGLEWOOD ELEMENTARY
SCHOOL

NOTES:

ALL PAVEMENT MARKINGS TO BE MEASURED FROM CURB FACE OR AS OTHERWISE NOTED

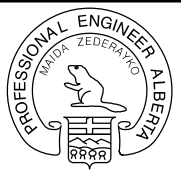

PERMIT TO PRACTICE: P 05038

Manager, Transportation Planning Branch
Manager, Transportation Operations Branch
Director, Sustainable Transportation
Director, Traffic Engineering

CONCEPT PLAN - SUBJECT TO PRELIMINARY DESIGN

PROJECT: **TWO-WAY CYCLE TRACK AND
CURB EXTENSIONS**
127 STREET, STONY PLAIN ROAD TO 118 AVENUE

Edmonton TRANSPORTATION SERVICES
DATE: FEB 2015
SCALE: 1:500
PLAN NO. S-127-1512

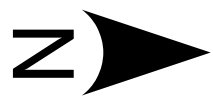

117 AVE

117A AVE

MATCHLINE - PLAN No. S-127-1512

MATCHLINE - PLAN No. S-127-1514

MOUNTABLE CURB AND ISLAND

INSTALL WA-801R SIGN

INSTALL RB-91 SIGN

INSTALL WA-801R SIGN

127 ST

INSTALL
WA-801R SIGN

INSTALL WA-801R SIGN

INSTALL RB-91 SIGN
AND WA-801R SIGN

INSTALL
WA-801R SIGN

1.5 CONC W 1.5 FW

1.5 CONC W 1.5 WE

2.85m

2.85m

1.5m
1.5m

3.2m
2.5m

1.5m
1.5m

2.8m

3.2m
2.5m

NOTES:
ALL PAVEMENT MARKINGS TO BE MEASURED FROM CURB FACE OR AS OTHERWISE NOTED

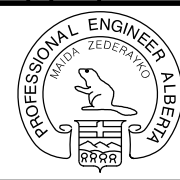

Manager, Transportation Planning Branch
Manager, Transportation Operations Branch
Director, Sustainable Transportation
Director, Traffic Engineering

CONCEPT PLAN - SUBJECT TO PRELIMINARY DESIGN		
PROJECT: TWO-WAY CYCLE TRACK AND CURB EXTENSIONS		
127 STREET, STONY PLAIN ROAD TO 118 AVENUE		
	TRANSPORTATION SERVICES DATE: FEB 2015 SCALE: 1:500	PLAN NO. S-127-1513

117A AVE

MATCHLINE - PLAN NO. S-127-1513

MOUNTABLE CURB AND ISLAND

117B AVE

INSTALL RB-91 SIGN

118 AVE



1.5 CONC W 1.5 FW

1.5m
1.5m

2.8m

3.2m

2.5m

1.5 CONC W 1.5 WE

127 ST

3.6m

3.6m

127 ST

INSTALL
WA-801R SIGN

INSTALL WA-801R SIGN

INSTALL RB-92 SIGN
AND WA-801R SIGN

NOTES:
ALL PAVEMENT MARKINGS TO BE MEASURED FROM CURB FACE OR AS OTHERWISE NOTED



Manager, Transportation Planning Branch
Manager, Transportation Operations Branch
Director, Sustainable Transportation
Director, Traffic Engineering

CONCEPT PLAN - SUBJECT TO PRELIMINARY DESIGN

PROJECT: **TWO-WAY CYCLE TRACK AND CURB EXTENSIONS**
127 STREET, STONY PLAIN ROAD TO 118 AVENUE

Edmonton TRANSPORTATION SERVICES
DATE: FEB 2015
SCALE: 1:500
PLAN NO. **S-127-1514**