

# WELCOME

107 Avenue: 130 Street to 170 Street

Long-Range Planning Study

March 3, 2015

Open House: 4:30–8:30pm

Presentation: 5pm and 7pm (repeat)

# MEETING PURPOSE

- ❖ Present the draft concept plan for 107 Avenue between 130 Street and 170 Street
- ❖ Share key themes from public and stakeholder consultation, and show how public feedback was considered in the development of a long term plan
- ❖ Inform the decision making process for the project
- ❖ Gather your feedback on the draft concept plan for 107 Avenue and answer your questions



# PROJECT PURPOSE

The purpose of this study is to develop a concept plan for 107 Avenue between 130 Street and 170 Street. ***This project is at the planning stage and therefore exact construction timelines are unknown.***

### 107 Avenue requires upgrades to:

- Accommodate future growth and travel pattern changes due to the planned west extension of the Valley Line LRT
- Address operational and safety concerns for all modes (cars, cycling, walking, transit, and trucks) along the corridor
- Reduce traffic delays, congestion and improve connections for pedestrians, cyclists and transit

Strategy

Where we are today  
**CONCEPT**  
PHASE

Design

Build

Operate

# PROJECT HISTORY

- ❖ Study limits originally from west of 109 Street to 170 Street
- ❖ Results from initial public consultation and technical review revealed different concerns for west and east of 130 Street
- ❖ Updates to traffic analysis for the entire corridor also confirmed divergent needs for each section
- ❖ Section from 109 Street to 130 Street is on hold pending additional studies

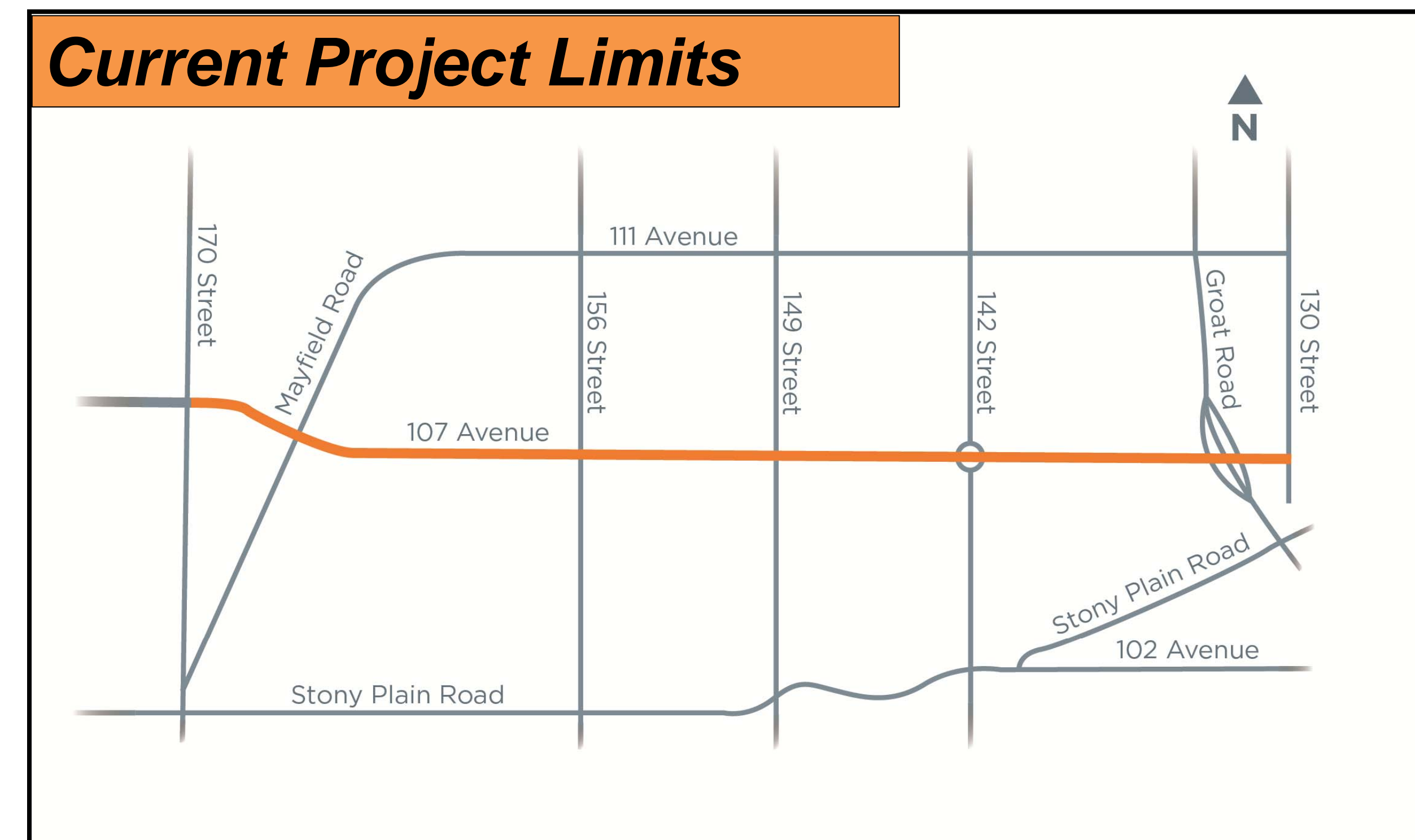
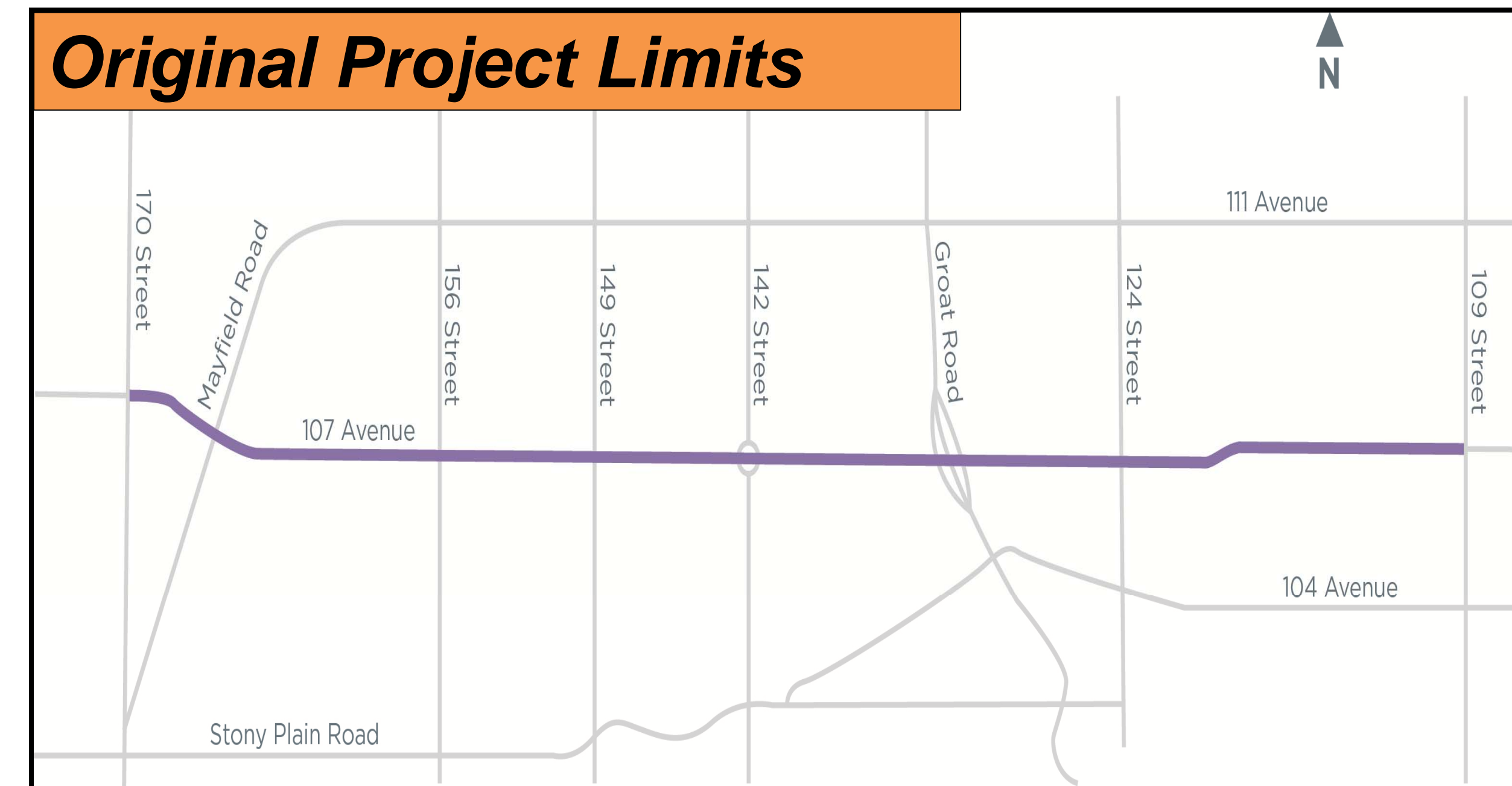



# GUIDING POLICIES

- ❖ Public Involvement Policy (2006)
  - ✓ *Clear purpose, consistent approach, commitment to involve*
- ❖ Sidewalk Strategy (2008)
  - ✓ *Strategy for sidewalk infrastructure in Edmonton*
- ❖ The Way Ahead (2009-2018)
  - ✓ *Strategic Vision & Plan for Edmonton*
- ❖ The Way We Move (2009)
  - ✓ *Transportation Master Plan (TMP)*
- ❖ *Bicycle Transportation Plan (2009)*
  - ✓ *A plan for bicycle friendly City in support of TMP, The Way We Move*
- ❖ Active Transportation Policy (2009)
  - ✓ *Supports a pedestrian and bicycle friendly City by providing adequate facilities and raising awareness of all modes*
- ❖ Complete Streets Guidelines (2013)
  - ✓ *Holistic roadway planning and design approach for all users in all seasons*

### *What Influences the Decision Making Process*

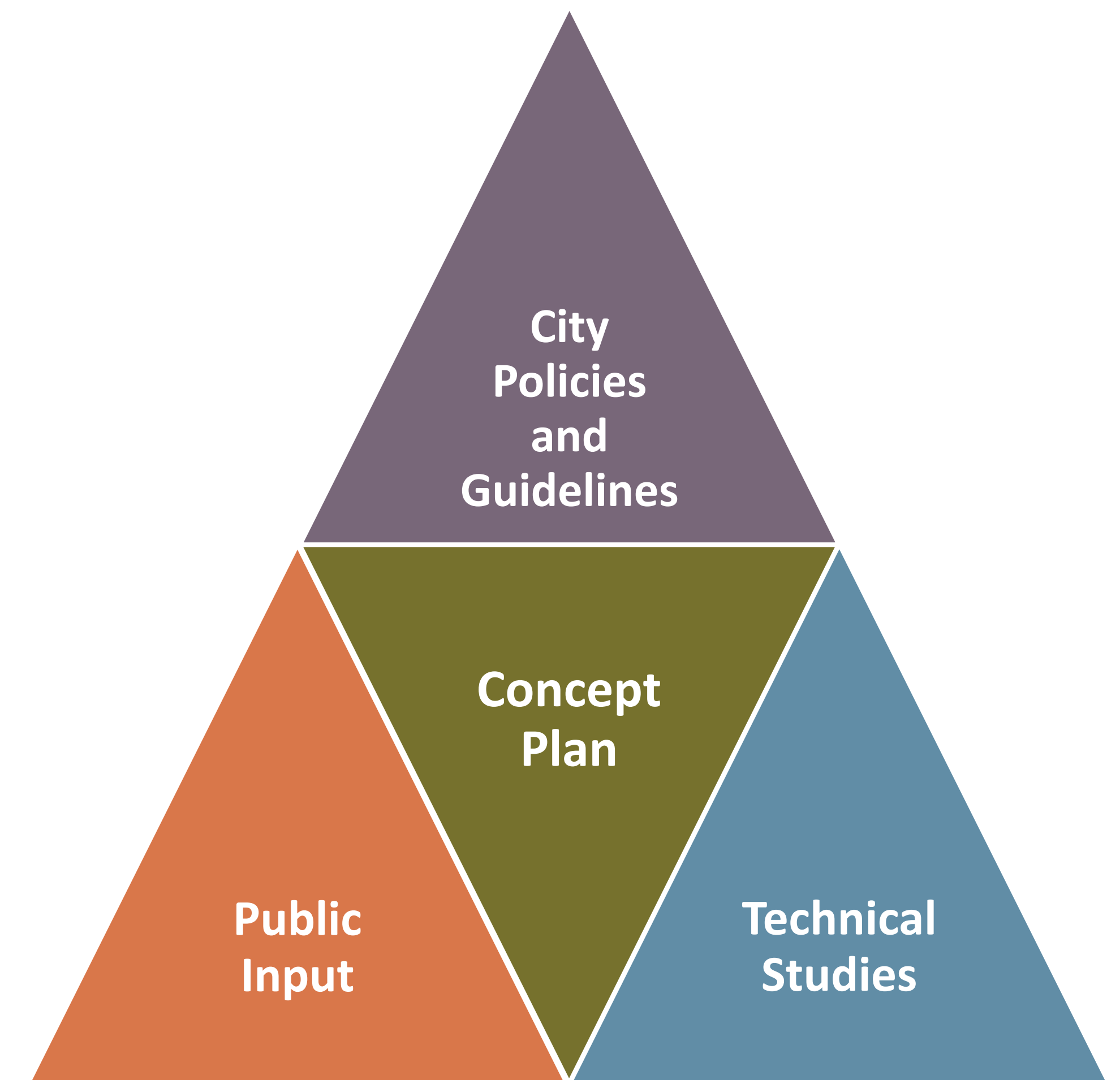



# 107 AVENUE LONG-RANGE PLANNING

## KEY ISSUES

1. The planned west extension of the Valley Line LRT will change travel patterns
2. Existing operational and safety issues due to traffic congestion
3. Right-of-way constraints along the developed corridor
4. Lack of adequate pedestrian, cyclist and transit infrastructure
5. High collision rate at 142 Street traffic circle (427 Collisions in 5 Years)

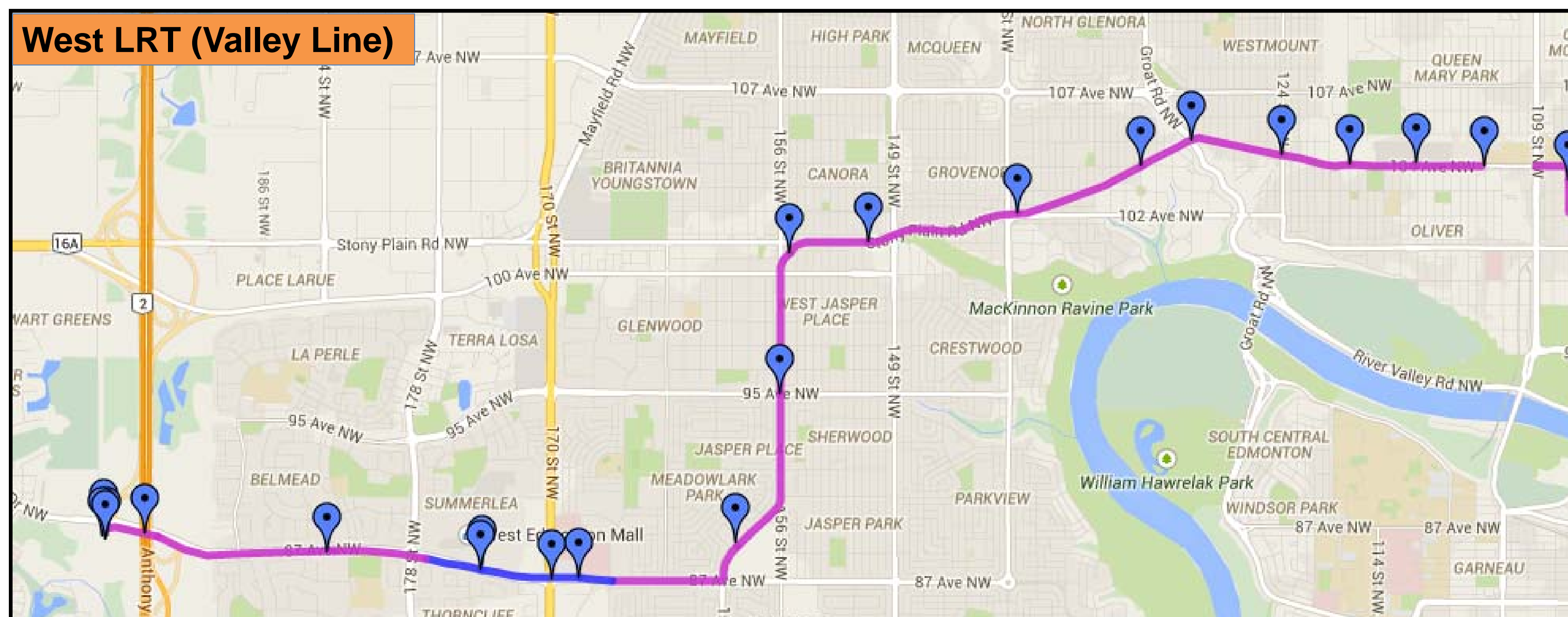
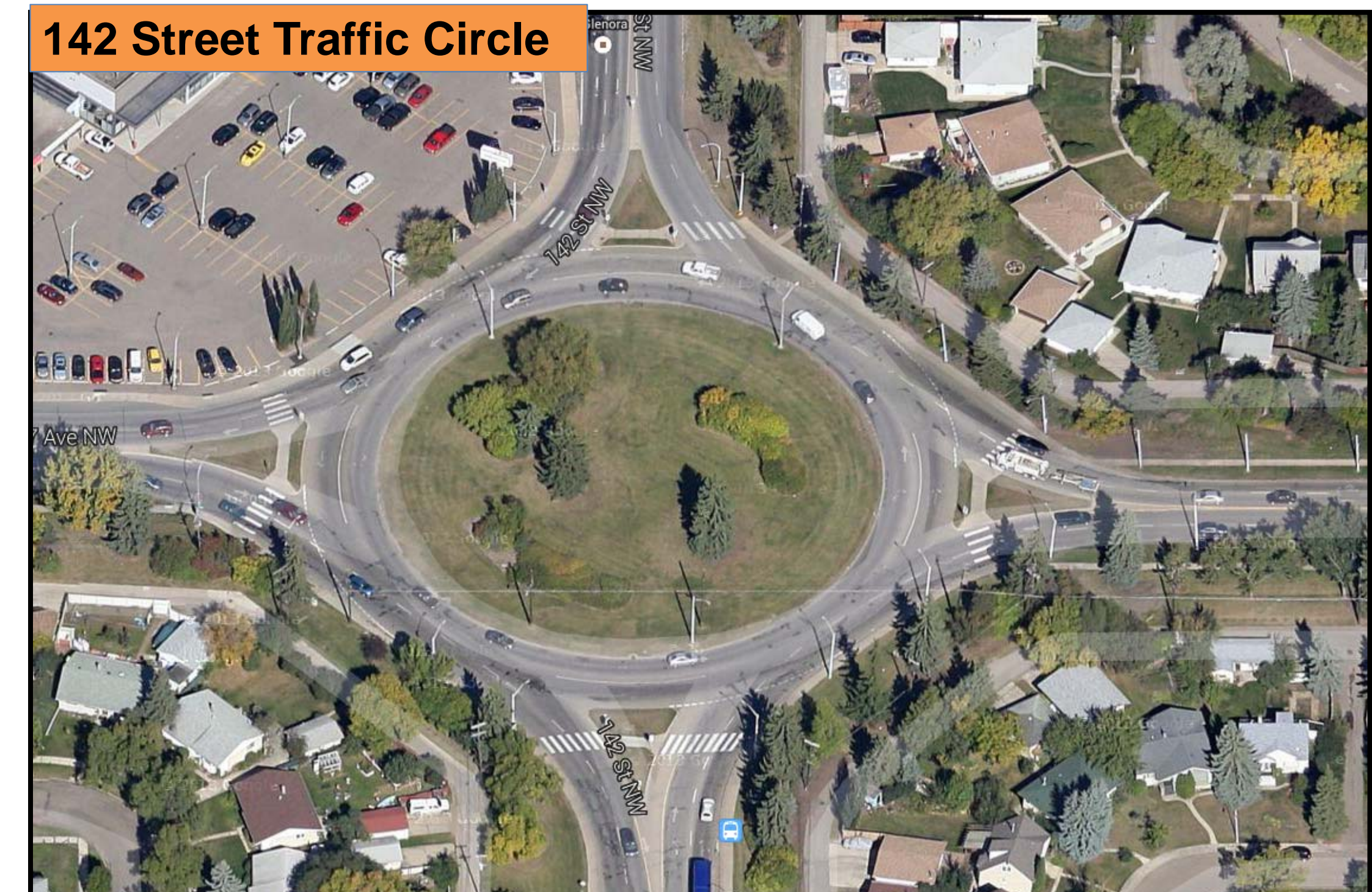

\* Photo Source from Google maps



# WHAT WE HEARD

At the start of the project, the project team met with 15 individual stakeholder groups and a public survey was launched in mid-August 2013 which had 315 respondents. Approximately 85% of respondents identified transportation concerns along the 107 Avenue corridor.

| Concern Raised                                   | Concept Plan Recommendations  |
|--|---|
| Traffic Delays and Congestion                    | Ultimate four lane corridor with intersection improvements.<br>Access modifications and proper left turn bays.                |
| Lack of Pedestrian/Cyclist/Transit Accommodation | Continuous sidewalk and shared use path is provided on either side of 107 Avenue with bus stop connections                    |
| Overall Safety and Collisions                    | 142 Street traffic circle to be converted to a standard signalized intersection.<br>Access management at major intersections. |
| Loss of Existing Trees                           | New trees will be planted within the project area adding up to the same dollar value as the trees removed                     |



# HIGHLIGHTS OF PROPOSED PLAN

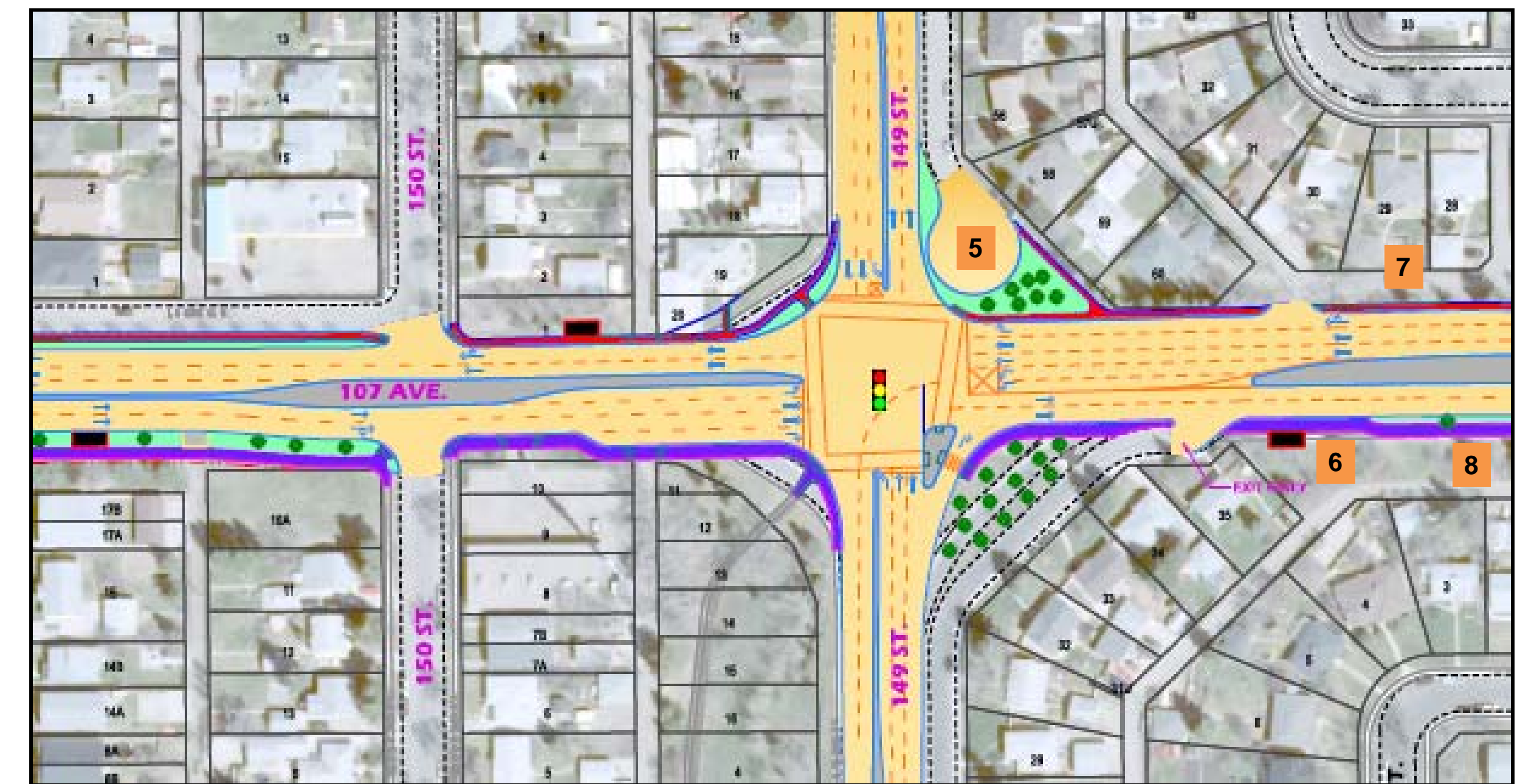
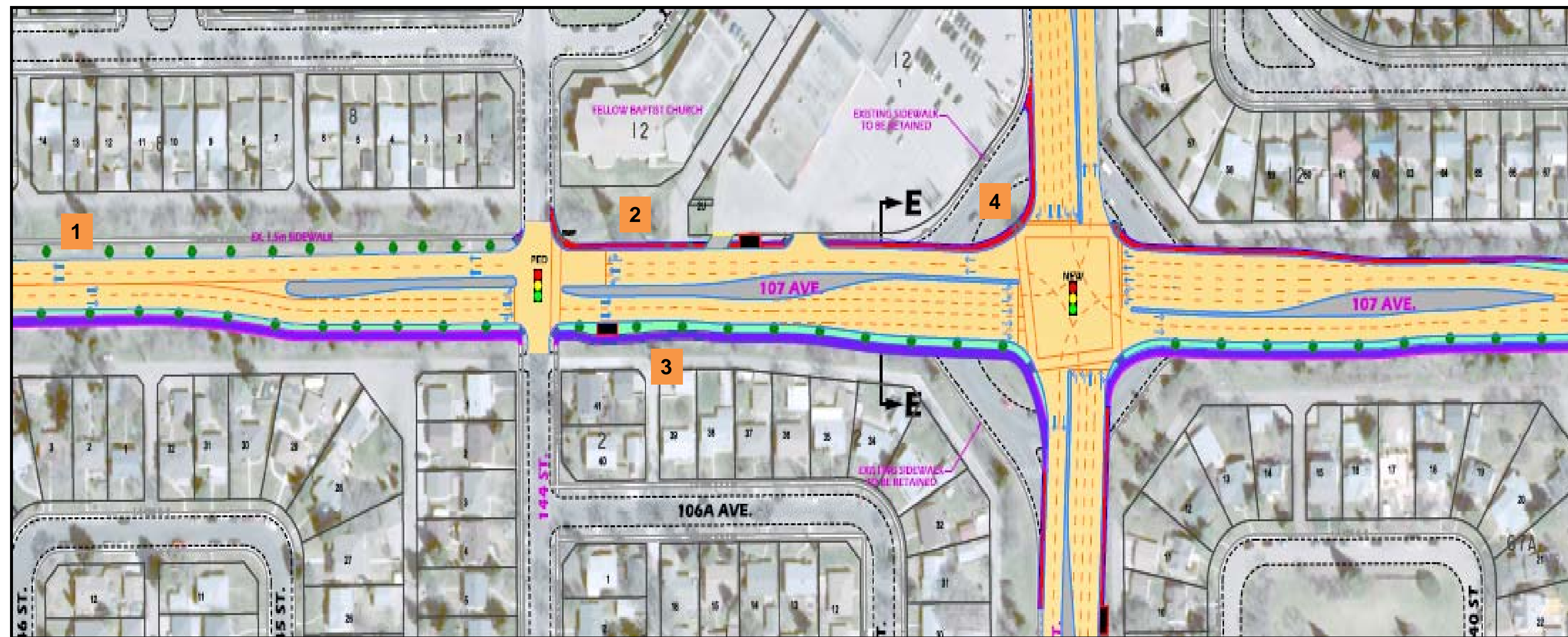

1. Ultimate 4-lane corridor with intersection improvements
2. Sidewalk provided on north side
3. Shared-Use Path provided on south side
4. 142 Street traffic circle to be removed
5. Access management at major intersections
6. Improved transit stop and neighbourhood connections
7. Minimized property impacts
8. Protect boulevard trees and enhance landscaping where possible

***\* Please refer to plans for details***



# PROJECT TIMELINE

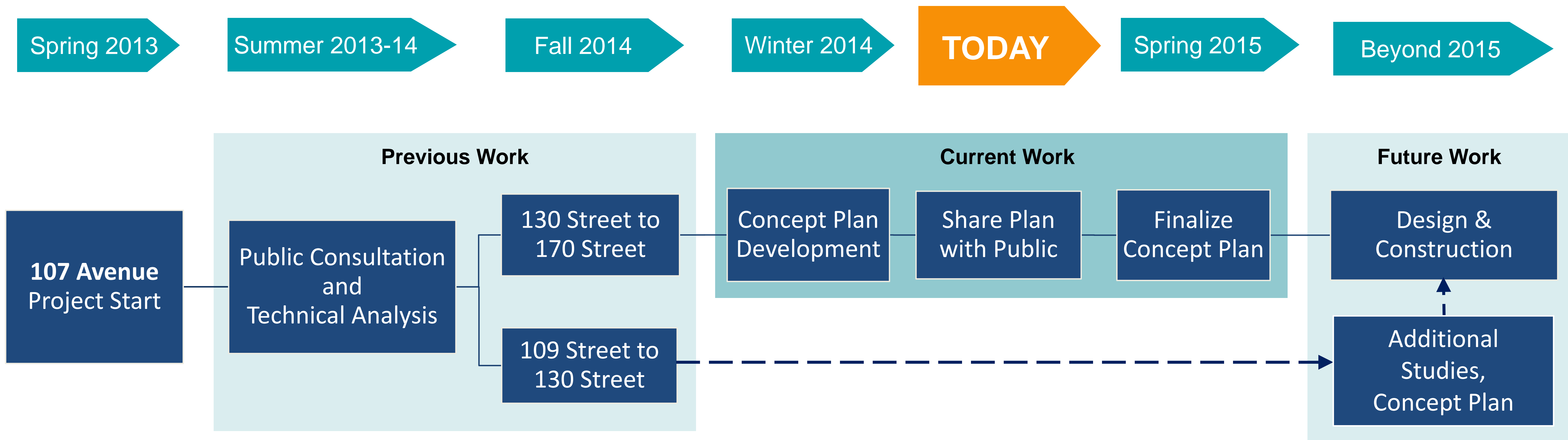



# THANK YOU

## Tell us how we did!

Please complete a feedback form and/or leave your comments directly on the plans. Feedback forms can be left at the welcome desk or if you prefer, take one home and submit by end of March 20, 2015 through mail, email or fax. For updates, please sign up to be part our mailing list or visit our website.

**Mail: 107 Avenue Project Team  
13<sup>th</sup> Floor, Century Place  
9803 – 102A Avenue NW  
Edmonton, AB T5J 3A3**

**Email: [107avenue@edmonton.ca](mailto:107avenue@edmonton.ca)**

**Fax: 780-496-4287**

**Phone: 780-496-1795**

Visit us online at: [www.edmonton.ca/107AveStudy](http://www.edmonton.ca/107AveStudy)