

EAST SIDE OF 91ST.
SUBJECT TO CHANGE.
6-LANE SECTION
TO BE APPROVED.
JUNE 29/07
AS

Notes:

- ~ Plans to be updated during detailed design to reflect latest lane widths as shown in the 2011 City of Edmonton Design and Construction Standards.
- ~ Plans to be updated during detailed design to reflect all existing business accesses.



Director of Major Projects Planning
06/12/12
2006/12/07
2007/10/03
2006/12/12

CONCEPT PLAN - SUBJECT TO DETAILED DESIGN			
PROJECT: ELLERSLIE ROAD			
PARSONS ROAD - 91 STREET			
PROPOSED ULTIMATE ALIGNMENT			
Edmonton	TRANSPORTATION	MP.	PLAN NO.
DATE: OCT, 2006	SCALE: 1:1000		NELL-0604

NOTE:
CENTRE TWO-WAY LEFT TURN LANE MAY BE TAPERED DOWN TO 4.0m. LOCATION OF TAPER SUBJECT TO DESIGN OF 91 STREET TO THE SOUTH. TO BE DETERMINED AT PRELIMINARY DESIGN STAGE.

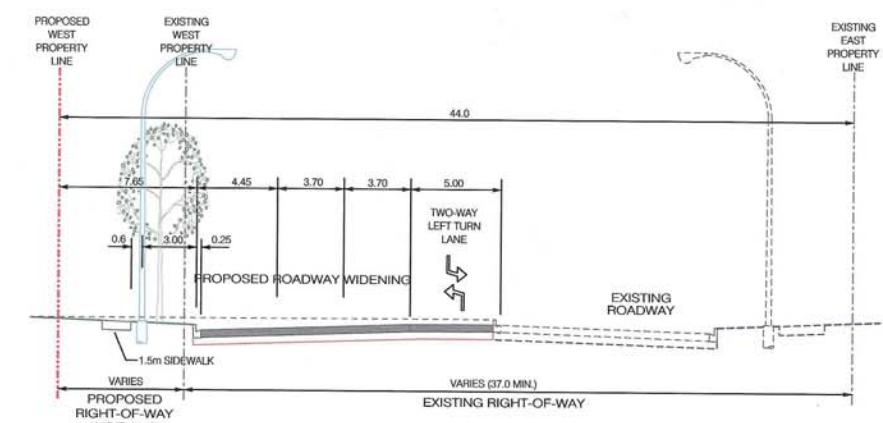

SECTION A-A
1:200

POSTED SPEED = 60 km/h
DESIGN SPEED = 70 km/h

Notes:
~ Plans to be updated during detailed design to reflect latest lane widths as shown in the 2011 City of Edmonton Design and Construction Standards.
~ Plans to be updated during detailed design to reflect all existing business accesses.

	Director of Major Projects Planning Date: 06/12/12 Date: 2005/12/07 Date: 2007/01/03 Date: 2007/12/12	CONCEPT PLAN - SUBJECT TO DETAILED DESIGN 91 STREET PARSONS ROAD INTERSECTION - ELLERSLIE ROAD PROPOSED ULTIMATE ALIGNMENT	
	The City of Edmonton TRANSPORTATION	DRAWN BY: MP DATE: NOV, 2005 SCALE: 1:1000	PLAN NO: S091-0501