

170 Street Planning Study

Ellerslie Road to 41 Avenue SW

Public Information Session



November 30, 2010

4pm to 8pm

Purpose of the Study

- To confirm the short- & long-term plans for 170 Street, as an urban freeway, from Anthony Henday Drive to 41 Avenue SW.
- In the long-term this will include interchanges at:
 - Windermere Boulevard
 - Ellerslie Road
 - 25 Avenue SW
 - 41 Avenue SW

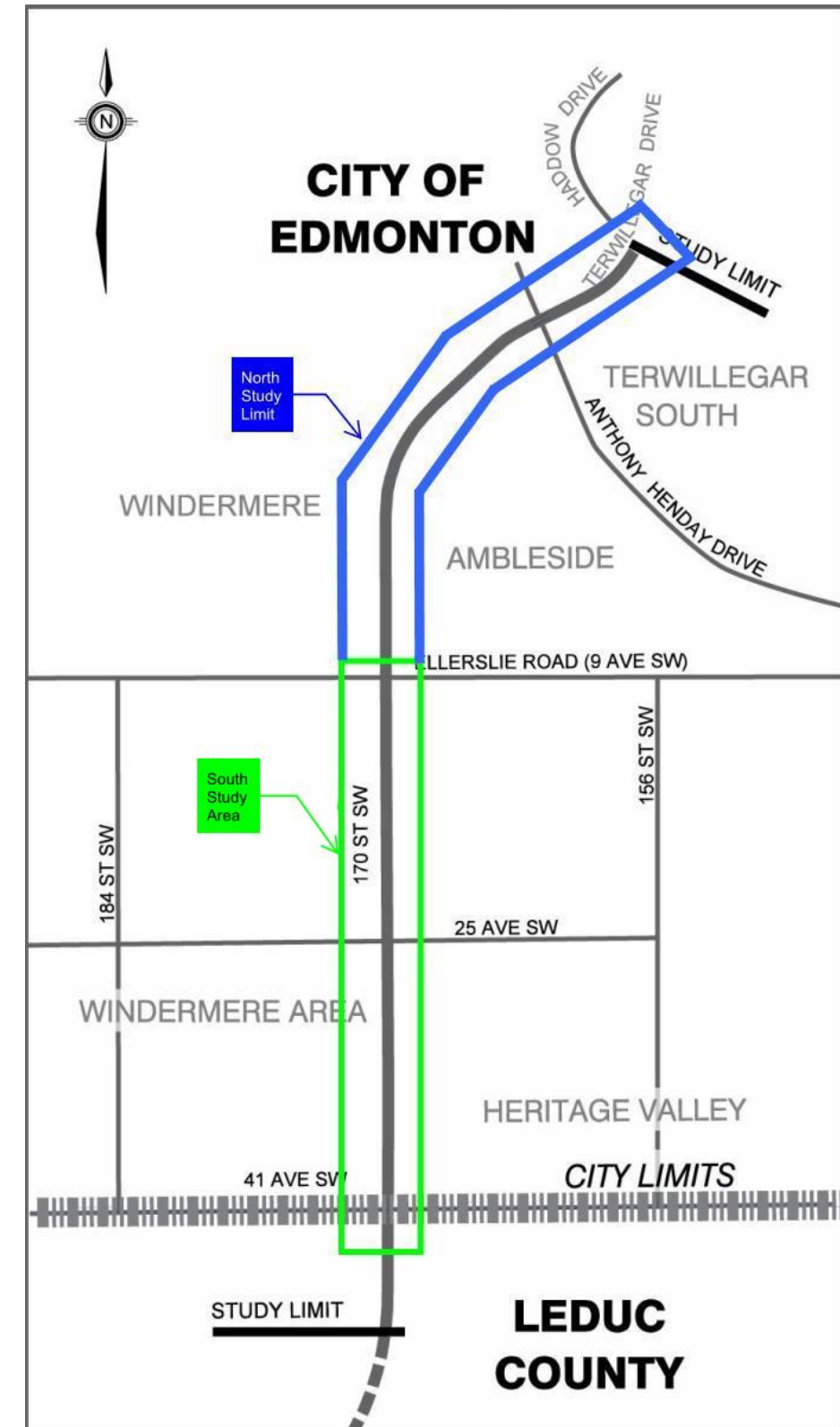

Purpose of the Open House

To make the community aware of:

- The background information along 170 Street
- The current study process
- The proposed plan for the 170 Street interchange at Anthony Henday Drive interchange (north study area)
- The recommended plan for 170 Street, south of Ellerslie Road (south study area)

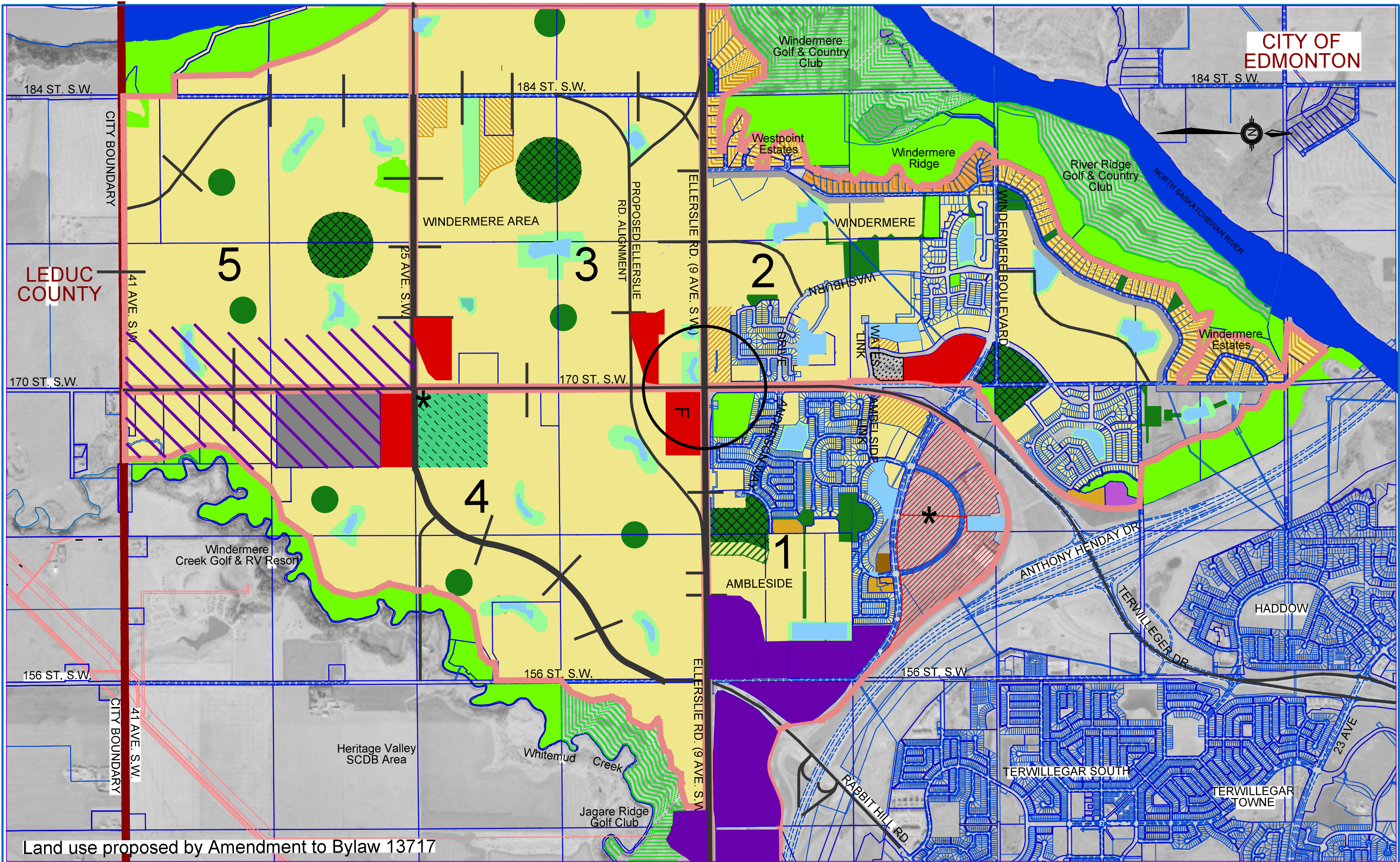

Land use proposed by Amendment to Bylaw 13717

LEGEND			
Low density Residential	Shopping Centre Commercial	Communications	Transit Centre
Medium Density Residential	Neighborhood Commercial	Special Study Area	Neighborhood Boundaries
High Density Residential	Business Employment	Natural Area	General Location of Emergency Response Facility
Mixed Used	Institutional	Neighborhood Park	
Existing Country Residential	Potential Economic Activity Centre	District Park	
Existing Serviced Country Residential	Golf and Country Club	Storm Water Management Facility	
Large Lot Residential	Community Knowledge Campus/School	Public Utility	

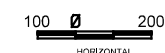

Manager, Transportation Planning Branch
Director, Development & Capital Planning
Director, Strategic Planning
Director, Roadways Design
General Supervisor, Strategic Planning

CONCEPT PLAN - SUBJECT TO PRELIMINARY DESIGN

PROJECT: **170 STREET**
PROPOSED LAND USE MAP
EXHIBIT 2.3

TRANSPORTATION

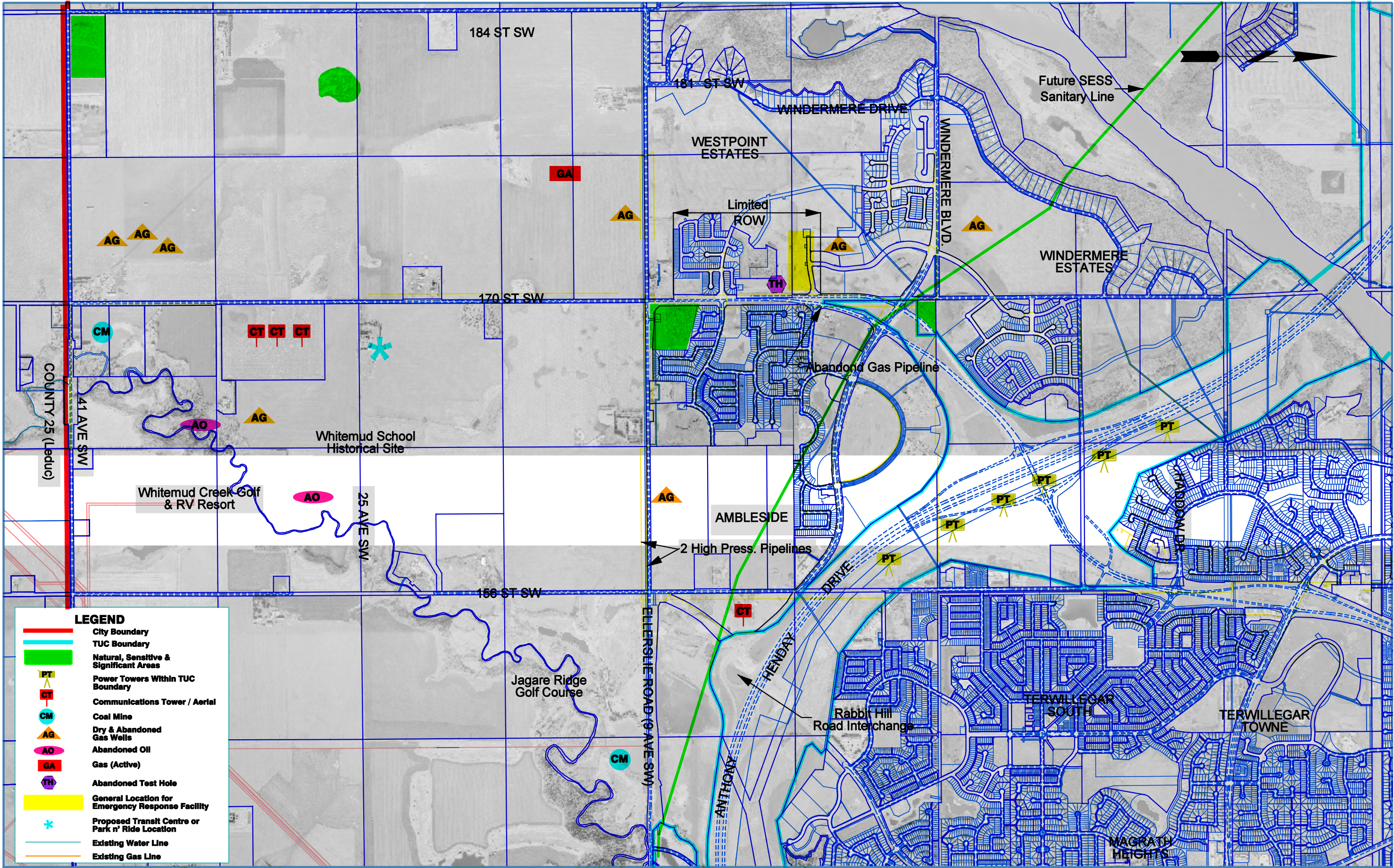

LEGEND

- City Boundary
- TUC Boundary
- Natural, Sensitive & Significant Areas
- Power Towers Within TUC Boundary
- Communications Tower / Aerial
- Coal Mine
- Dry & Abandoned Gas Wells
- Abandoned Oil
- Gas (Active)
- Abandoned Test Hole
- General Location for Emergency Response Facility
- Proposed Transit Centre or Park n' Ride Location
- Existing Water Line
- Existing Gas Line



Manager, Transportation Planning Branch
Director, Development & Capital Planning
Director, Strategic Planning
Director, Roadways Design
General Supervisor, Strategic Planning

CONCEPT PLAN - SUBJECT TO PRELIMINARY DESIGN

170 STREET
CONSTRAINT ISSUES
EXHIBIT 2.5

PROJECT: THE CITY OF EDMONTON TRANSPORTATION

DATE: Nov 2009
SCALE: 1:2000

PLAN NO. S170 XX X01

exhibit.tbl

6:54:20 AM

11/22/2010

...Constraints_Exhibit_2.5.dgn