



RIVER VALLEY ROAD/ GROAT ROAD INTERCHANGE CONCEPT PLANNING

MAY 2015

About the Project

The City of Edmonton is finalizing a long-term concept plan for the River Valley Road / Groat Road interchange. This interchange is a popular commuter and recreation route for travellers, whether they cycle, walk or drive. It provides all directional movements between River Valley Road, Groat Road and Victoria Park Road and provides access to Government House Park and the River Valley trail system.

To develop concept plan options, commuters, trail users (joggers, cyclists), area business/park workers, Edmonton Bicycle Commuters' Society as well as Trails, Paths & Routes Advisory Committee were consulted to identify issues and provide feedback. Various communication methods were employed to foster information sharing and consultation with stakeholders, including one-on-one meetings, e-newsletters, online surveys, social media, a public open house, and communicating directly with citizens through emails and telephone calls.

Based on the feedback received throughout the public involvement process, along with technical and policy considerations, the project team has developed a recommended plan which maintains all the existing movements and recommends improvements to specific section of the interchange.

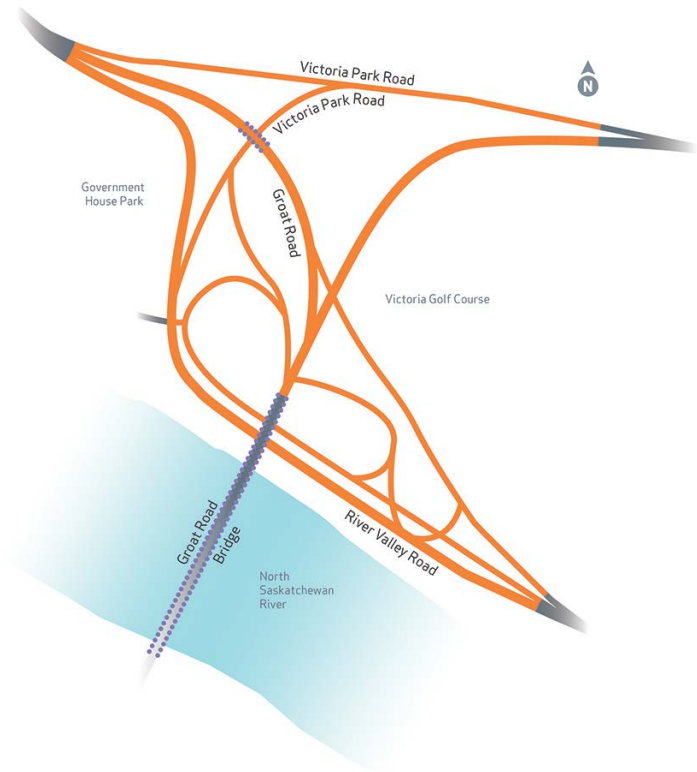



RIVER VALLEY ROAD/ GROAT ROAD INTERCHANGE CONCEPT PLANNING

MAY 2015

The Recommended Plan

The following improvements are included in the recommended plan:

#1: Existing Groat Road Signalized Intersection

- Add a dedicated right-turn lane for westbound traffic turning right to go north on Victoria Park Road
- Relocate the right turn from Groat Road northbound to River Valley Road closer to the intersection, providing better visibility of the pedestrian crossing
- Widen the shared-use path to the standard 3.0 meters.
- Realign the shared-use path from Groat Road Bridge to River Valley Road, reducing the steep slope

EXISTING



RECOMMENDED

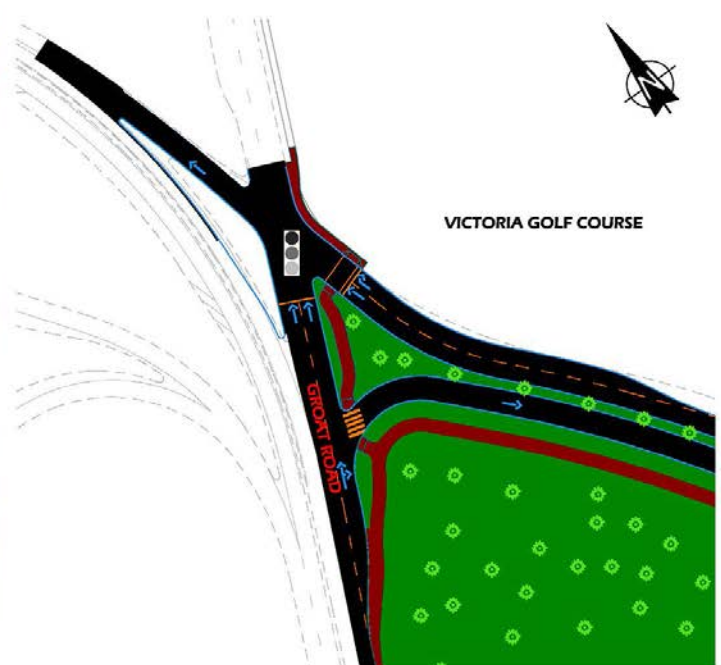



RIVER VALLEY ROAD/ GROAT ROAD INTERCHANGE CONCEPT PLANNING

MAY 2015

#2: New Signalized Intersection at River Valley Road

- Consolidate existing multiple turns and merges into one signalized intersection
- Add a dedicated left-turn lane for traffic traveling River Valley Road eastbound
- Remove existing mid-block crossing and construct pedestrian crossing at signal with curb extension
- Realign the shared-use path from Groat Road Bridge to River Valley Road, reducing the steep slope

EXISTING



RECOMMENDED





RIVER VALLEY ROAD/ GROAT ROAD INTERCHANGE CONCEPT PLANNING

MAY 2015

#3: Ramp System Adjacent to Government House Park Access

- Redesign right-turn to improve safety and driver sight lines
- Standardize intersection with roads at 90° to each other

EXISTING



RECOMMENDED

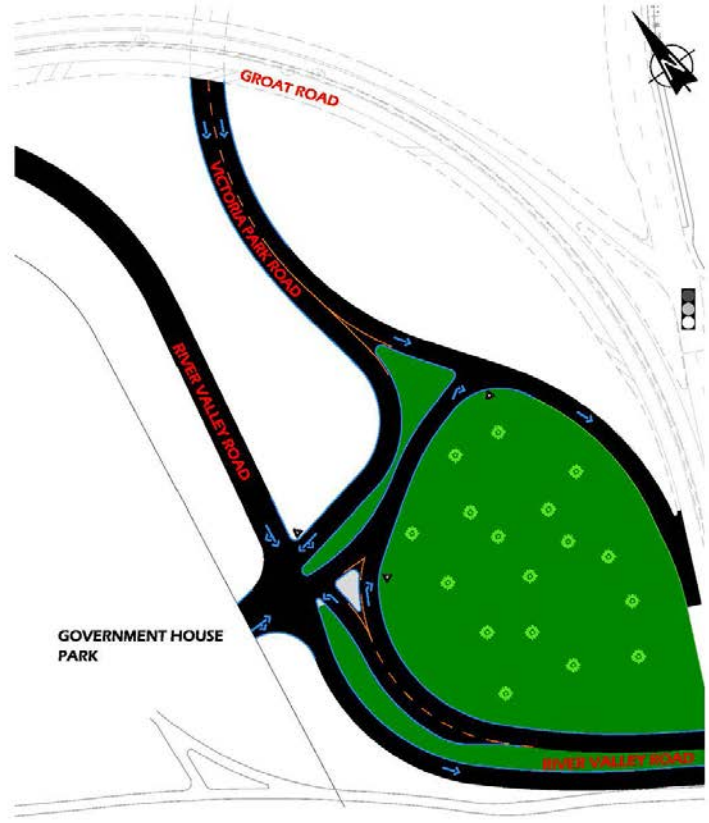

#4: Victoria Park Road Westbound to Groat Road Northbound Merge (Image on next page)

- Existing merge is a collision hot spot due to poor entry angle; improvement at existing location is constrained by road curvature and ravine slopes
- New merge to the left hand side of Victoria Park Road
- New merge improves safety and driver sight lines



RIVER VALLEY ROAD/ GROAT ROAD INTERCHANGE CONCEPT PLANNING

MAY 2015

EXISTING



RECOMMENDED





RIVER VALLEY ROAD/ GROAT ROAD INTERCHANGE CONCEPT PLANNING

MAY 2015

Additional improvements for pedestrians and cyclists were considered at the following locations:

#a: Shared-use Path Widening along Victoria Park Road

- Existing shared-use path is narrow and requires widening
- Due to slope stability issues, design for widening cannot proceed without more in-depth geotechnical studies
- A separate project for this shared-use path widening will be initiated in the future

#b: Existing Sidewalk Section along Groat Road Southbound

- This section of sidewalk is 1.5 meter wide and terminates near the ramp to River Valley Road. There are slope issues and utility conflicts for completing the connection of the sidewalk to the shared-use path on River Valley Road. A separate cyclist facility would also be needed, as the width of the sidewalk is not sufficient for a shared-use path.
- It is recommended that this sidewalk section be removed up to the location where the shared-use path diverges from Groat Road southbound into Government House Park. Signage and lighting improvements will be required to direct pedestrians and cyclists to the existing shared-use path in Government House Park.

#c: Construction of a pedestrian bridge connecting Groat Road Bridge and the shared-use path along River Valley Road was suggested by stakeholders

- Design for a pedestrian bridge is cost-prohibitive, with an estimated cost of around \$2 Million, and is therefore not recommended.

Navigating the Interchange

Many commuters said in the previous online survey that they found the interchange difficult to navigate and suggested improved or additional signage. The City's Transportation Operations undertook a signage review and concluded the current interchange signage meets standards, however, updates to signage will occur with the recommended roadway improvements. Any trees and shrubs obscuring signs will be trimmed as a part of seasonal maintenance.

What's Up Next

There is currently no funding identified for construction of the improvements to the River Valley Road / Groat Road interchange, therefore construction timelines are unknown. Transportation Planning undertakes concept planning so that if funding becomes available, plans are in place to move quickly into the detailed design and construction phase of a project. Construction for any or all of the localized improvements for this project may occur once funding becomes available.

For More Information

Visit: www.edmonton.ca/RiverValleyGroatInterchange

Contact: Joleen Harris, Senior Engineer

Call: 780-944-7659

Email: joleen.harris@edmonton.ca