

PARKALLEN SANITARY SEWER DIVERSION 2 PROJECT DATA SHEET

Background: In July 2004, extensive surface and basement flooding was experienced in the City of Edmonton as a result of heavy rainstorms that occurred. The majority of the flooding reports came from 43 neighbourhoods. The higher priority neighbourhoods, of which Parkallen is one, became the subject of study and conceptual design. The Sanitary Sewer Diversion will involve the installation of a 600 mm diameter relief sewer from 65 Avenue south to 61 Avenue, through walkways/laneways and connecting to the 1500 mm sewer on 111 Street.

Project Status: Preliminary/Detail Design Phase

Tentative Construction Schedule: 2009 or 2010.

Sewer Length: 460 m

Pipe Diameter: 600 mm

Pipe Depth: 4 – 9 m

Construction Method: Open Excavation and Trenchless

Design Consultant: Bel•MK Engineering Ltd.

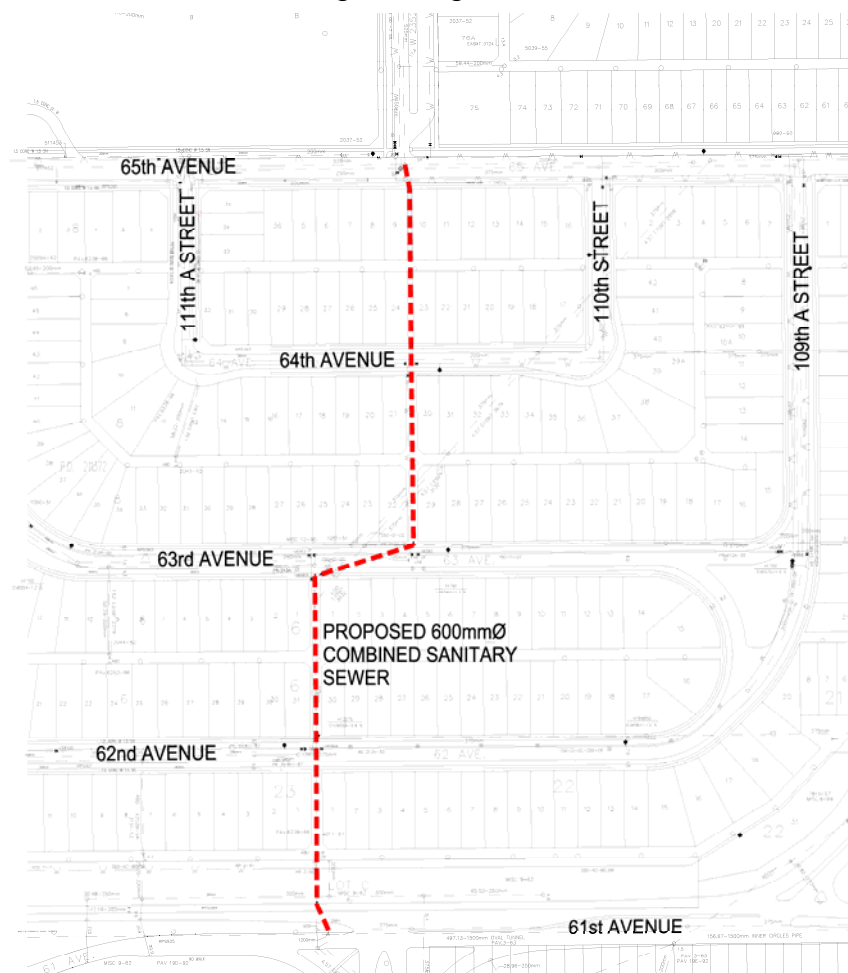

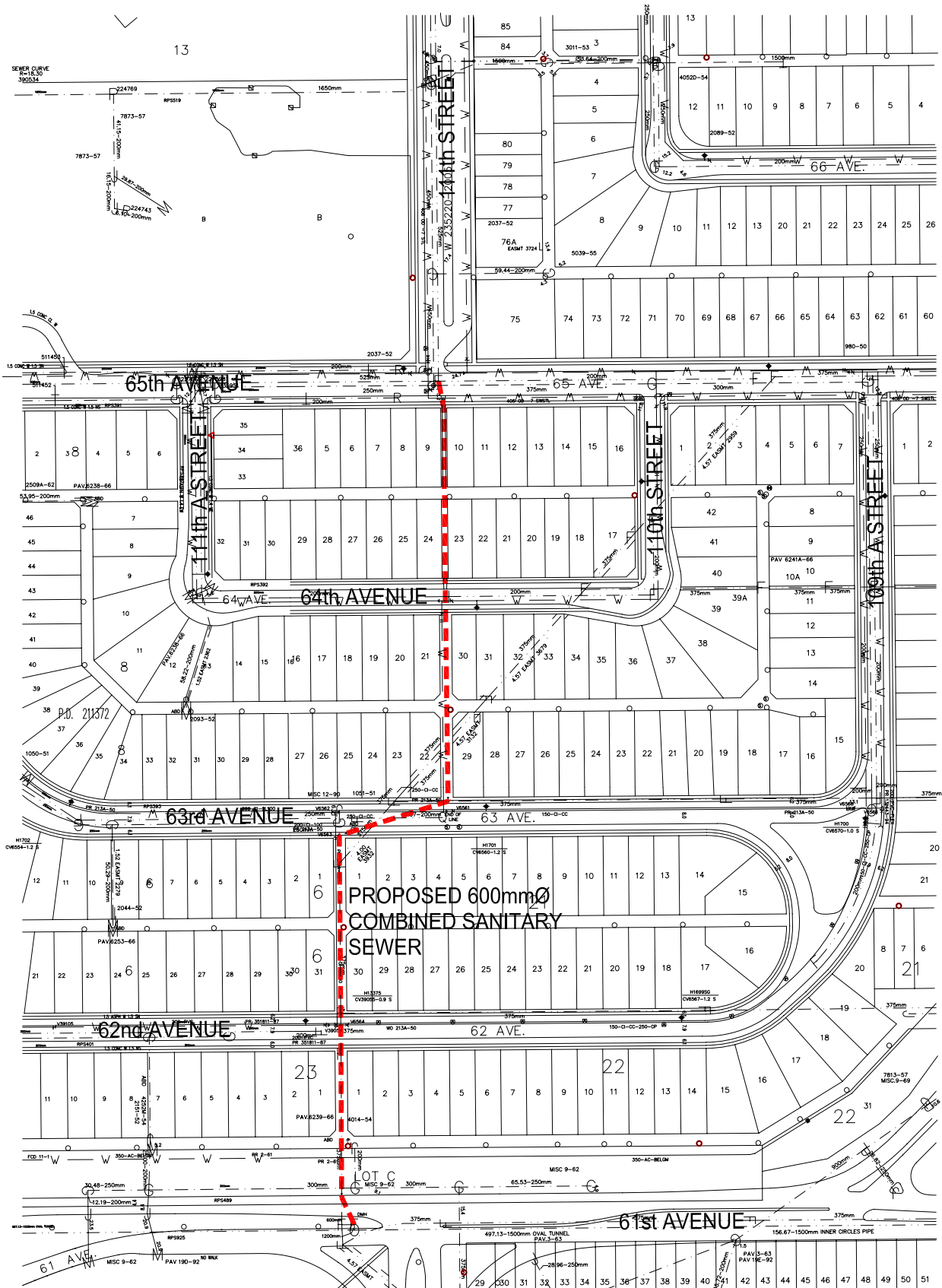

THE CITY OF EDMONTON
 ASSET MANAGEMENT AND PUBLIC WORKS
 DRAINAGE SERVICES DESIGN AND CONSTRUCTION
 PARKALLEN SANITARY SEWER DIVERSION 2