

CONTACT US

ONLINE edmonton.ca/CRLassessment

PHONE 311 (780-442-5311, if outside Edmonton)

Community Revitalization Levy (CRL)

Your CRL area



Edmonton

Edmonton

YOUR PROPERTY IS IN A CRL AREA

The City of Edmonton is investing in new public amenities and/or infrastructure in your area. This will help attract new investment and development that may not otherwise occur. It will help revitalize your area.

The CRL is not an additional tax. You will pay the same property taxes as the owner of a property with the same assessed value elsewhere in the city.

THE CRL ADVANTAGE

Usually, property tax revenue from all areas in the City is pooled to pay for City programs and services throughout Edmonton.

The CRL gives the City the ability to borrow to invest in your area now and use the tax revenue from any increases in property values in your CRL area to pay back the money borrowed.

Your annual property assessment notice shows the baseline assessment and any incremental assessment.

Your annual property tax notice will show the amount of your taxes that will go toward paying off the cost of the CRL investments. Tax notices are mailed in May.

HOW THE CRL WORKS

1

Your property assessment as of December 31 of the year your CRL is approved is the baseline assessment.

Current and future municipal taxes on this baseline assessment are used to fund City services throughout Edmonton.

2

Future municipal taxes and provincial education taxes resulting from increased property assessment will go directly to paying off the money borrowed to invest in your area.

3

In 20 years, or when the CRL loan is paid, all municipal taxes from your area will again be used to fund City services throughout Edmonton.

CRL AREAS IN EDMONTON

THE QUARTERS

Baseline December 31, 2011

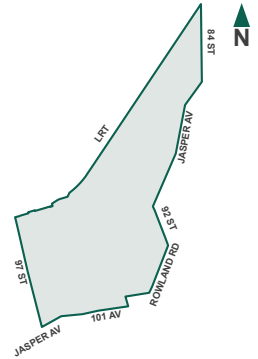

BELVEDERE

Baseline December 31, 2012

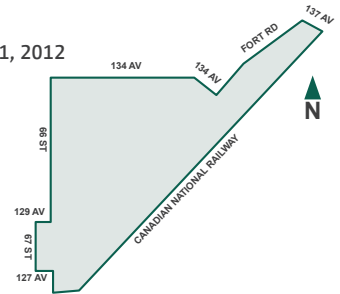

DOWNTOWN

Baseline December 31, 2014

