

Concept Plan 1:1250



- 26 Tree/berm buffer
- 24 Future access to 153 Ave extension
- 23 Cremation walk
- 22 Future entry road with ornamental trees and low sandstone walls
- 21 Open air pavilion and infant garden
- 20 Scattering meadow
- 19 Memorial bosque with family vessels and/or columbaria
- 18 Woodland Green Burial with outdoor ceremonial area
- 17 Scattering mound with memorial walls
- 16 Scattering forest with memorial walls

LEGEND

A Building Option A: Separate Public/ Admin and Maintenance

B Building Option B: Combined Public/ Admin and Maintenance

- 25 Existing Forest
- 27 Muslim Burial Area
- 26 Potential future road
- 24 Building Option B: Connected public/ admin and maintenance buildings
- 23 Building Option A: Separate maintenance building
- 22 Main entry with ornamental trees and improved signage
- 21 Potential future service-only entry
- 20 Improved Signage along St. Albert Trail
- 19 Future memorial feature/wall
- 18 Building Option A: Separate public/admin building with integrated public space and views to site features
- 17 In-ground interment areas with sandstone coloured markers
- 16 Buffer/Tree Nursery
- 15 Walking Path
- 14 Cremation grove with family vessels or columbaria
- 13 Future Military Area expansion
- 12 Existing Graves

Precedent Images



Memorial Bosque



Woodland Burial



Scattering Mound



Cremation Grove



Scattering Meadow



Outdoor Ceremonial Space

Location



Phasing Plan

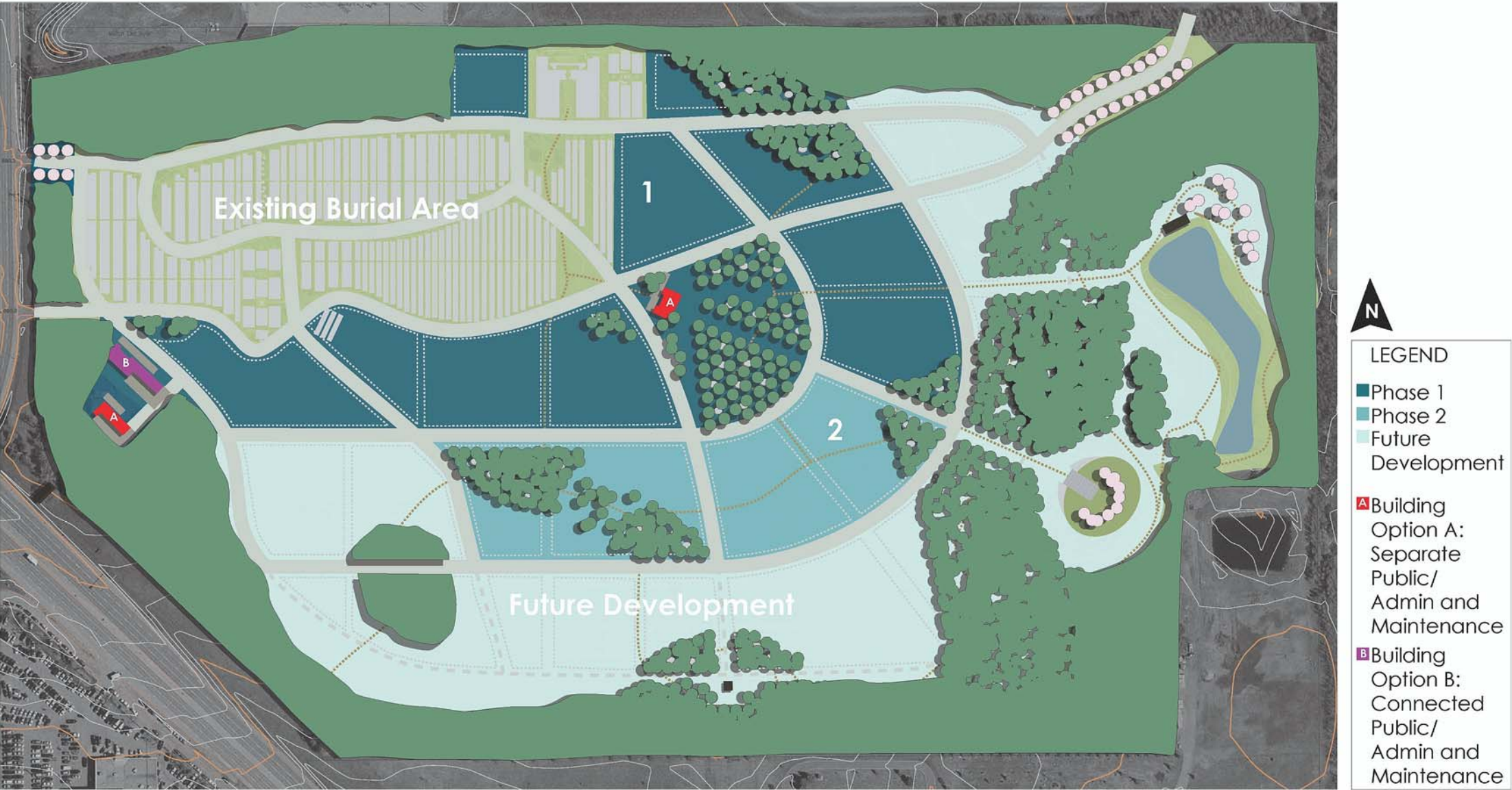

Material Concepts



Sandstone



Engraved Natural Stone



Wood



Water



Drought-tolerant planting



Ornamental Trees



Prairie Grasses

Concept Plan 1:1000



Precedent Images



Scattering mound



Open-air pavilion



Sunken courtyard



Rolling topography



Urn Walk with Family Vessels



Water station

South Haven Cemetery: Site Plan

Location



Phasing Plan

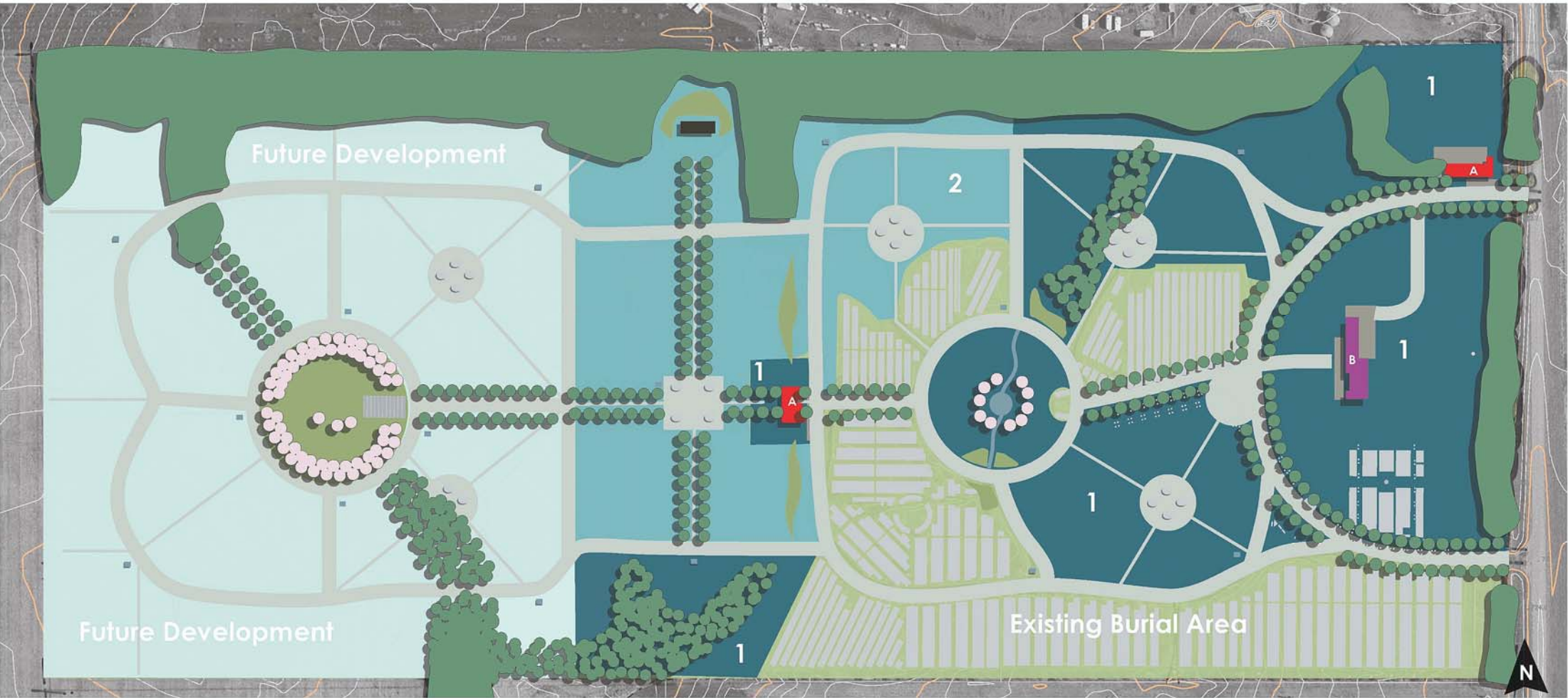

LEGEND

■ Phase 1 ■ Phase 2 ■ Future Development

■ A Building Option A: Separate Public/Admin and Maintenance ■ B Building Option B: Connected Public/Admin and Maintenance

Material Concepts



Sandstone



Natural Wood



Water

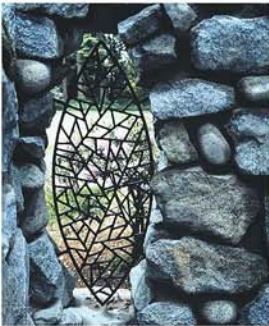

Metal



Prairie Grasses

Option A : Separate Public/Admin and Maintenance Buildings

Public/Administration Building

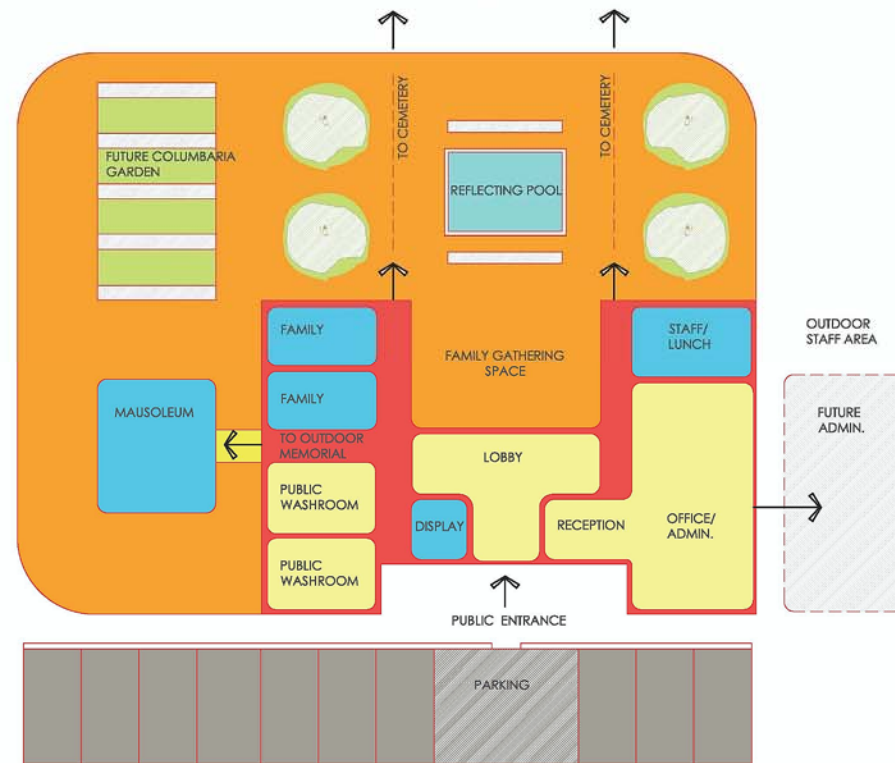

PROS:

- Bereaved customers and maintenance staff are separated.
- Public service experience is improved as there is separation from maintenance work and equipment.
- An integrated outdoor public realm is possible as there is no operations yard behind the building: Three sides of the public building can be integrated into the landscape.
- Visitors can walk through the public/admin building to public gardens and the memorial area, as well as to the cemetery.
- The central location of the public/admin building on the site results in a 5 minute or less walk to all parts of the cemetery.
- Future additions such as indoor niches and/or mausoleum can be more easily integrated into a separate public/admin building.
- Separate structures make it easier to phase construction.
- Drive-through bays are more easily achieved in a separate maintenance building.

CONS:

- Maintenance and Admin Staff are separated.
- Duplicate space for lunchroom and site services may result in a marginal cost increase.

Maintenance Building

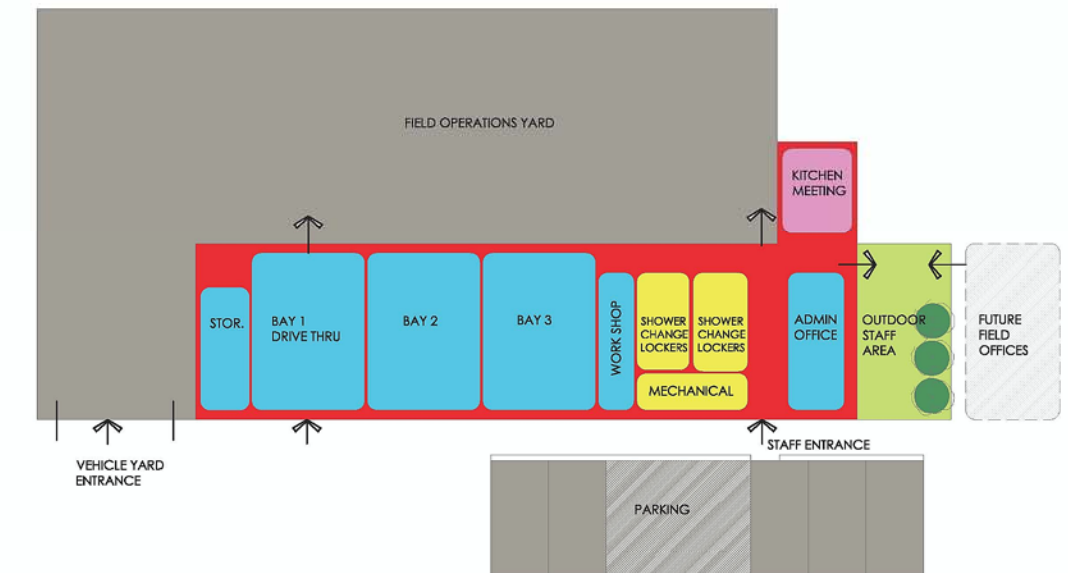

Option B : Connected Public/Admin and Maintenance Buildings

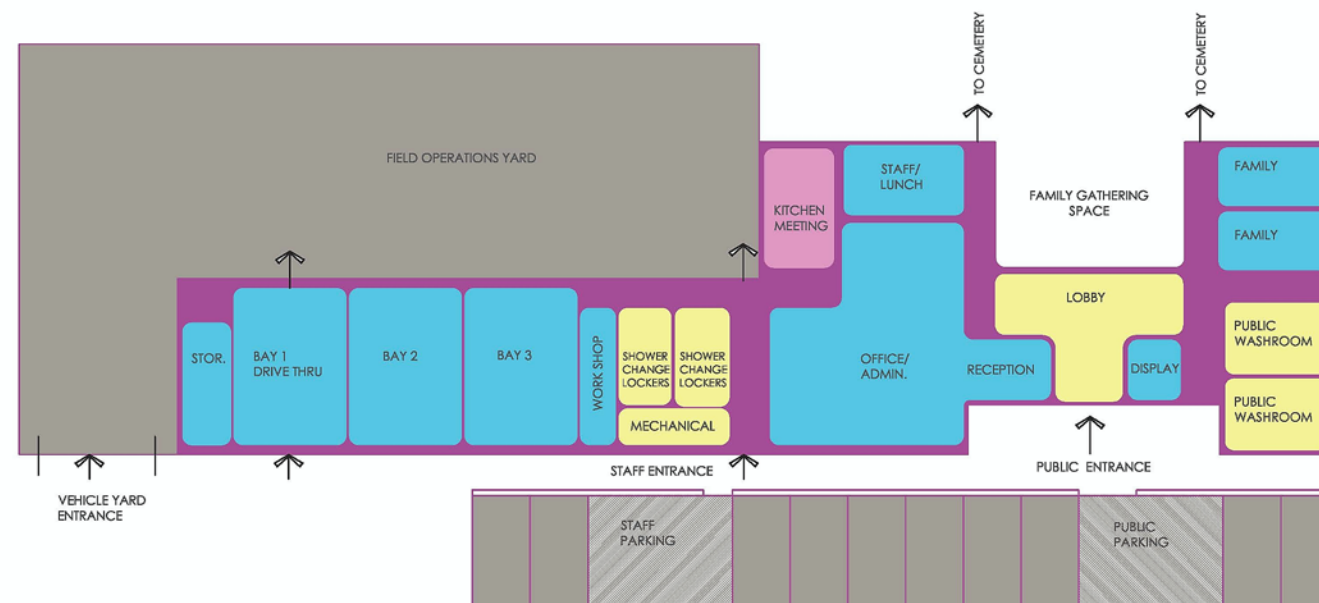

PROS:

- Possible decrease in cost as a result of slightly smaller floor area (due to shared space (i.e., lunchroom) and reduced site services).
- Staff communication may be somewhat easier.

CONS:

- Bereaved customers will be provided service in the same location where maintenance activities are taking place.
- There will be little opportunity to develop an integrated public "outdoor realm" space around the building as the maintenance yard is too close.
- Public perception of the building will likely be utilitarian.
- Noise from the yard to public/admin area will be disruptive.
- With the public/admin area located at one end of cemetery there is a long distance between the sales/service area and many parts of the cemetery (more than 600m).
- With the field yard close to public activity, there are potential safety issues
- Drive-through maintenance bays are more difficult to achieve in a combined building.

Option A : Separate Public/Admin and Maintenance Buildings_____

Walking Time From Public/Admin Building



Northern Lights



South Haven

Precedents_____



Public ceremonial space



Integrated building and landscape

Option B : Connected Public/Admin and Maintenance Buildings_____

Walking Time From Public/Admin Building

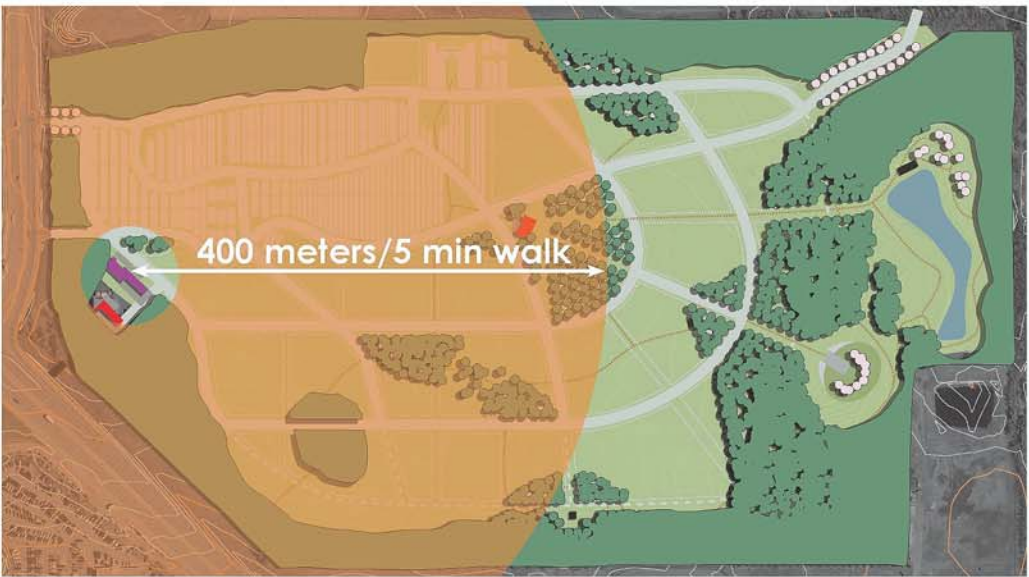

Northern Lights

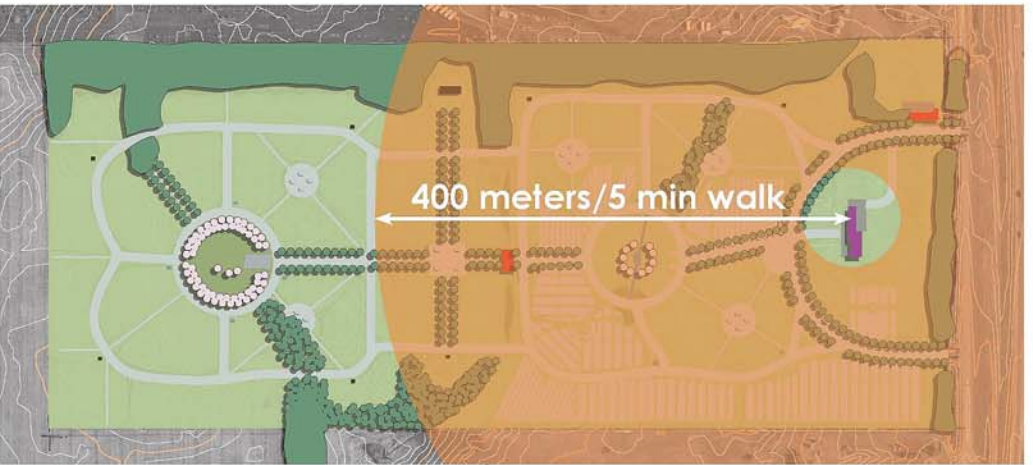

South Haven



Contemplative Pavilion