

THE WAY WE GROW

# New City Park

The Quarters Downtown

TRANSFORMING | **EDMONTON**

BRINGING OUR CITY VISION TO LIFE



# The Quarters Downtown Project To-Date

- The Downtown East, Creating a Vision (2006)
- ARP (2009)
- Urban Design Plan(2009)
- Armature Phase 4 Report (2010)
- Public Realm Improvement Strategy (2011)
- Community Revitalization Levy (2011)
- Public Consultation
- Timelines

## Open House • New City Park

- We're requesting feedback on the types of activities and events that could be accommodated in New City Park, a new urban park that is planned for the heart of The Quarters Downtown.

# The Armature

- 96<sup>th</sup> Street from Jasper Avenue to 103A Street
- New City Park is on the east side of 96<sup>th</sup> Street between 102A Avenue and 103A Avenue

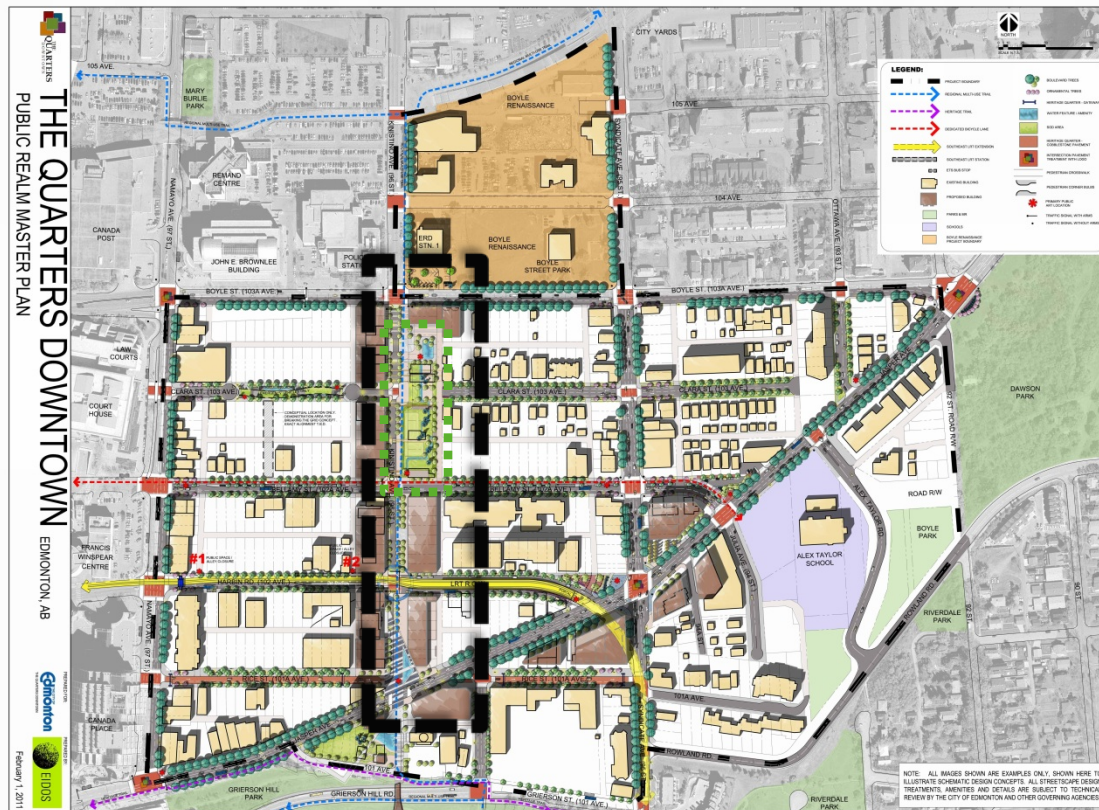



# Design Framework

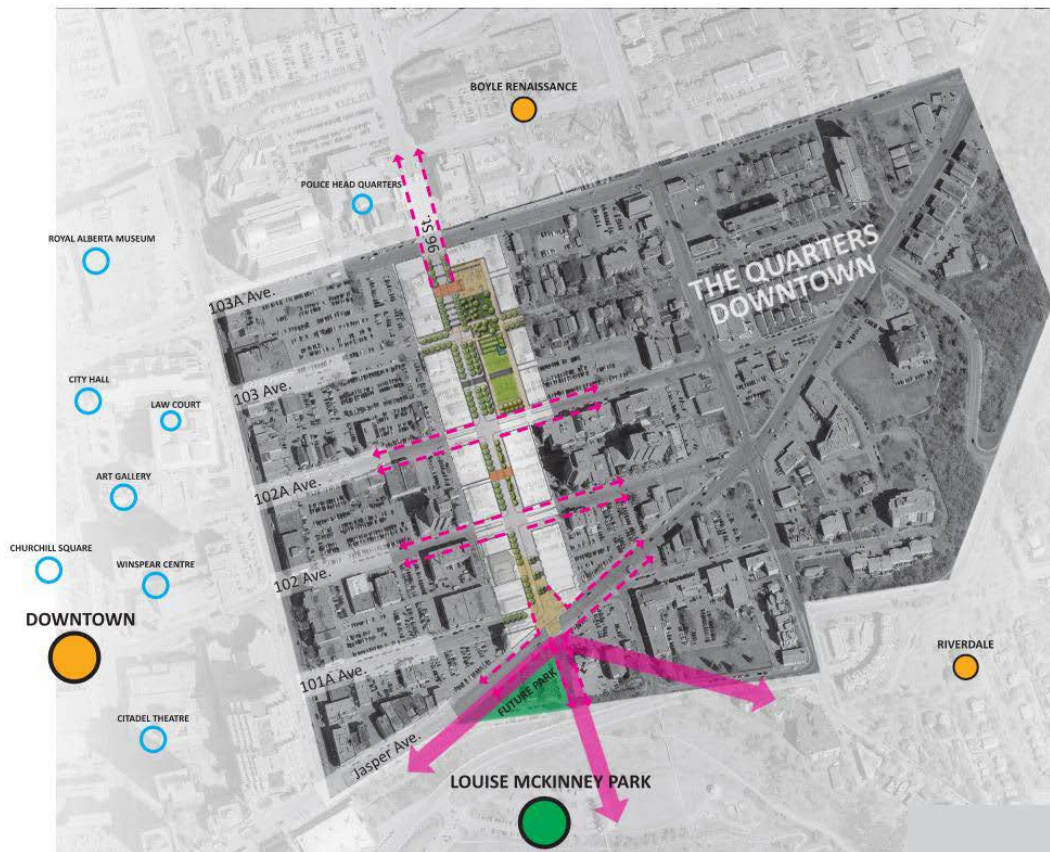

## KEY PRINCIPLES |

### SUSTAINABILITY

create a thriving, livable, walkable, 'green' street

### RE-GROWTH & RENEWAL

take a bold, aspirational approach that promotes the Quarters Downtown to developers, residents and visitors

### REVELATION

draw on the existing social fabric to demonstrate the spirit of the Quarters Downtown through fostering of the arts and the facilitation of cultural events

### CONNECTIVITY

connect to the river valley, to downtown and to the City at-large

### FLEXIBILITY

create a dynamic space that accommodates a wide variety of uses and programmes for all seasons, now, and in the future

### ANIMATION

actively program the open spaces within the Armature for a variety of events to encourage a vibrant street life

## The Armature



The Quarters Downtown Streetscape | Phase I  
CONCEPT PLAN  
Date: December 3, 2012  
Project Number: 14584



SITE PLAN  
| Areas A&B



# TRANSFORMING | EDMONTON

BRINGING OUR CITY VISION TO LIFE



# TRANSFORMING | EDMONTON

BRINGING OUR CITY VISION TO LIFE





# TRANSFORMING | EDMONTON

BRINGING OUR CITY VISION TO LIFE



# The Armature

## Project Status and Timeline

- Preliminary Design complete December 2012
- Construction Beginning in spring of 2013
- First two blocks, Jasper Avenue to 102A Avenue, complete in 2014
- 102 Avenue completed with Downtown to SE LRT Expansion

# New City Park

## Project Status and Timeline

- Concept Design complete
- Public Open House - Programming
- Preliminary Design / Detailed Design / Construction not yet scheduled



# New City Park - Site Plan

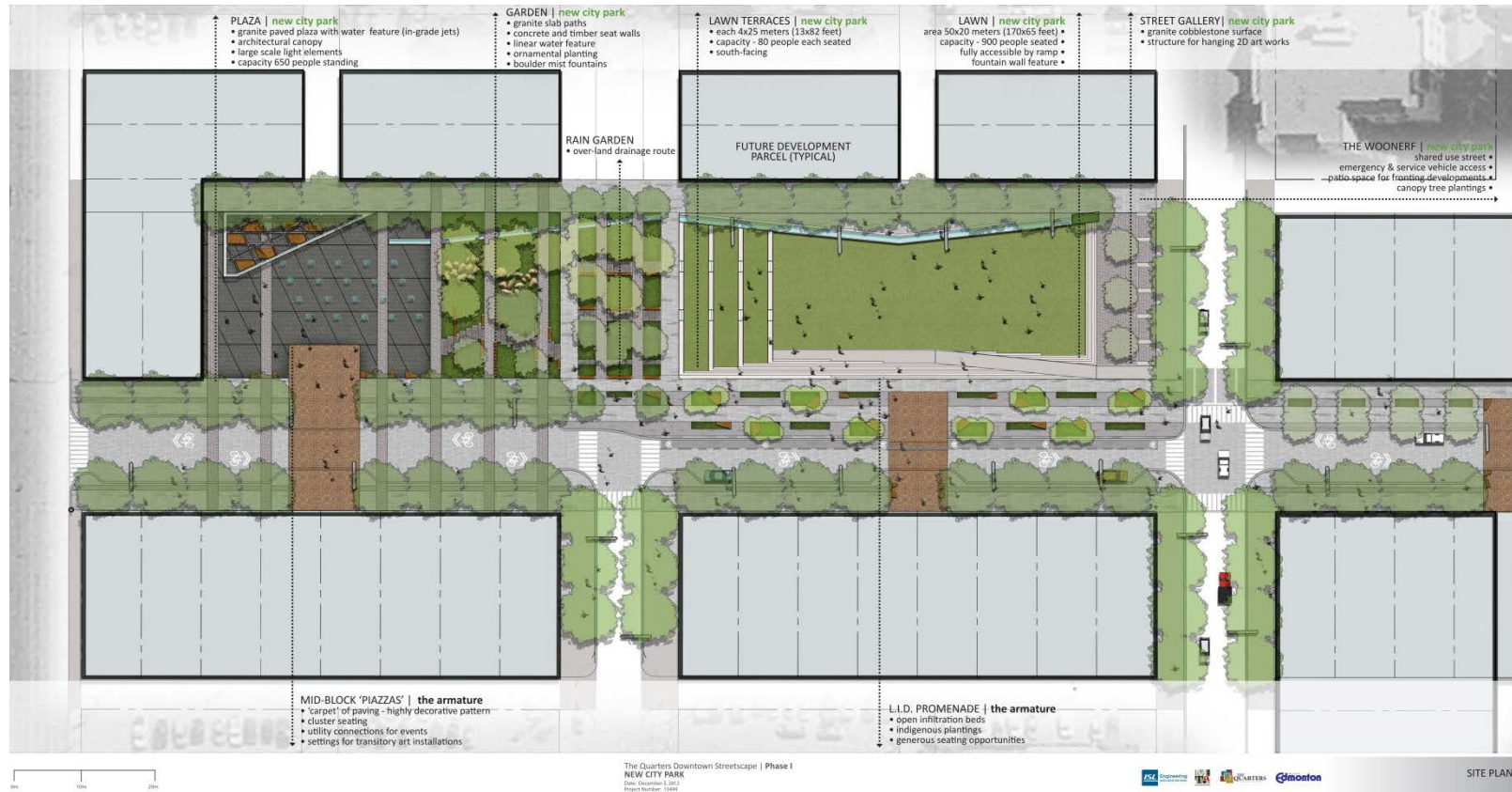

# TRANSFORMING | EDMONTON

BRINGING OUR CITY VISION TO LIFE





# TRANSFORMING | EDMONTON

BRINGING OUR CITY VISION TO LIFE





# TRANSFORMING | EDMONTON

BRINGING OUR CITY VISION TO LIFE



# Engagement with the Public and Stakeholders • 4 (multiple-part) Questions

1. How do you see yourself using New City Park?
2. What outdoor and/or recreational activities do you currently leave your neighbourhood to participate in?
  - i. Does this change depending on the season?

### 3. How could New City Park be used to support celebrations or festivals?

- i. Do you have any ideas or suggestions for new festivals or celebrations that would be a fit for the park?
- ii. Can you provide specific examples of what activities are involved and what type of amenities would be required.



- iii. Do you have any suggestions for how the use of technology could support these activities in New City Park (e.g., the use of smartphones, digital media, social media, audio/visual, etc.)?
- 4. What is the most memorable park you have spent time in and why is it memorable?
  - i. What type of activities did you participate in at this park?