



April 4, 2013

File No. LDA12-0299

Stantec Consulting Ltd.
10160 – 112 Street
Edmonton AB T5K 2L6

ATTENTION: Scott Cole

Dear Mr. Cole:

RE: Tentative plan of subdivision to create 244 single family residential lots, 42 semi-detached lots, two (2) multi-family residential lots, one (1) residential lot for an existing residence, three (3) Municipal Reserve lots, and 1 (one) future public park lot from a portion of Block 1 and 2 Plan 7722209 and a portion of NE 2-54-24-4, located west of 50 Street and north of 167 Avenue; **McCONACHIE**

I The Subdivision by Plan is APPROVED on April 4, 2013 subject to the following conditions:

1. that the owner dedicate Municipal Reserve 0.19 ha and 0.5 ha and 0.956 ha parcels pursuant to Section 666 of the Municipal Government Act as shown on the "Conditions of Approval" map, Enclosure I;
2. that the owner provide Municipal Reserve in the amount of 0.348 ha from SW 11-54-24-4 by caveat to NE 2-54-24-4, pursuant to Section 669 of the Municipal Government Act;
3. that the owner enter into a Servicing Agreement with the City of Edmonton pursuant to Section 669 of the Municipal Government Act;
4. that the owner prepare the necessary plans and documentation to grant or carry forward existing easements and restrictive covenants in favour of the City of Edmonton, EPCOR Distribution and Transmission Inc., EPCOR Water Services Inc., and ATCO Gas Ltd., as required by the aforementioned agencies or shown on the Engineering Drawings that are deemed to be part of the Servicing Agreement;
5. that LDA12-0299 to amend the McConachie Neighbourhood Structure Plan, the Zoning Bylaw and close an alley north of 175A Avenue and east of McConachie Boulevard receive third Reading prior to the endorsement of this subdivision;
6. that the owner be permitted to register this plan of subdivision in stages, as shown on the "Conditions of Approval" map, Enclosure I, at the discretion of the Chief Subdivision Officer, having regards to the provision of roadways and the logical extension services;
7. that the proposed alley right-of-way be widened to accommodate a 1.5 m sidewalk, as shown on the "Conditions of Approval" map, Enclosure I;
8. that the owner dedicate road right-of-way to the satisfaction of the Transportation Services, as shown on the "Conditions of Approval" map, Enclosure I;

9. that an easement be registered on the Medium Density Residential parcel to provide permanent emergency access for the RSL Lots to the satisfaction of Transportation Services and Fire Rescue Services, as shown on the "Conditions of Approval" map, Enclosure I;
10. that a temporary access and servicing easement be registered to provide access and servicing to the existing residential lot located with the District Park site, until such time that the permanent collector road is extended, as shown on the "Conditions of Approval" map, Enclosure I; and
11. that the owner pay all outstanding property taxes prior to the endorsement of the plan of subdivision.

II That the Servicing Agreement required in Clause I (3) contain, among other things the following:

1. that the owner pay all servicing costs, assessments, roadway modification costs (including but not limited to sidewalk, shared use path and/or transit infrastructure), construction costs and inspection costs occasioned by this subdivision;
2. that the owner pay all costs specified in the Servicing Agreement prior to the endorsement of the plan of subdivision;
3. that the owner pay his proportional share of the Permanent Area Contributions and/or Lateral Sewer Oversizing applying to the area of the subdivision for the construction of permanent storm and sanitary servicing facilities;
4. that the owner pays the proportionate share of the Arterial Roadway Assessment for the construction of arterial roadways in the catchment area;
5. that the owner submit an Erosion and Sediment Control (ESC) Plan specific for this development and for implementation during and after construction in accordance with the City of Edmonton ESC Guidelines and Field Manual;
6. that the owner submit detailed Engineering Drawings and technical studies in accordance with the City of Edmonton Design and Construction Standards and to the satisfaction of the City Departments and affected utility agencies;
7. that the owner design and construct the entire or a suitable interim stage of the ultimate North Cy Becker Stormwater Management Facility, including grading to accommodate a 3 m shared use path;
8. that the Engineering Drawings include the connection to the 450mm water main as shown on the "Conditions of Approval" map, Enclosure I;
9. that the Engineering Drawings include an offset 17 m radius asphalt surface temporary transit turnaround with bollards or mini-barriers, as shown on the "Conditions of Approval" map, Enclosure I. The turnaround will be required prior to CCC or at the discretion and direction of Transportation Services;
10. that the Servicing Agreement Schedule "E" include a land exchange agreement for the road closure area located north of 175A Avenue and east of McConachie Boulevard;
11. that the owner construct a temporary 4 m wide gravel emergency access with T-bollards, as shown on the "Conditions of Approval" map, Enclosure I. The temporary emergency access will be required prior to CCC or at the discretion and direction of Transportation Services;

12. that the owner construct a 6 m gravel temporary roadway connection with stage 5A, as shown on the "Conditions of Approval" map, Enclosure I, to the satisfaction of Transportation Services;
13. that the owner construct a 3 m hard-surface shared use path, within the greenway, with a dividing yellow centerline and Shared Use signage, lighting, bollards and landscaping to the satisfaction of Transportation Services, as shown on the "Conditions of Approval" map, Enclosure I;
14. that the Engineering Drawings include a 3 m asphalt shared use path within the Natural Area, as per City of Edmonton Design and Construction Standards, including bollards and landscaping to the satisfaction of Transportation Services, as shown on the "Conditions of Approval" map, Enclosure I;
15. that the owner construct a 1.5 m concrete sidewalk along the widened alley right-of-way in the northwest portion of the plan, to connect the local road with the walkway to the north of the widened alley, as shown on the "Conditions of Approval" map, Enclosure I. Details of the sidewalk along the alley will be reviewed at the time of engineering drawing review;
16. that the owner construct a 1.5 m concrete sidewalk with bollards and lighting as shown on the "Conditions of Approval" map, Enclosure I;
17. that the owner construct a 1.2 m lockable chain link gate to the satisfaction of Sustainable Development in the location as shown on the "Conditions of Approval" map, Enclosure I;
18. that the owner construct 900 mm post and rail fence within Municipal Reserve lot as shown on the "Conditions of Approval" map, Enclosure I;
19. that the owner construct bollards to the satisfaction of Transportation Services in the location as shown on the "Conditions of Approval" map, Enclosure I;
20. that the owner enter into a Cost Share Park Development Agreement with the City of Edmonton for the development of the McConachie District Park site;
21. that the owner is responsible for all costs for the development of the 0.5 ha municipal reserve parcel;
22. that the owner construct all fences positioned wholly on privately-owned lands, with the exception of the post and rail fence within Municipal Reserve lots, to the satisfaction of Sustainable Development in the location as shown on the "Conditions of Approval" map, Enclosure I; and
23. that the owner is responsible for the design, landscaping and construction within the public utility lots, utility rights-of-way, road islands, boulevards, medians, walkways, and Municipal Reserve parcels, to the satisfaction of the Transportation Services and Financial and Infrastructure Services.

Enclosure I is a map of the subdivision identifying major conditions of this approval.

The full 10% municipal reserve requirement has been provided for Block 1 Plan 7722209 and NE 2-54-24-4 under subdivision files LDA08-0071 and LDA10-0308 respectively.

The full 10% Municipal Reserve requirement for Block 2 Plan 772 2209 and SW 11-54-24-4 will be provided with this subdivision. The 1.646 ha DRC # 102 131 043 from Block 2 Plan 772 2209 will be discharged and provided as a 0.50 ha Pocket Park, and 0.19 ha and 0.956 ha provided for the McConachie District Park. Municipal Reserve in the amount of 0.336 ha is to be pre-

dedicated from SW 11-54-24-4 and is to be provided as land for the McConachie District Park. The remaining 0.336 ha required to assemble the McConachie District Park will be purchased by the City of Edmonton.

Please be advised that an appeal may be lodged in accordance to Section 678 of the Municipal Government Act with the Subdivision and Development Appeal Board, Office of the City Clerk, 3rd Floor, City Hall, 1 Sir Winston Churchill Square, Edmonton, Alberta, T5J 2R7 within 14 days from the date of the receipt of this decision. The Date of receipt of the decision is deemed to be 5 days from the date the decision is mailed.

If you have further questions, please call Ms. Carman Yeung at 780-496-6213 or write to:

**Ms. Carman Yeung, Planner
Current Planning Branch
Planning and Development Department
5th Floor, 10250 - 101 Street
Edmonton AB T5J 3P4**

Yours truly,



FOR

Scott Mackie
Subdivision Authority

SM/cy/Posse #128478064-001

Enclosure(s)

SUBDIVISION CONDITIONS OF APPROVAL MAP

April 4, 2013

LDA 12-0299

- Limit of proposed subdivision
- [Pattern] Widen alley right-of-way and construct 1.5m sidewalk
- Construct 1.5m sidewalk with bollards and lighting and register as legal road right-of-way
- Staging boundary
- Bollards
- [Pattern] Area where Arterial roadway Assessment (ARA) has been paid
- [Pattern] Register easement for existing building
- ⬇ Construct 450mm water connection
- o-o-o-o-o-o-o-o Post and rail fence
- 1.2m Uniform fence
- - - 1.8m Uniform fence
- [Pattern] 1.2m Lockable chain link gate
- [Pattern] Construct 17m radius offset asphalt temporary turnaround with bollards/ mini-barriersz
- [Pattern] Register as road right-of-way and construct 3m hard surfaced shared use path with dividing yellow centerline, signage, lighting, bollards and landscaping
- [Pattern] Register emergency access easement and construct temporary 4m wide gravel emergency access
- ↔ Construct 3m asphalt shared use path including bollards and lighting within natural area
- - - Temporary Access and servicing easement to be registered on title with bollards on both sides of easement
- [Pattern] Include in Engineering drawings
- ↔ 6m gravel temporary roadway connection

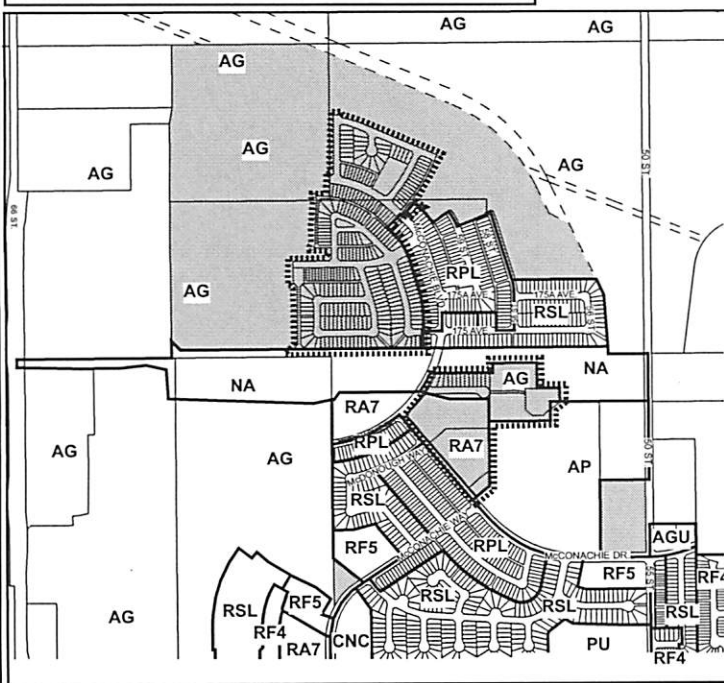
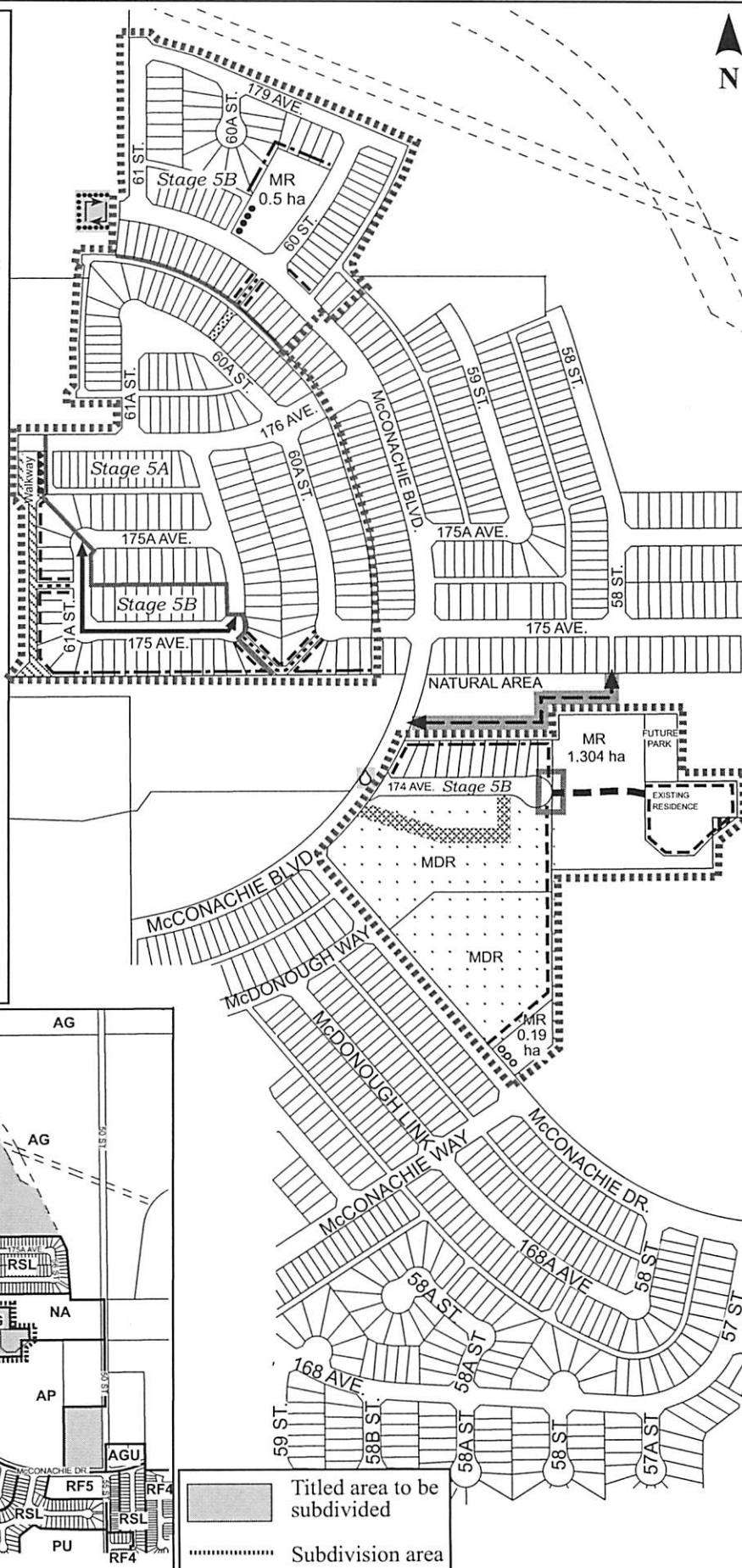

- [Pattern] Titled area to be subdivided
- Subdivision area