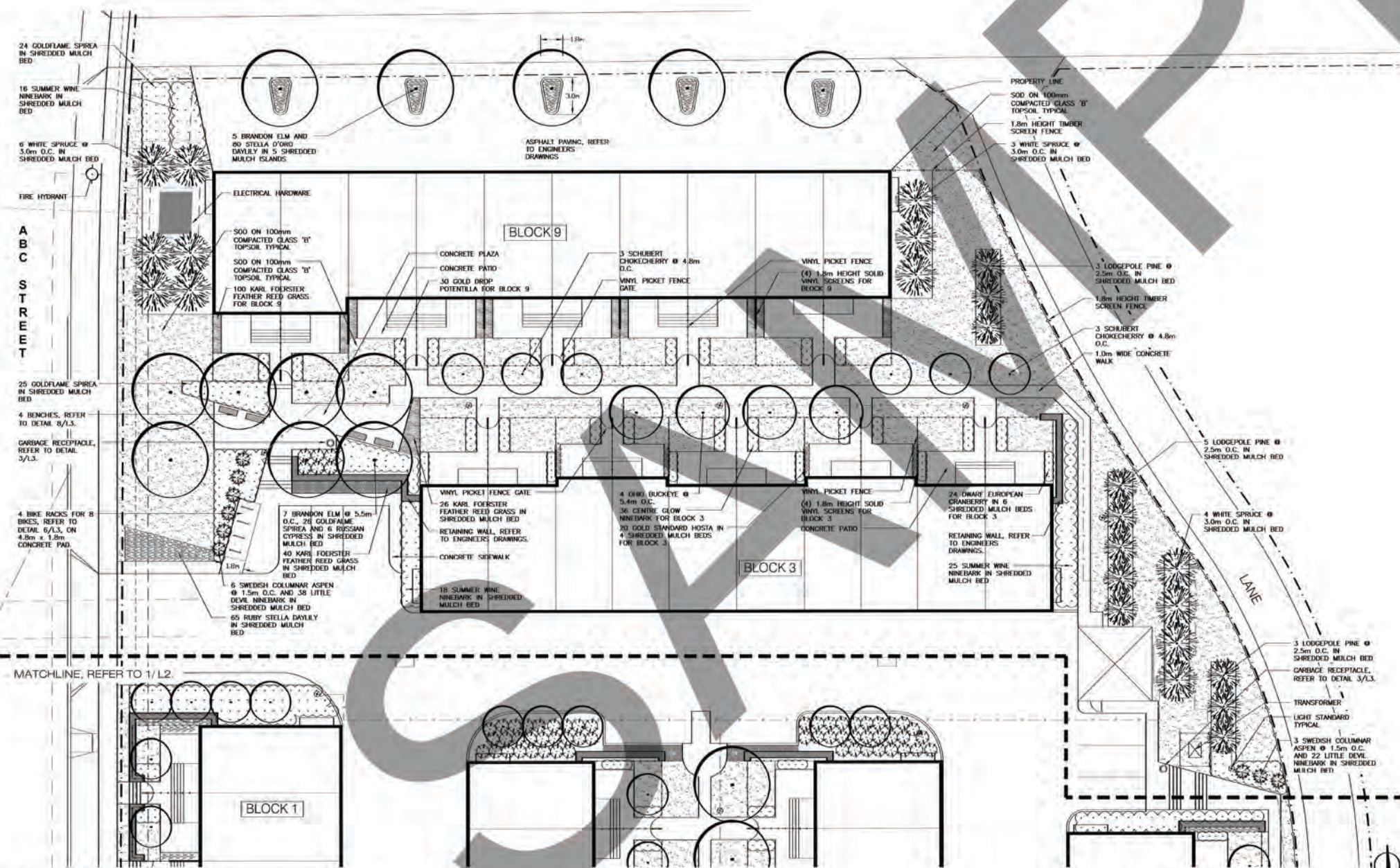

1
L1

KEY PLAN

123 Avenue

SCALE 1:1000

2
L1

LANDSCAPE PLAN

PLANTING SCHEDULE

TOTAL	BOTANICAL NAME	COMMON NAME	COMMENTS
DECIDUOUS TREES			
4	Aesculus glabra	Ohio Buckeye	65 mm col. min., 3.5 m ht. min., b. & b.
4	Crataegus x mordenensis 'Snowbird'	Snowbird Hawthorn	65 mm col. min., 3.5 m ht. min., b. & b.
4	Crataegus x mordenensis 'Tobey'	Tobey Hawthorn	65 mm col. min., 3.5 m ht. min., b. & b.
13	Malus baccata 'Rosterm'	Rosterm Columnar Crabapple	65 mm col. min., 3.5 m ht. min., b. & b.
4	Malus x odiergensis 'Duke'	Duke's Gold Crabapple	65 mm col. min., 3.5 m ht. min., b. & b.
10	Malus x 'Spring Snow'	Spring Snow Crabapple	65 mm col. min., 3.5 m ht. min., b. & b.
4	Malus x 'Thunderchild'	Thunderchild Crabapple	65 mm col. min., 3.5 m ht. min., b. & b.
19	Populus tremula 'Tremula'	Swedish Columnar Aspen	65 mm col. min., 4.0 m ht. min., b. & b.
25	Prunus virginiana 'Schubert'	Schubert Chokeberry	75 mm col. min., 4.0 m ht. min., b. & b.
20	Ulmus americana 'Brandon'	Brandon Elm	75 mm col. min., 4.0 m ht. min., b. & b.
CONIFEROUS TREES			
25	Picea glauca	White Spruce	3.5 m ht. min., b. & b.
11	Pinus contorta latifolia	Lodgepole Pine	2.5 m ht. min., b. & b.
DECIDUOUS SHRUBS			
16	Cornus alba 'Bailhata'	Ivory Halo Dogwood	60 cm ht. min., 5 major basal branches, potted (2 gal.)
36	Physocarpus opulifolius 'Center Glow'	Center Glow Ninebark	60 cm ht. min., 5 major basal branches, potted (2 gal.)
67	Physocarpus opulifolius 'Dart's Gold'	Dart's Gold Ninebark	60 cm ht. min., 5 major basal branches, potted (2 gal.)
126	Physocarpus opulifolius 'Little Devil'	Little Devil Ninebark	60 cm ht. min., 5 major basal branches, potted (2 gal.)
59	Physocarpus opulifolius 'Seward'	Summer Wine Ninebark	60 cm ht. min., 5 major basal branches, potted (2 gal.)
30	Potentilla fruticosa 'Gold Drop'	Gold Drop Potentilla	60 cm ht. min., 5 major basal branches, potted (2 gal.)
37	Ribes alpinum	Alpine Currant	60 cm ht. min., 5 major basal branches, potted (2 gal.)
36	Spiraea bumalda 'Anthony Waterer'	Anthony Waterer Spirea	60 cm ht. min., 5 major basal branches, potted (2 gal.)
16	Spiraea bumalda 'Trobel'	Froebel Spirea	60 cm ht. min., 5 major basal branches, potted (2 gal.)
201	Spiraea bumalda 'Goldflame'	Goldflame Spirea	60 cm ht. min., 5 major basal branches, potted (2 gal.)
95	Spiraea bumalda 'Goldmound'	Major Carpet Spirea	60 cm ht. min., 5 major basal branches, potted (2 gal.)
104	Viburnum opulus 'Nanum'	Dwarf European Cranberry	60 cm ht. min., 5 major basal branches, potted (2 gal.)
CONIFEROUS SHRUBS			
15	Juniperus communis 'Alpine Carpet'	Alpine Carpet Juniper	80 cm spread min., potted (5 gal.)
110	Juniperus sedata 'Calgary Carpet'	Calgary Carpet Juniper	80 cm spread min., potted (5 gal.)
45	Microbiota decussata	Russian Cypress	90 cm ht. min., potted (5 gal.)
PERENNIALS			
311	Cotoneaster acutiflorus 'Karl Foerster'	Karl Foerster Feather Reed Grass	1 gal pot
78	Hemerocallis 'Hyperion'	Hyperion Daylily	1 gal pot
45	Hemerocallis 'Ruby Stella'	Ruby Stella Daylily	1 gal pot
142	Hemerocallis 'Stella D'Oro'	Stella D'Oro Daylily	1 gal pot
20	Hosta 'Gold Standard'	Gold Standard Hosta	1 gal pot
155	Ligularia stenosephala 'The Rocket'	Narrow Spined Rayflower	1 gal pot

PLANTING NOTES

CONTRACTOR TO NOTIFY CONSULTANT FOR SELECTION OF ALL TREES AT LOCAL NURSERY. ALL TREES TO APPROVAL OF CONSULTANT.

PRIOR TO INSTALLATION OF TREES AND SHRUBS, THE CONTRACTOR SHALL ENSURE COORDINATION WITH ALBERTA FIRST CALL TO STAKE ALL UTILITIES. ALL PLANT MATERIAL TO HAVE REQUIRED SETBACK FROM UTILITIES. NO TREE STAKES WITHIN 1.0m OF POWER LINE.

PRIOR TO INSTALLATION OF TREES AND SHRUBS, THE CONSULTANT WILL APPROVE STAKING OF ALL TREES AND SHRUB BEDS. CONTRACTOR TO NOTIFY CONSULTANT 48h PRIOR TO INSPECTION.

IF EXCAVATIONS ARE REQUIRED CLOSER THAN 1.0m TO UNDERGROUND POWER, PHONE, CABLE AND GAS ALIGNMENTS, HAND DIGGING UNDER THE SUPERVISION OF THE ATTESTED UTILITY IS REQUIRED. THE CONTRACTOR SHALL NOTIFY THE CONSULTANT AND THE APPROPRIATE UTILITY TO APPROVE, REVIEW AND DEFINE SAFE PROCEDURES FOR THESE EXCAVATIONS.

SUBSTITUTION OF PLANT MATERIAL TO APPROVAL OF CONSULTANT.

LANDSCAPED AREAS ARE NOT IRRIGATED.

ENSURE ALL TREES HAVE STRONG, SINGLE LEADER, AND ARE STRAIGHT BODIED, NICELY GROWN TREES WITH A TYPICAL SHAPE.

TREES PLANTED IN STRAIGHT ROWS WITH EVEN SPACING WERE APPLICABLE.

ALL SHRUB BEDS c/w 400mm MIN. DEPTH LIGHTLY COMPACTED CLASS 'B' TOPSOIL.

SHRUB SETBACK SHALL BE 500mm MIN. FROM EDGE OF SHRUB BED.

PLANTING BED EDGING: USE 38 x 140mm PRESSURE TREATED TIMBER EDGING BETWEEN ROCK MULCH AREAS AND SOIL, AND BETWEEN ROCK MULCH AREAS AND SHREDED WOOD MULCH AREAS. NO EDGING IS REQUIRED BETWEEN SHREDED WOOD MULCH AREAS AND SOIL. CONTRACTOR TO PROVIDE A NICE AND STRAIGHT SHOVEL CUT EDGING.

ROCK MULCH: USE 100mm DEPTH MIN. WASHED ALBERTA RAINBOW ROCK MULCH, 40mm (1.5") AGGREGATE SIZE, ON LANDSCAPE FABRIC WHERE INDICATED ON SHEETS L1-L2.

SHREDED WOOD MULCH: USE 100mm DEPTH MIN. SHREDED CONIFEROUS WOOD MULCH FOR ALL OTHER SHRUB BEDS AND AROUND TREES. NO LANDSCAPE FABRIC IS REQUIRED FOR SHREDED WOOD MULCH AREAS.

ALL LANDSCAPE CONSTRUCTION AND MAINTENANCE TO BE COMPLETED BUT NOT LIMITED TO MINIMUM STANDARDS OF MOST RECENT EDITION OF CITY OF EDMONTON DESIGN AND CONSTRUCTION STANDARDS.

LEGEND

- 1.8m HEIGHT SOLID VINYL SCREEN
- VINYL PICKET FENCE
- TIMBER NOISE ATTENUATION FENCE BY DEVELOPER
- 1.8m HEIGHT TIMBER SCREEN FENCE
- RETAINING WALL
- BIKE RACK
- BENCH
- GARBAGE RECEPTACLE
- LIGHT FIXTURE

LEGAL DESCRIPTION

Lot 0
Block 0
Plan 123 4567
EDMONTON, ALBERTA

MUNICIPAL ADDRESS

12345 ABC Avenue
EDMONTON, ALBERTA

GENERAL NOTES

- FOR TREE PLANTING DETAIL REFER SHEET L3.
- FOR SHRUB PLANTING DETAIL REFER SHEET L3.
- FOR RETAINING WALL DETAILS REFER SHEET L3.
- FOR RETAINING WALL LAYOUT REFER TO ENGINEERS DRAWINGS.
- FOR FENCE DETAILS REFER TO SHEET L4.
- FOR GRADING INFORMATION REFER TO ENGINEERS DRAWINGS.
- FOR EXACT UTILITY LAYOUT REFER TO ENGINEERS DRAWINGS.
- FOR GAS/POWER ALIGNMENT REFER TO ENGINEERS DRAWINGS.

LANDSCAPE REQUIREMENTS

LANDSCAPED YARD CALCULATION
ZONING: RA7

WEST (FRONT) YARD: 6.0m x 129.82m = 778.92 sqm
EAST (REAR) YARD: 7.5m x 140.06m = 1050.45 sqm
NORTH (SIDE) YARD: 2.0m x 67.50m = 135.00 sqm
SOUTH (SIDE) YARD: 4.5m x 98.59m = 443.65 sqm

TOTAL REQUIRED YARD: 2408.2 sqm

ONE TREE FOR EACH 35.00 sqm OF REQUIRED YARD.
ONE SHRUB FOR EACH 15.00 sqm OF REQUIRED YARD.

PLANTING CALCULATION

TOTAL REQUIRED YARD:	2408.2 sqm
No. OF REQUIRED TREES:	69
No. OF REQUIRED SHRUBS:	161
TOTAL No. OF PROVIDED TREES:	145
TOTAL No. OF PROVIDED SHRUBS:	993
TOTAL No. OF PROVIDED PERENNIALS:	771

Affix Landscape Architect Logo and Contact Info Here

Affix Landscape Architect Stamp Here

Affix Applicant Logo Here

Project Name and Community
MULTI-FAMILY SITE
LANDSCAPE PLAN

SCALE AS SHOWN
18 MAY 2014

L1